

Admiral DE25D6B 05 - EXTERIOR

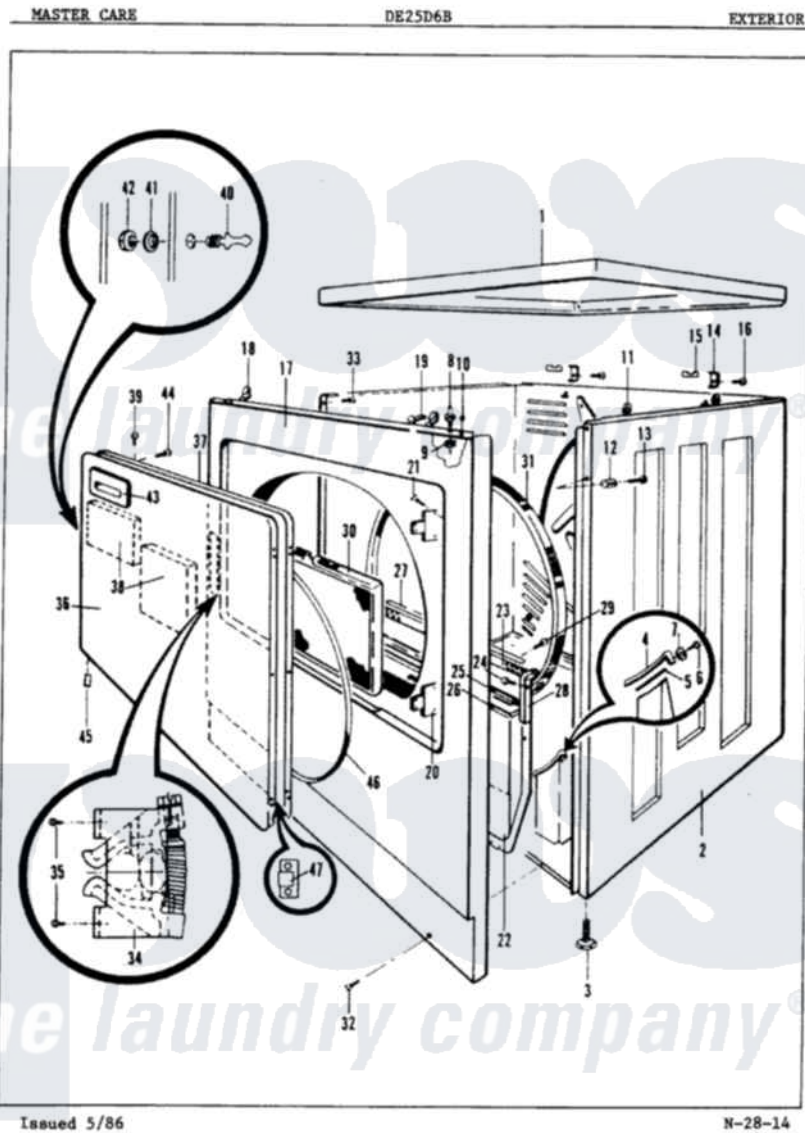

Admiral [Residential Admiral DE25D6B Dryer Parts](#) Parts Diagram 05 - EXTERIOR
 Click on the part number to view part

Item	Original Part Number	Replaced By	Status	Part Description
1	63-6666-24		Not Available	CABINET TOP
"	63-6666		Not Available	CABINET TOP
"	63-6666-25		Not Available	CABINET TOP
2	63-5998-25		Not Available	CABINET ASM
"	25-7740		Not Available	SCREW
"	63-5998-24		Not Available	CABINET ASM
"	63-5998		Not Available	CABINET ASM
3	63-2834N			Dryer Glide Kit
"	63-5834		Not Available	LEG, LEVELING
4	63-3805		Not Available	LH CYL GLIDE
"	63-3804			RH Cylinder Glide
5	63-6301			LH Cylinder GI Cushn
"	63-6300			RH Cylinder GI Cushn
6	63-1202			Clamp
7	25-3092	90767		Screw, 8A X 3/8 HeX Washer Head Tapping
8	63-6148	53-0643		Pin, Locator

9	25-0224	3400029	Nut, Adapter Plate
10	33-2653		Bumper, Cabinet
11	25-3034		Clip, Wiring
12	63-5546	Not Available	SLEEVE
13	25-7123	Not Available	SCREW
14	63-5712		Hinge, Cabinet Top
15	33-0930		Pad, Top Hinge
16	25-3092	90767	Screw, 8A X 3/8 HeX Washer Head Tapping
17	63-5982	Not Available	FRONT PANEL
"	63-5982-25	Not Available	FRONT PANEL
"	63-5982-24	Not Available	FRONT PANEL
18	25-7220		Clip, Cabinet Top
19	25-3032	Not Available	WIRING CLIP
20	63-4526	Not Available	HINGE
21	25-7770	3196169	Screw, Element
22	63-5451	63-6484	Duct
23	63-5448	Not Available	COLL DUCT FRONT
24	25-2134	W10116760	Screw
25	63-1192	Not Available	TRAP SEAL
26	63-5449		Lint Trp Seal
27	63-5478		Foam Seal
28	63-5477		Seal
29	25-7742	210932	Screw, No.8 X 9/16 Ctsk Note: Screw, Inlet Duct
30	63-5431		Lint Screen
31	63-1270	Not Available	FRONT CYL SEAL
32	25-7453	Not Available	SCREW
33	25-7741	W10116760	Screw
"	63-2842N		Door Catch Kit
34	63-5569		Catch Assembly
35	25-7715	W10068250	Screw
36	63-6067	Not Available	OUTER PANEL
"	63-6067-24		Outer Panel
"	63-6067-25	Not Available	OUTER PANEL
37	63-6068	Not Available	INNER PANEL
38	63-6090	Not Available	POLY PAD
39	25-7752	3196169	Screw, Element
40	63-6069		Door Strike
41	W10124350	Not Available	NOT REQUIRED PART OR SEE NOTE WASHER (PURCHASED LOCALLY)
42	25-0048	Y052734	Nut, Carrage Bolts And Bracket
43	63-5560		Door Handle
44	25-7650	Not Available	SCREW
45	25-3534	25-7889	Plug Button
46	63-3693		Door Gasket
47	63-5099	Not Available	HINGE CLIP