

# Admiral LATA100AAW 04 - TOP

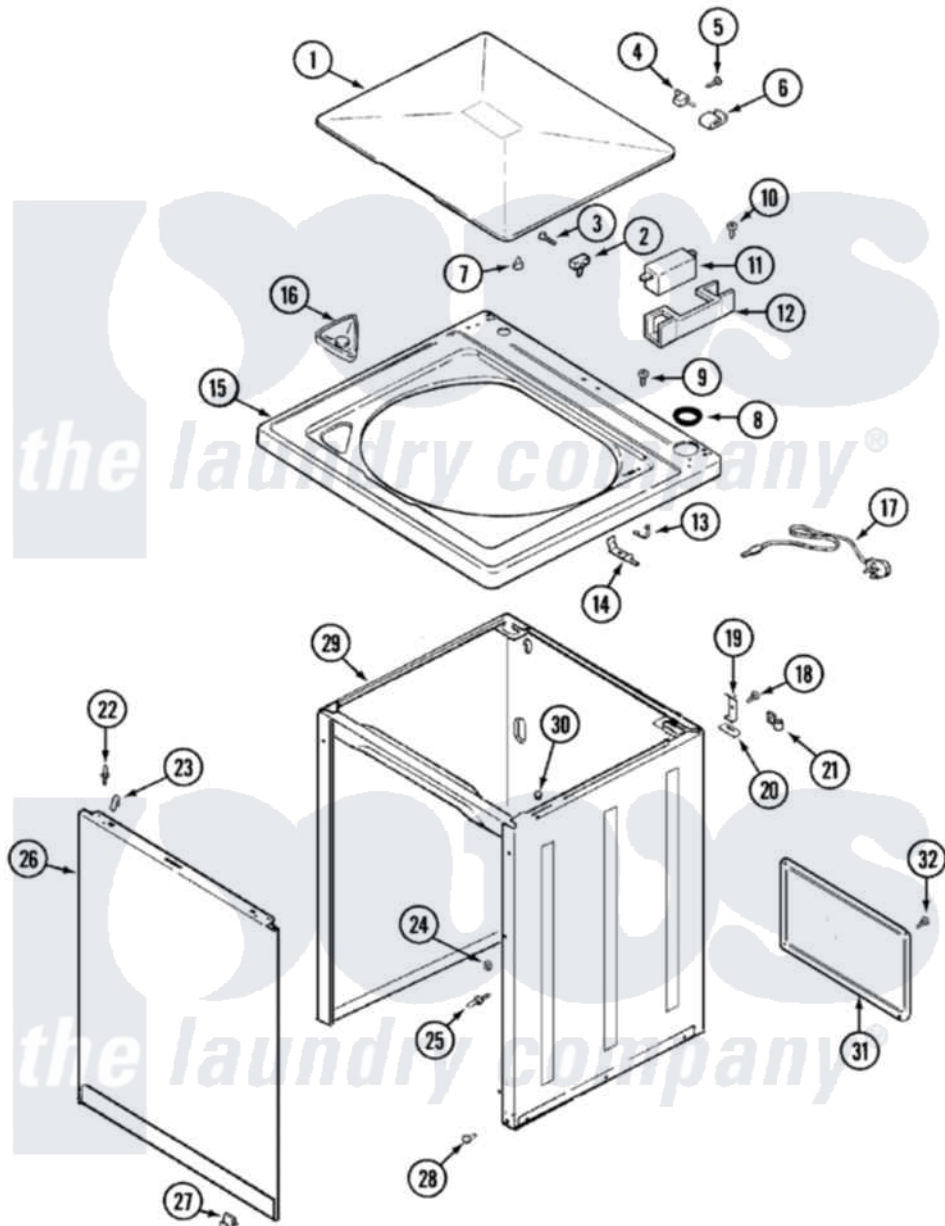

Admiral [Residential Admiral LATA100AAW Washer Parts](#) Parts Diagram 04 - TOP  
 Click on the part number to view part

| Item | Original Part Number    | Replaced By                 | Status        | Part Description         |
|------|-------------------------|-----------------------------|---------------|--------------------------|
| 1    | <a href="#">35-2026</a> |                             |               | Lid                      |
| 2    | <a href="#">25-7436</a> |                             |               | Nylite Washer            |
| "    | <a href="#">43-0057</a> |                             |               | Actuator, Door Switch    |
| 3    | <a href="#">25-7438</a> |                             |               | Screw                    |
| 4    | <a href="#">35-2045</a> |                             |               | Pin, Hinge               |
| 5    | <a href="#">25-7893</a> |                             |               | Screw                    |
| 6    | <a href="#">35-2044</a> |                             |               | Hinge, Lid               |
| 7    | <a href="#">35-0581</a> |                             |               | Bumper, Door             |
| 8    | <a href="#">35-2064</a> |                             |               | Bushing, Insulating      |
| "    | <a href="#">35-2063</a> |                             |               | Bushing, Insulator       |
| 9    | 25-7463                 | <a href="#">7101P012-60</a> |               | Screw                    |
| 10   | 25-7437                 | <a href="#">40040701</a>    |               | Screw, Tapping No.6b-20  |
| 11   | 35-3382                 | <a href="#">12001187</a>    |               | Kit, Lid Switch Assembly |
| "    | 35-2904                 |                             | Not Available | PAD, LID SWITCH          |
| 12   | 35-2795                 | <a href="#">12001187</a>    |               | Kit, Lid Switch Assembly |
| 13   | <a href="#">25-7878</a> |                             |               | Clip                     |

|    |                         |                          |                          |
|----|-------------------------|--------------------------|--------------------------|
| 14 | 35-3076                 | <a href="#">12001187</a> | Kit, Lid Switch Assembly |
| 15 | <a href="#">35-2739</a> |                          | Top, Cabinet             |
| 16 | 35-2731                 | <a href="#">21001167</a> | Dispenser, Bleach        |
| 17 | 35-0680                 |                          | Not Available            |
| 18 | <a href="#">25-7893</a> |                          | CORD, POWER              |
| 19 | 33-7450                 | <a href="#">35-2846</a>  | Screw                    |
| 20 | <a href="#">33-0930</a> |                          | Hinge, Cabinet Top       |
| 21 | 25-7796                 | <a href="#">596669</a>   | Pad, Top Hinge           |
| 22 | <a href="#">53-0643</a> |                          | Clamp, Manifold          |
| 23 | <a href="#">25-7220</a> |                          | Pin, Locator             |
| 24 | 25-0224                 | <a href="#">3400029</a>  | Clip, Cabinet Top        |
| 25 | <a href="#">53-0643</a> |                          | Nut, Adapter Plate       |
| 26 | <a href="#">35-2084</a> |                          | Pin, Locator             |
| 27 | <a href="#">53-0120</a> |                          | Panel, Front             |
| 28 | <a href="#">33-2653</a> |                          | Clip, Front Panel        |
| 29 | 35-2106                 | <a href="#">21001871</a> | Bumper, Cabinet          |
| 30 | <a href="#">33-2653</a> |                          | Cabinet                  |
| 31 | 35-2108                 | <a href="#">21001871</a> | Bumper, Cabinet          |
| 32 | 25-7733                 | <a href="#">681414</a>   | Cabinet                  |
|    |                         |                          | Screw, 10AB X 1/2        |

