

Amana DA1040 16 - POWER CORD, WIRE AND TERMINALS

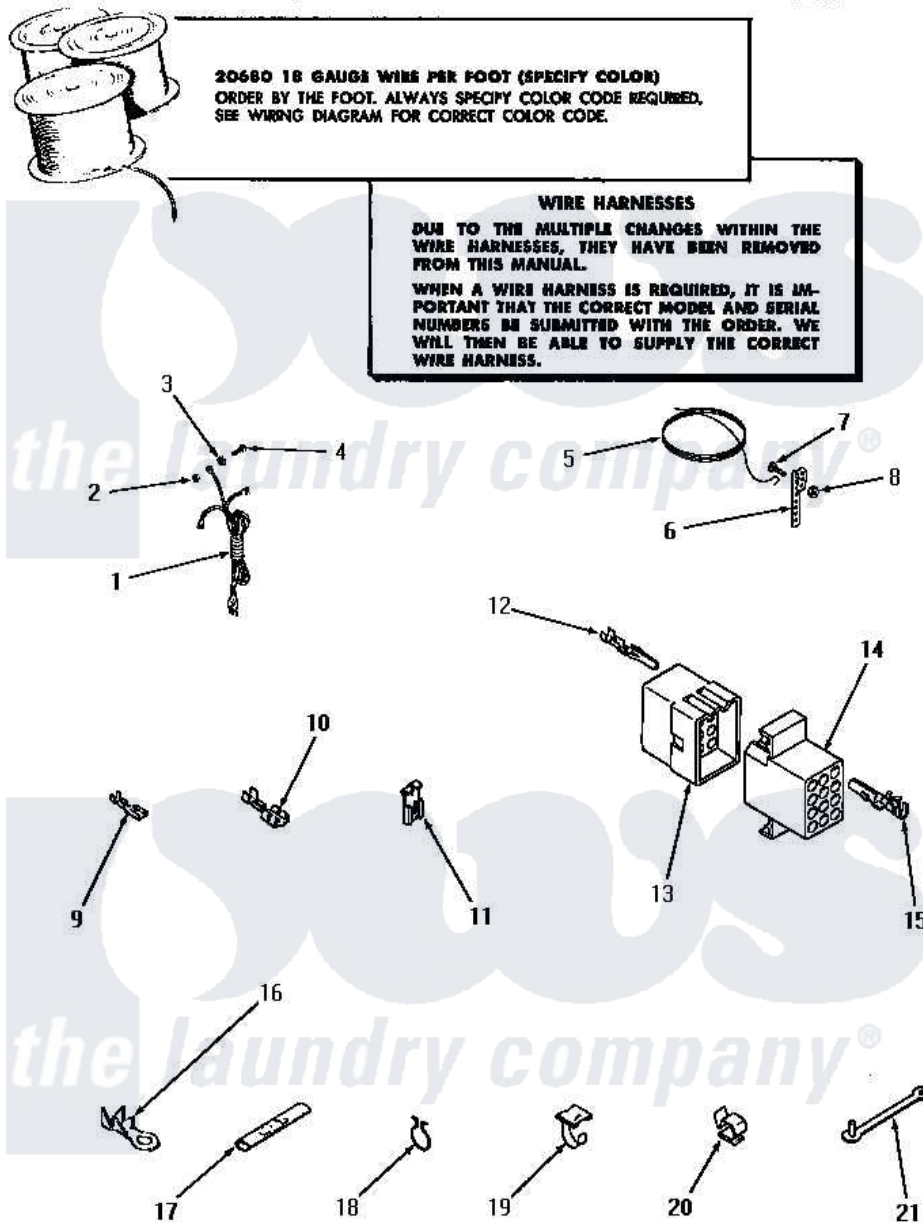

20680 18 GAUGE WIRE PER FOOT (SPECIFY COLOR)
ORDER BY THE FOOT. ALWAYS SPECIFY COLOR CODE REQUIRED.
SEE WIRING DIAGRAM FOR CORRECT COLOR CODE.

WIRE HARNESSSES

DUE TO THE MULTIPLE CHANGES WITHIN THE WIRE HARNESSSES, THEY HAVE BEEN REMOVED FROM THIS MANUAL.

WHEN A WIRE HARNESS IS REQUIRED, IT IS IMPORTANT THAT THE CORRECT MODEL AND SERIAL NUMBERS BE SUBMITTED WITH THE ORDER. WE WILL THEN BE ABLE TO SUPPLY THE CORRECT WIRE HARNESS.

Amana Residential Amana DA1040 Washer Parts Parts Diagram 16 - POWER CORD, WIRE AND TERMINALS
Click on the part number to view part

| Item | Original Part Number | Replaced By | Status | Part Description |
|------|------------------------|-------------|---------------|---|
| 1 | 22660 | | Not Available | POWER CORD AND PLUG |
| 2 | 03673 | | Not Available | NUT |
| 3 | 03815 | | | Lockwasher, No.10 Ext Shk |
| 4 | 20267 | | | Screw, 10-24 X 3/8 Round |
| 5 | Y21429 | | Not Available | GROUND WIRE |
| 6 | 21430 | | Not Available | STRAP,GROUND |
| 7 | 21431 | | Not Available | ROUND HEAD SCREW |
| 8 | Y20276 | | Not Available | NUT |
| 9 | 00112 | | | Terminal, Spade-3/16 Fe |
| 10 | Y00119 | | Not Available | SPADE TERMINAL(18 GAUGE) (1/4 INCH-(1) 18 GAUGE WIRE) |
| 11 | Y00120 | | | Terminal, Flag-1/4 Fema |
| 12 | Y00116 | | | Terminal, Pin-Male |
| 13 | 23041 | | | Plug, 6 Circuit |
| " | 23040 | | | Plug-3 Circuit |
| " | 23033 | | | Plug, 9 Circuit |

| | | | |
|----|-----------------------|-------------------------|--------------------------------|
| " | 23035 | Not Available | PLUG,12 CIRCUIT |
| " | 23037 | | Plug, 15 Circuit |
| 14 | 23038 | Not Available | RECEPTACLE,15 CIRCUIT |
| " | 23036 | | Receptacle, 12 Circuit |
| " | 23039 | 697780 | Receptacle, |
| " | 23042 | Not Available | RECEPTACLE |
| " | Y23034 | 26163 | Receptacle, 9 Circuit |
| 15 | Y00117 | 5011-XX | 093 Female Socket |
| 16 | 00110 | | No.10 18 Gauge Wire |
| 17 | 21091 | Not Available | CONNECTOR TWO 1/4 INCH MALE |
| 18 | 51291 | | Clip, Wire |
| 19 | 21793 | Not Available | CABLE CLIP |
| 20 | 21036 | | Clip, Cable |
| 21 | 22837 | Not Available | STRAP,WIRE |

