

# Amana DA3691 17 - POWER CORD, WIRE AND TERMINALS

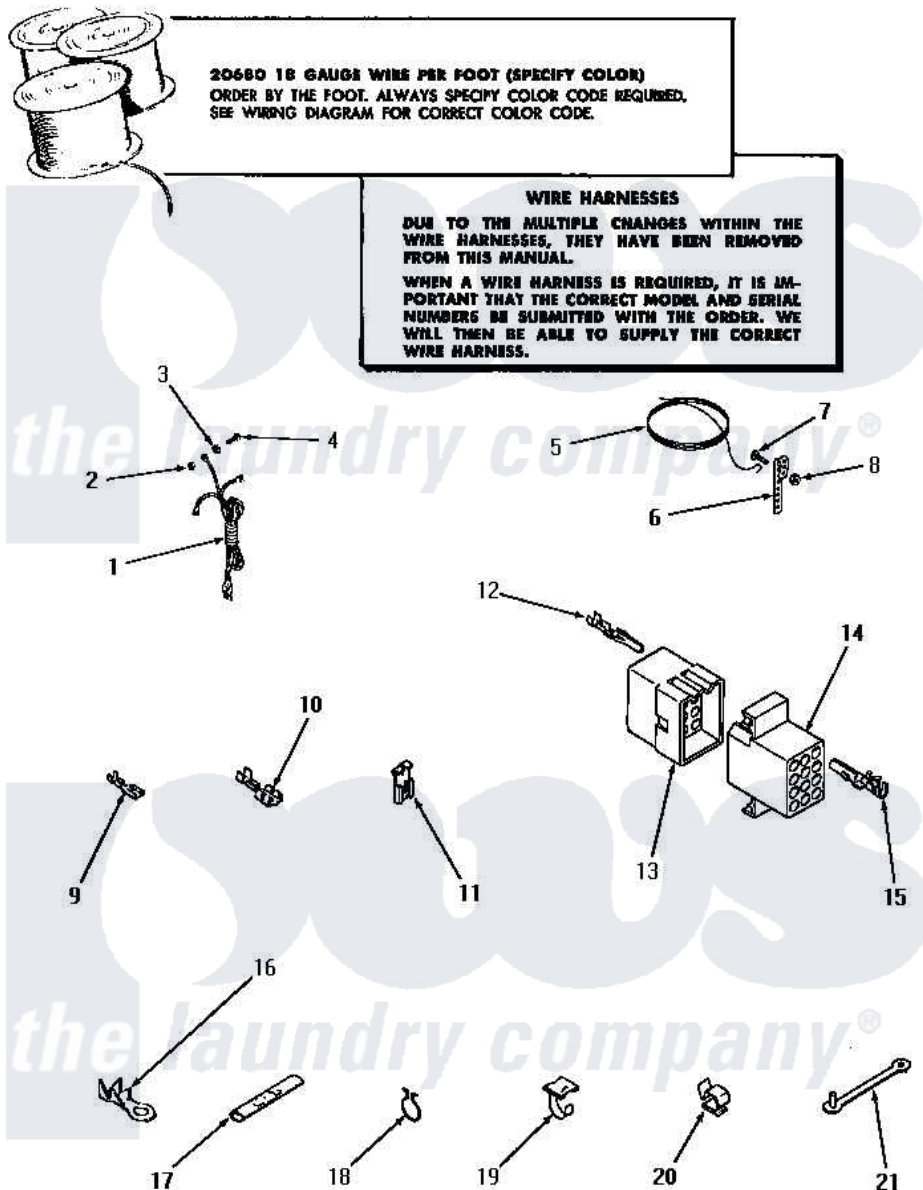

20680 18 GAUGE WIRE PER FOOT (SPECIFY COLOR)  
ORDER BY THE FOOT. ALWAYS SPECIFY COLOR CODE REQUIRED.  
SEE WIRING DIAGRAM FOR CORRECT COLOR CODE.

### WIRE HARNESSES

DUE TO THE MULTIPLE CHANGES WITHIN THE WIRE HARNESSSES, THEY HAVE BEEN REMOVED FROM THIS MANUAL.

WHEN A WIRE HARNESS IS REQUIRED, IT IS IMPORTANT THAT THE CORRECT MODEL AND SERIAL NUMBERS BE SUBMITTED WITH THE ORDER. WE WILL THEN BE ABLE TO SUPPLY THE CORRECT WIRE HARNESS.

Amana Residential Amana DA3691 Washer Parts Parts Diagram 17 - POWER CORD, WIRE AND TERMINALS  
Click on the part number to view part

Item	Original Part Number	Replaced By	Status	Part Description
1	22660		Not Available	POWER CORD AND PLUG
2	03673		Not Available	NUT
3	<a href="#">03815</a>			Lockwasher, No.10 Ext Shk
4	<a href="#">20267</a>			Screw, 10-24 X 3/8 Round
5	Y21429		Not Available	GROUND WIRE
6	21430		Not Available	STRAP,GROUND
7	21431		Not Available	ROUND HEAD SCREW
8	Y20276		Not Available	NUT
9	<a href="#">00112</a>			Terminal, Spade-3/16 Fe
10	Y00119		Not Available	SPADE TERMINAL(18 GAUGE) (1/4 INCH-(1) 18 GAUGE WIRE)
11	<a href="#">Y00120</a>			Terminal, Flag-1/4 Fema
12	<a href="#">Y00116</a>			Terminal, Pin-Male
13	<a href="#">23037</a>			Plug, 15 Circuit
"	23035		Not Available	PLUG,12 CIRCUIT
"	<a href="#">23033</a>			Plug, 9 Circuit

"	<a href="#">23041</a>		Plug, 6 Circuit
"	<a href="#">23040</a>		Plug-3 Circuit
14	<a href="#">23036</a>		Receptacle, 12 Circuit
"	23039	<a href="#">697780</a>	Receptacle,
"	Y23034	<a href="#">26163</a>	Receptacle, 9 Circuit
"	23042	Not Available	RECEPTACLE
"	23038	Not Available	RECEPTACLE, 15 CIRCUIT
15	Y00117	<a href="#">5011-XX</a>	093 Female Socket
16	<a href="#">00110</a>		No.10 18 Gauge Wire
17	21091	Not Available	CONNECTOR TWO 1/4 INCH MALE
18	<a href="#">51291</a>		Clip, Wire
19	21793	Not Available	CABLE CLIP
20	<a href="#">21036</a>		Clip, Cable
21	22837	Not Available	STRAP,WIRE
NI	20680	Not Available	18 GAUGE WIRE

