

# Amana DA3781 01 - ACCESSORIES

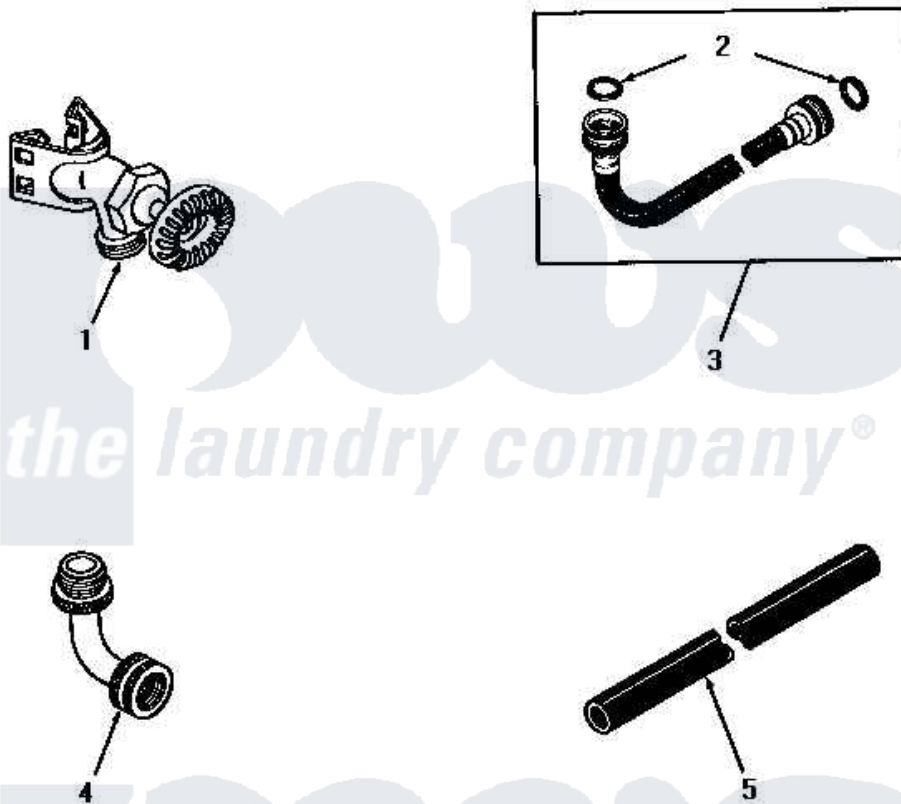

*the laundry company®*

*the laundry company®*

**258P3 CAPACITOR KIT**  
 Use on automatic washers, with reversing motors, that are located in areas where low voltage exists. This kit will help eliminate motor burn outs.

Amana [Residential Amana DA3781 Washer Parts](#) Parts Diagram 01 - ACCESSORIES

[Click on the part number to view part](#)

Item	Original Part Number	Replaced By	Status	Part Description
1	20655		Not Available	SADDLE FAUCETS, PAIR
2	20290	<a href="#">Y013783</a>		Washer, Inlet Hose
3	20618	<a href="#">21001467</a>		Hose- 10'
"	20617		Not Available	HOSE, INLET (8 FT)
4	20656		Not Available	90 DEGREE INLET ELBOW
5	20616		Not Available	EXTENSION, DRAIN HOSE (1 FT)
NI	258P3		Not Available	KIT,CAPACITOR

*the laundry company®*