

Amana DA6250 18 - POWER CORD, WIRE AND TERMINALS

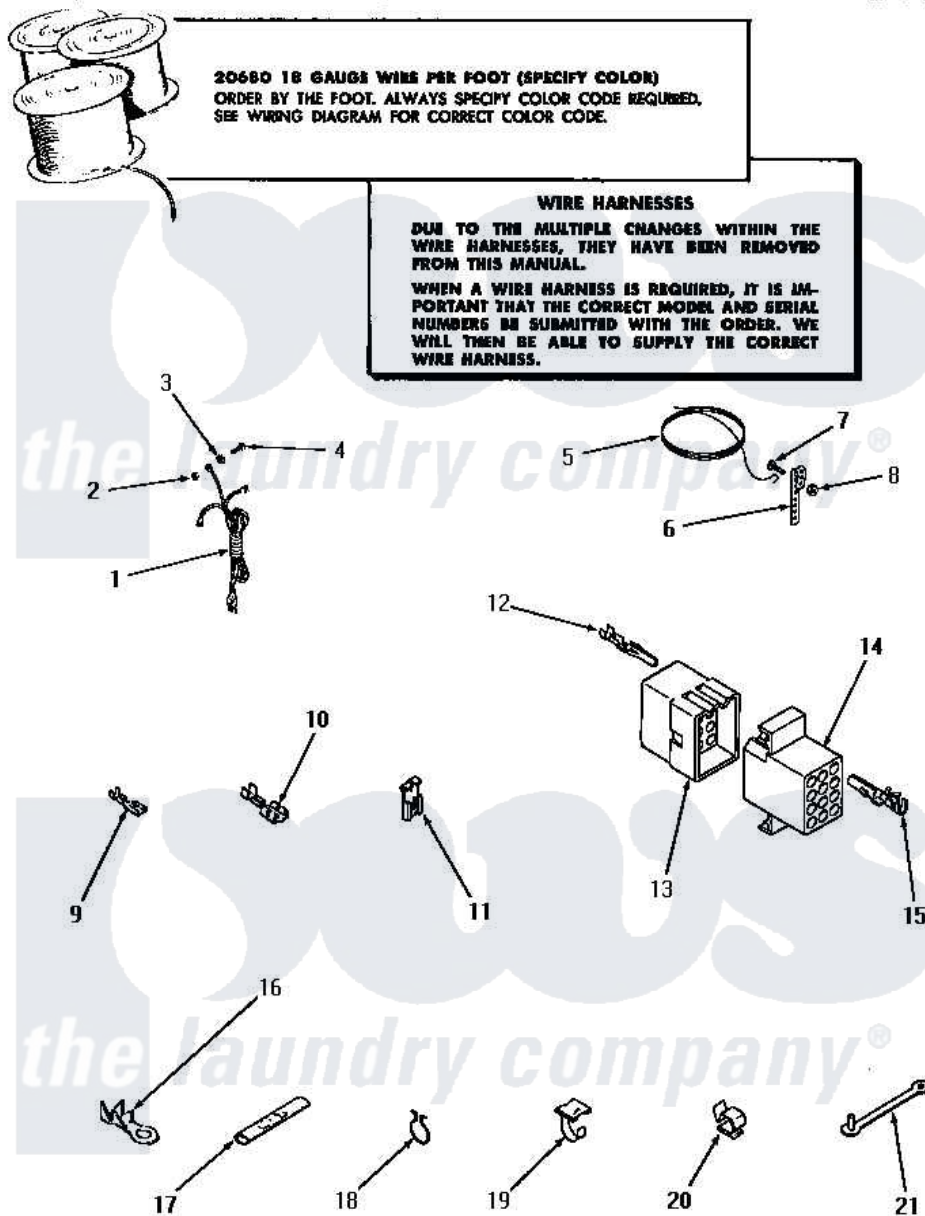

Amana [Residential Amana DA6250 Washer Parts](#) Parts Diagram 18 - POWER CORD, WIRE AND TERMINALS
Click on the part number to view part

Item	Original Part Number	Replaced By	Status	Part Description
1	22660		Not Available	POWER CORD AND PLUG
2	03673		Not Available	NUT
3	03815			Lockwasher, No.10 Ext Shk
4	20267			Screw, 10-24 X 3/8 Round
5	Y21429		Not Available	GROUND WIRE
6	21430		Not Available	STRAP,GROUND
7	21431		Not Available	ROUND HEAD SCREW
8	Y20276		Not Available	NUT
9	00112			Terminal, Spade-3/16 Fe
10	Y00119		Not Available	SPADE TERMINAL(18 GAUGE) (1/4 INCH-(1) 18 GAUGE WIRE)
11	Y00120			Terminal, Flag-1/4 Fema
12	Y00116			Terminal, Pin-Male
13	23037			Plug, 15 Circuit
"	23035		Not Available	PLUG,12 CIRCUIT
"	23033			Plug, 9 Circuit

"	23041		Plug, 6 Circuit
"	23040		Plug-3 Circuit
14	23036		Receptacle, 12 Circuit
"	23039	697780	Receptacle,
"	Y23034	26163	Receptacle, 9 Circuit
"	23042	Not Available	RECEPTACLE
"	23038	Not Available	RECEPTACLE, 15 CIRCUIT
15	Y00117	5011-XX	093 Female Socket
16	00110		No.10 18 Gauge Wire
17	21091	Not Available	CONNECTOR TWO 1/4 INCH MALE
18	51291		Clip, Wire
19	21793	Not Available	CABLE CLIP
20	21036		Clip, Cable
21	22837	Not Available	STRAP,WIRE
NI	20680	Not Available	18 GAUGE WIRE

