

# Amana FA6010 17 - POWER CORD, WIRE & TERMINALS

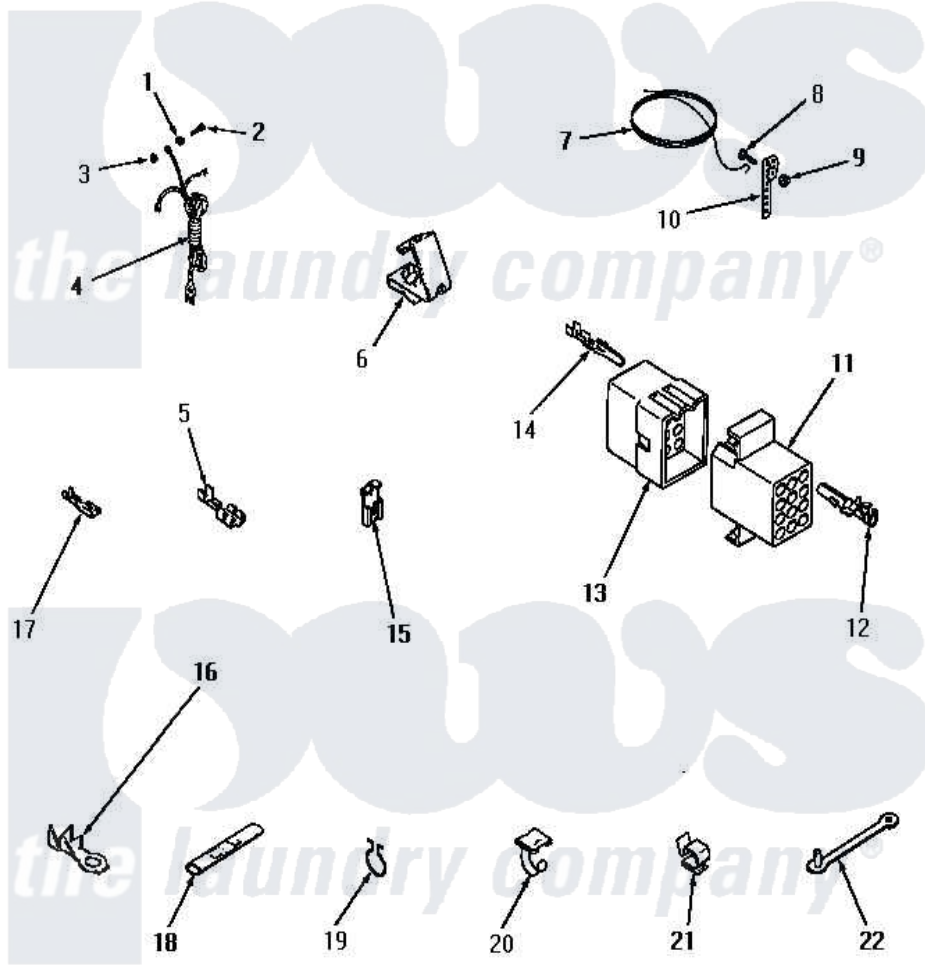

## POWER CORD, WIRE AND TERMINALS

Amana [Residential Amana FA6010 Washer Parts](#) Parts Diagram 17 - POWER CORD, WIRE & TERMINALS  
 Click on the part number to view part

| Item | Original Part Number  | Replaced By            | Status        | Part Description                                      |
|------|-----------------------|------------------------|---------------|---|
| 1    | <a href="#">03815</a> |                        |               | Lockwasher, No.10 Ext Shk                             |
| 2    | <a href="#">20267</a> |                        |               | Screw, 10-24 X 3/8 Round                              |
| 3    | 03673                 |                        | Not Available | NUT   |
| 4    | 22660                 |                        | Not Available | POWER CORD AND PLUG                                   |
| 5    | Y00119                |                        | Not Available | SPADE TERMINAL(18 GAUGE) (1/4 INCH-(1) 18 GAUGE WIRE) |
| 6    | 00158                 |                        | Not Available | GROUND CLIP   |
| 7    | Y21429                |                        | Not Available | GROUND WIRE   |
| 8    | 21431                 |                        | Not Available | ROUND HEAD SCREW                                      |
| 9    | Y20278                |                        | Not Available | LOCKWASHER  |
| 10   | 21430                 |                        | Not Available | STRAP,GROUND  |
| 11   | 23042                 |                        | Not Available | RECEPTACLE  |
| "    | Y23034                | <a href="#">26163</a>  |               | Receptacle, 9 Circuit                                 |
| "    | <a href="#">23036</a> |                        |               | Receptacle, 12 Circuit                                |
| "    | 23038                 |                        | Not Available | RECEPTACLE,15 CIRCUIT                                 |
| "    | 23039                 | <a href="#">697780</a> |               | Receptacle,   |

|    |                        |                         |               |                                |
|----|------------------------|-------------------------|---------------|--------------------------------|
| 12 | Y00117                 | <a href="#">5011-XX</a> |               | 093 Female Socket              |
| 13 | 23035                  |                         | Not Available | PLUG,12 CIRCUIT                |
| "  | <a href="#">23033</a>  |                         |               | Plug, 9 Circuit                |
| "  | <a href="#">23037</a>  |                         |               | Plug, 15 Circuit               |
| "  | <a href="#">23041</a>  |                         |               | Plug, 6 Circuit                |
| "  | <a href="#">23040</a>  |                         |               | Plug-3 Circuit                 |
| 14 | <a href="#">Y00116</a> |                         |               | Terminal, Pin-Male             |
| 15 | <a href="#">Y00120</a> |                         |               | Terminal, Flag-1/4 Fema        |
| 16 | <a href="#">00110</a>  |                         |               | No.10 18 Gauge Wire            |
| 17 | <a href="#">00112</a>  |                         |               | Terminal, Spade-3/16 Fe        |
| 18 | 21091                  |                         | Not Available | CONNECTOR TWO 1/4 INCH<br>MALE |
| 19 | <a href="#">51291</a>  |                         |               | Clip, Wire                     |
| 20 | 21793                  |                         | Not Available | CABLE CLIP                     |
| 21 | <a href="#">21036</a>  |                         |               | Clip, Cable                    |
| 22 | 22837                  |                         | Not Available | STRAP,WIRE                     |

