

# Amana HA5590 14 - MOTOR, MTG BRACKET, BELTS & IDLER ASSY

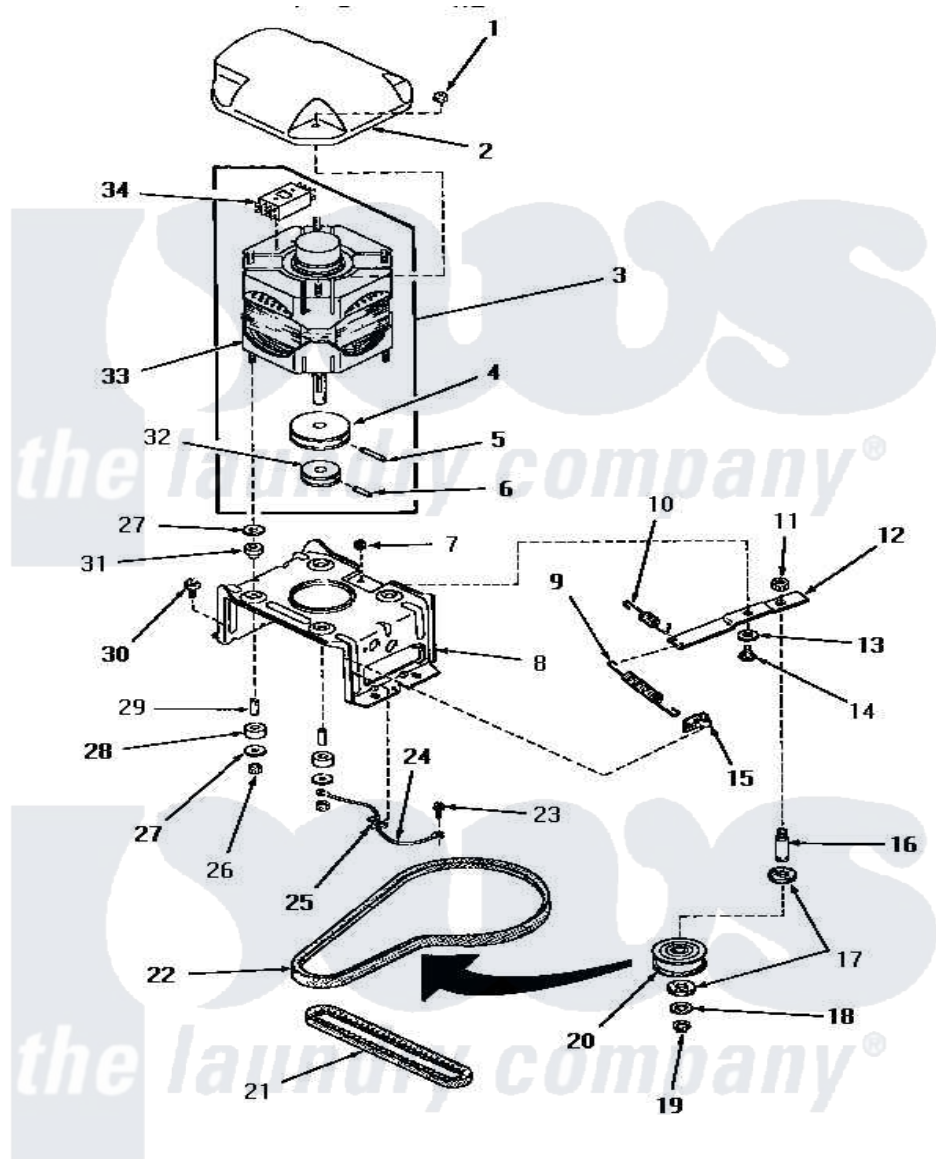

**MOTOR, MOUNTING BRACKET, BELTS AND IDLER ASSEMBLY**  
(starting with Serial No. C3486774)

Amana [Residential Amana HA5590 Washer Parts](#) Parts Diagram 14 - MOTOR, MTG BRACKET, BELTS & IDLER ASSY  
Click on the part number to view part

Item	Original Part Number	Replaced By	Status	Part Description
1	<a href="#">27201</a>			Locknut
2	<a href="#">27136</a>			Shield, Motor
3	27179	<a href="#">27179P</a>		Motor-Drve
4	27171		Not Available	PULLEY,MOTOR
5	<a href="#">23750</a>			Pin, Roll
6	<a href="#">10416</a>			Pin, Roll
7	52566	<a href="#">27001225</a>		Nut, Jam Mid Lock 1/4-20
8	<a href="#">28791</a>			Bracket, Motor Mount
9	28807	<a href="#">37366</a>		Spring, Idler
10	30620		Not Available	SPRING,IDLER LEVER HEL
11	28803	<a href="#">2221070</a>		Clamp, Nylon
12	31054	<a href="#">40041002</a>		Lever, Idler
13	81392	<a href="#">40054701</a>		Washer
14	27229	<a href="#">40038901</a>		Screw, 1/4-20
15	<a href="#">28849</a>			Clip, Spring
16	<a href="#">28802</a>			Shaft, Idler

17	<a href="#">Y29443</a>		Washer, Felt
18	<a href="#">52549</a>		Washer, 501 ID X3/4 Odx
19	<a href="#">23748</a>		Ring, Retaining
20	28800	Not Available	WHEEL, IDLER
21	<a href="#">27155</a>		Belt, Pump
22	<a href="#">28808</a>		Belt, Agitate And Spin
23	26592	Not Available	HEX HEAD SCREW
24	Y00000000	Not Available	SEE NOTE GROUND WIRE, GREEN
25	Y00161	<a href="#">B5733302</a>	Clip, Ground
26	<a href="#">23604</a>		Nut, Hex 10-32 Lock
27	03888	Not Available	WASHER
28	01953	Not Available	WASHER, LOWER MOTOR MOU
29	27181	Not Available	SPACER, MOTOR
30	<a href="#">27157</a>		Screw, 10-24 X 5/8 Spec
31	<a href="#">01952A</a>		Mounting, Rubber
32	Y27104	Not Available	PULLEY, MOTOR
33	27772	<a href="#">27179P</a>	Motor-Drve
"	30895	<a href="#">27179P</a>	Motor-Drve
34	24139	Not Available	SWITCH, MOTOR
"	24140	Not Available	SWITCH, MOTOR
"	30895A	<a href="#">30895AP</a>	Switch Motor-W/Instr
"	30897A	<a href="#">30897AP</a>	Switch- MO
"	24142	Not Available	SWITCH, MOTOR
"	<a href="#">Y24149</a>		Switch, Motor
NI	20605	Not Available	LUBE, HI TEMPERATURE-56
"	258P3	Not Available	KIT, CAPACITOR

*the laundry company*<sup>®</sup>

**laund**  
*the laundry company*<sup>®</sup>