

Amana LED950 (BOM: P7804827W) 07 - POWER CORD AND TERMINALS

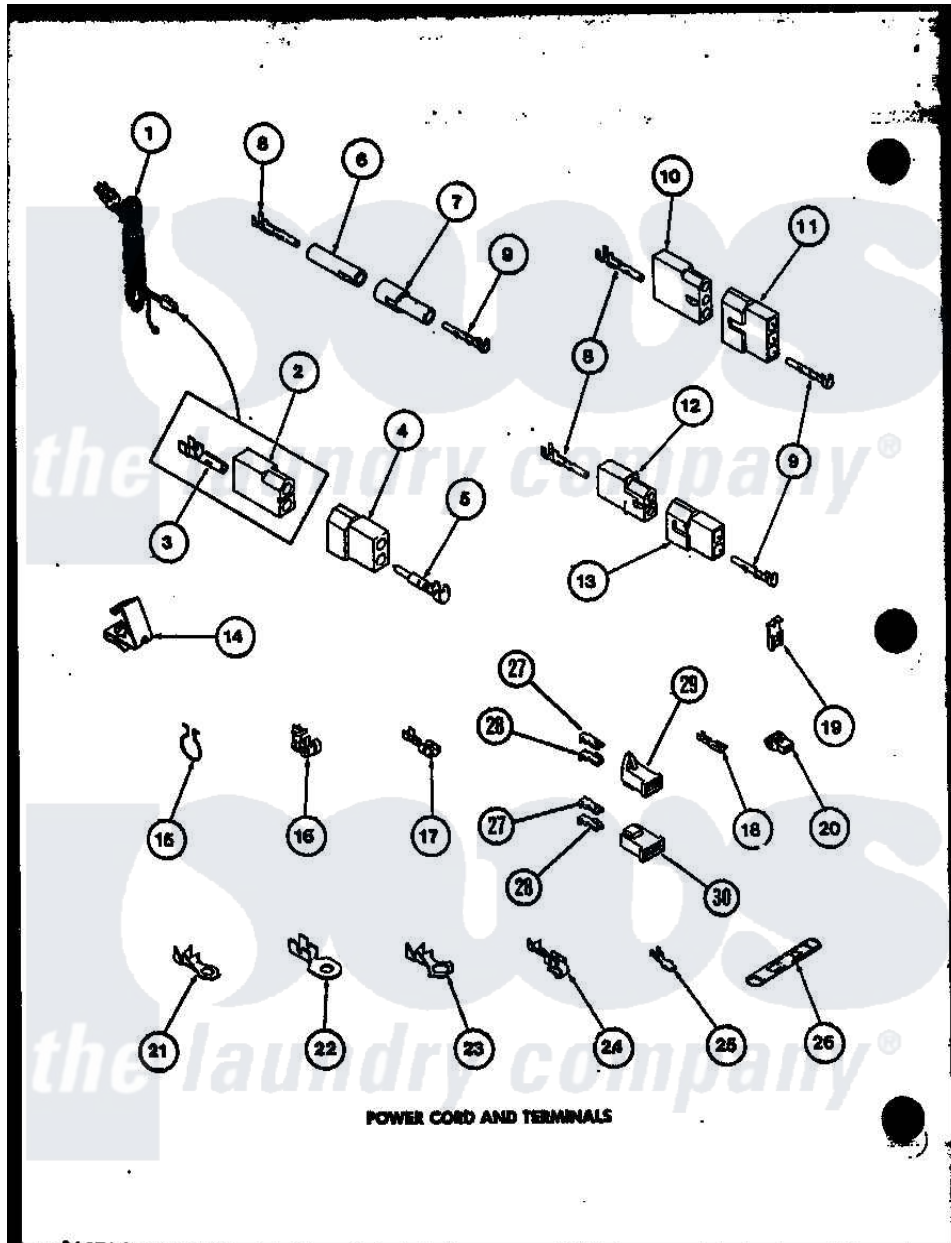

Amana Residential Amana LED950 (BOM: P7804827W) Dryer Parts Parts Diagram 07 - POWER CORD AND TERMINALS

Click on the part number to view part

| Item | Original Part Number | Replaced By | Status | Part Description |
|------|----------------------|--------------------------|---------------|--|
| 6 | R0605035 | 26301 | | Receptacle, Molex |
| 7 | R0605036 | | Not Available | CONNECTOR |
| 8 | R0605004 | 5011-XX | | 093 Female Socket |
| 9 | R0605003 | Y00116 | | Terminal, Pin-Male |
| 10 | R0605033 | | Not Available | RECEPTACLE |
| 11 | R0605034 | 23040 | | Plug-3 Circuit |
| 12 | R0605038 | | Not Available | RECEPTACLE |
| 13 | R0605037 | 56448 | | Terminal Block Plug |
| 14 | R0605032 | B5733302 | | Clip, Ground |
| 15 | R0601522 | 51291 | | Clip, Wire |
| 16 | R0601502 | 211881 | | Grommet, Cord Part Not Used- Gas Models Only |
| 17 | R0605005 | | Not Available | TERMINAL |
| 18 | R0605002 | 00112 | | Terminal, Spade-3/16 Fe |
| 19 | R0605006 | Y00120 | | Terminal, Flag-1/4 Fema |
| 20 | R0605011 | | Not Available | INSULATOR |

| | | | |
|----|----------|------------------------|---|
| 21 | R0605026 | 00110 | No.10 18 Gauge Wire |
| 22 | R0605027 | Y00111 | Ring Terminal No.10 No.10 18 Gauge Wires Or |
| 23 | R0605007 | | Not Available TERMINAL |
| 24 | R0605028 | Y00114 | Spade Terminal |
| 25 | R0605031 | Y00138 | Male Tab Terminal 18 Gauge Wire) |
| 26 | R0605008 | | Not Available CONNECTOR |
| 27 | R0605070 | Y00189 | Terminal, Spade |
| 28 | R0605071 | Y00190 | Connector-Receptacle |
| 29 | R0605072 | 58799 | Connector-2 Circuit |
| 30 | R0605073 | | Not Available TERMINAL BLOCK |

