

Amana LG9209W2 (BOM: PLG9209W2) 20 - TERMINALS

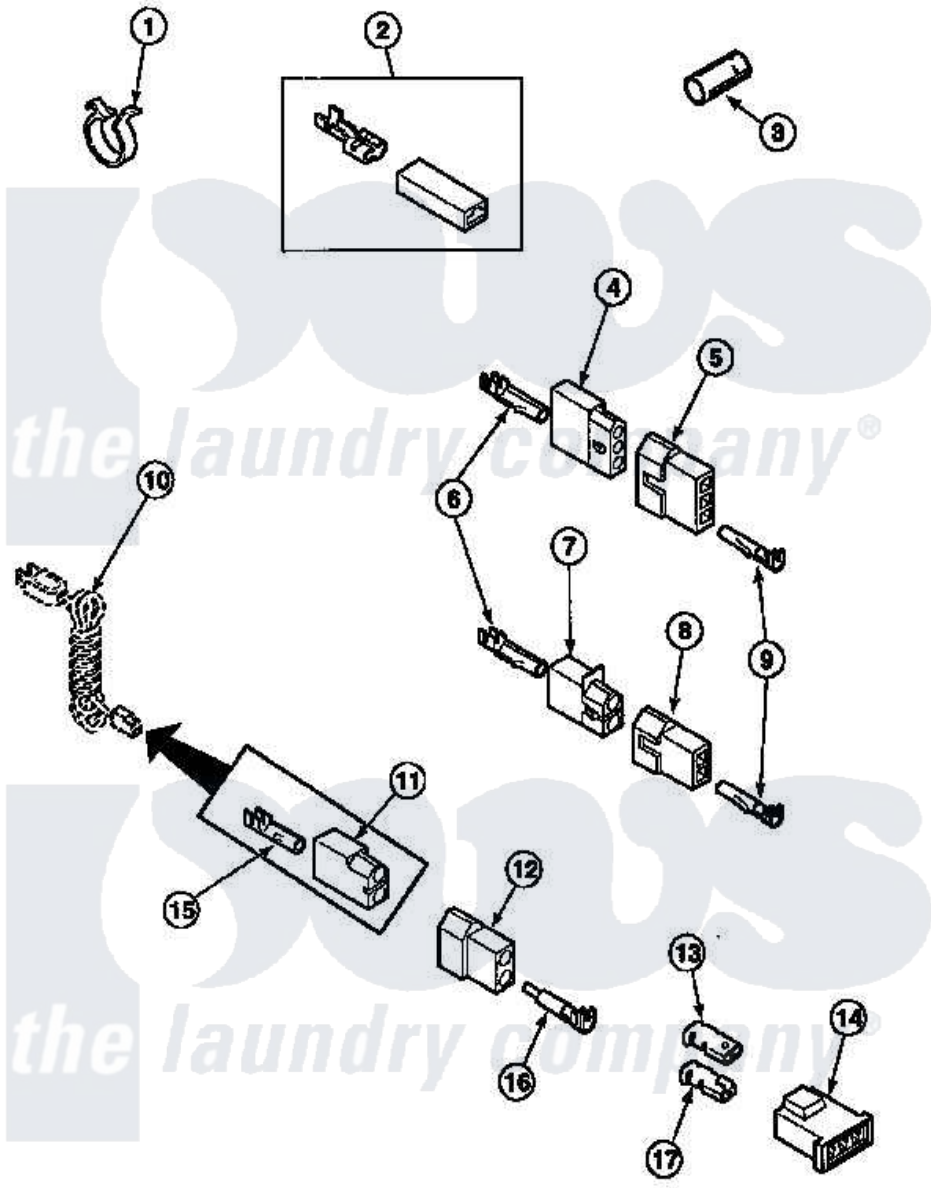

Amana [Residential Amana LG9209W2 \(BOM: PLG9209W2\) Dryer Parts](#) Parts Diagram 20 - TERMINALS
 Click on the part number to view part

| Item | Original Part Number | Replaced By | Status | Part Description |
|------|------------------------|--------------------------|---------------|--|
| 1 | 61510 | 504034 | | Clip, Wire |
| 2 | Y00237 | | | Terminal-Female 1/4 ((1) 12 GAUGE Wire Or(2) 18 GA |
| 4 | 23039 | 697780 | | Receptacle, |
| 5 | 23040 | | | Plug-3 Circuit |
| 6 | Y00117 | 5011-XX | | 093 Female Socket |
| 7 | 56451 | | | Receptacle, 2 Circuit |
| 8 | 56448 | | | Terminal Block Plug |
| 9 | Y00116 | | | Terminal, Pin-Male |
| 10 | Y56222 | 27001142 | | Cord, Power |
| 11 | 56265 | | | Receptacle, 2 Circuit |
| 12 | 56266 | | | Plug |
| 13 | Y00189 | | | Terminal, Spade |
| 14 | 58800 | | Not Available | CONNECTOR-3 CIRCUIT (3 CIRCUIT CONNECTOR) |
| 15 | 00130 | | | Terminal, Pin-1/8 Femal |
| 16 | Y00127 | | | Terminal, Pin-1/8 Male |

