

Amana LGD251 (BOM: P7762208W W) 06 - MOTOR

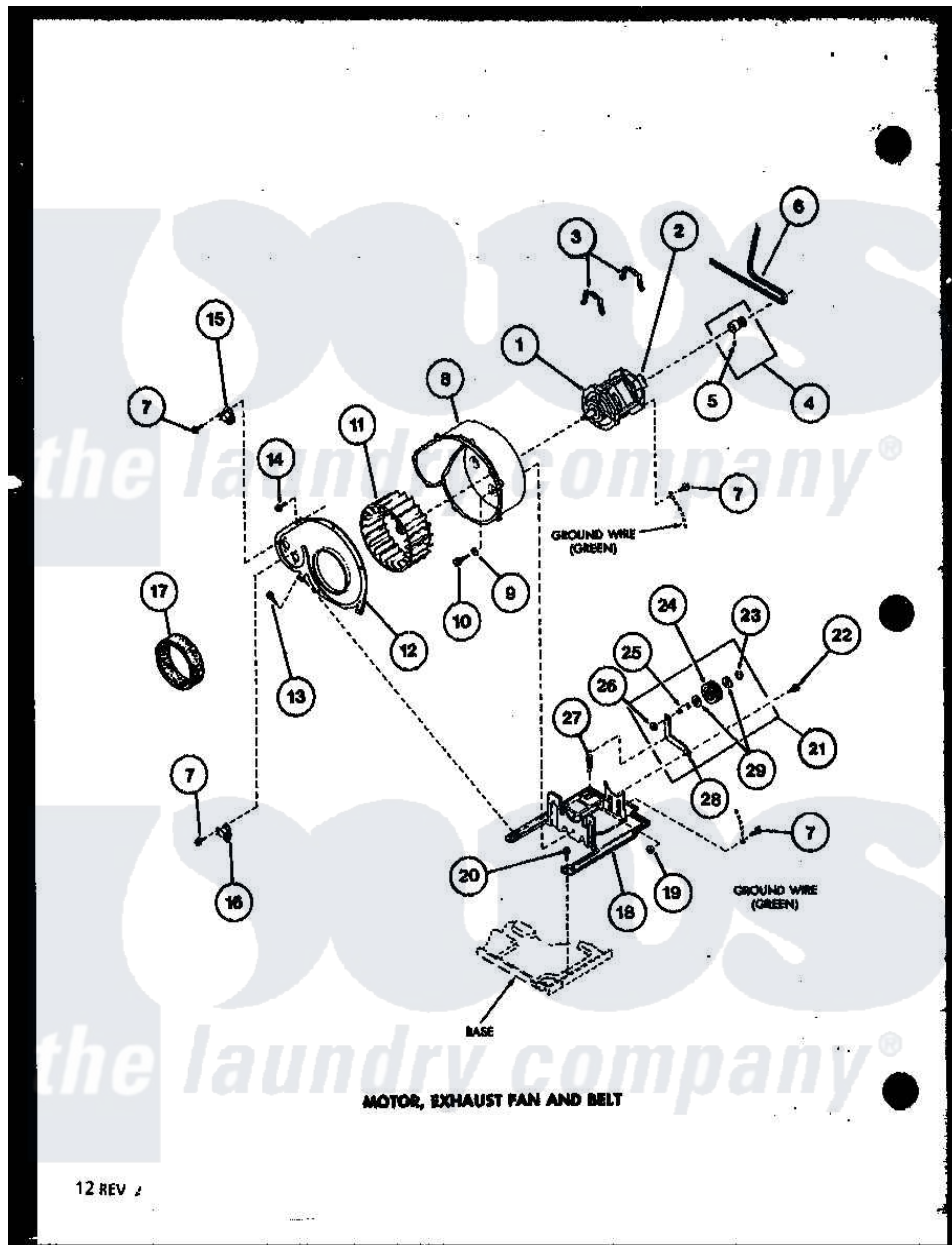

Amana Residential Amana LGD251 (BOM: P7762208W W) Washer Parts Diagram 06 - MOTOR
 Click on the part number to view part

| Item | Original Part Number | Replaced By | Status | Part Description |
|------|--------------------------|---------------------------|---------------|--|
| 1 | R0607005 | 915P3 | | Motor-Drve |
| 2 | R0602516 | | | Motor Switch |
| " | R0602517 | | Not Available | SWITCH |
| " | R0602533 | | Not Available | MOTOR SWITCH |
| 3 | R0601526 | 660658 | | Clamp, Motor Mounting 343481 685441 |
| 4 | R0610059 | | Not Available | KIT,PULLEY & SETSCREW |
| 5 | R0600042 | | Not Available | SET SCREW |
| 6 | R0606549 | 40111201 | | Belt, Cylinder |
| 7 | R0600033 | 489464 | | Screw |
| 8 | R0603034 | 56020 | | Housing, Blower |
| 9 | R0600529 | 20176 | | Washer, .2656 ID x 9/16 OD |
| 10 | R0600028 | 27001200 | | Screw |
| 11 | R0603532 | 510139P | | Assembly Blower Fan Package |
| 12 | R0603033 | | Not Available | HSG COVER |
| 13 | R0600001 | W10116760 | | Screw |

| | | | |
|----|----------|---------------------------|-----------------------------|
| 14 | R0600004 | W10116760 | Screw |
| 15 | R0611001 | 56410 | Thermostat |
| 16 | R0611002 | | Not Available THERMOSTAT |
| 17 | R0604509 | | Not Available FELT SEAL |
| 18 | R0605562 | 503613 | Mount, Motor |
| 19 | R0601011 | 27001225 | Nut, Jam Mid Lock 1/4-20 |
| 20 | R0600017 | | Not Available SCREW |
| 21 | R0610019 | 56170P | Assembly- Idle |
| 22 | R0600043 | | Not Available SCREW |
| 23 | R0601527 | 23748 | Ring, Retaining |
| 24 | R0609504 | Y54414 | Assembly, Wheel And Bearing |
| 25 | R0605560 | 56461 | Shaft |
| 26 | R0601009 | 358160 | Nut |
| 27 | R0605563 | 56076 | Spring, Idler |
| 28 | R0605561 | | Not Available LEVER, IDLER |
| 29 | R0600526 | 52549 | Washer, 501 ID X3/4 Odx |

