

Amana LWC07AW (BOM: PLWC07AW) 04 - CONNECTION BLOCKS AND EXTRACTOR TOOL

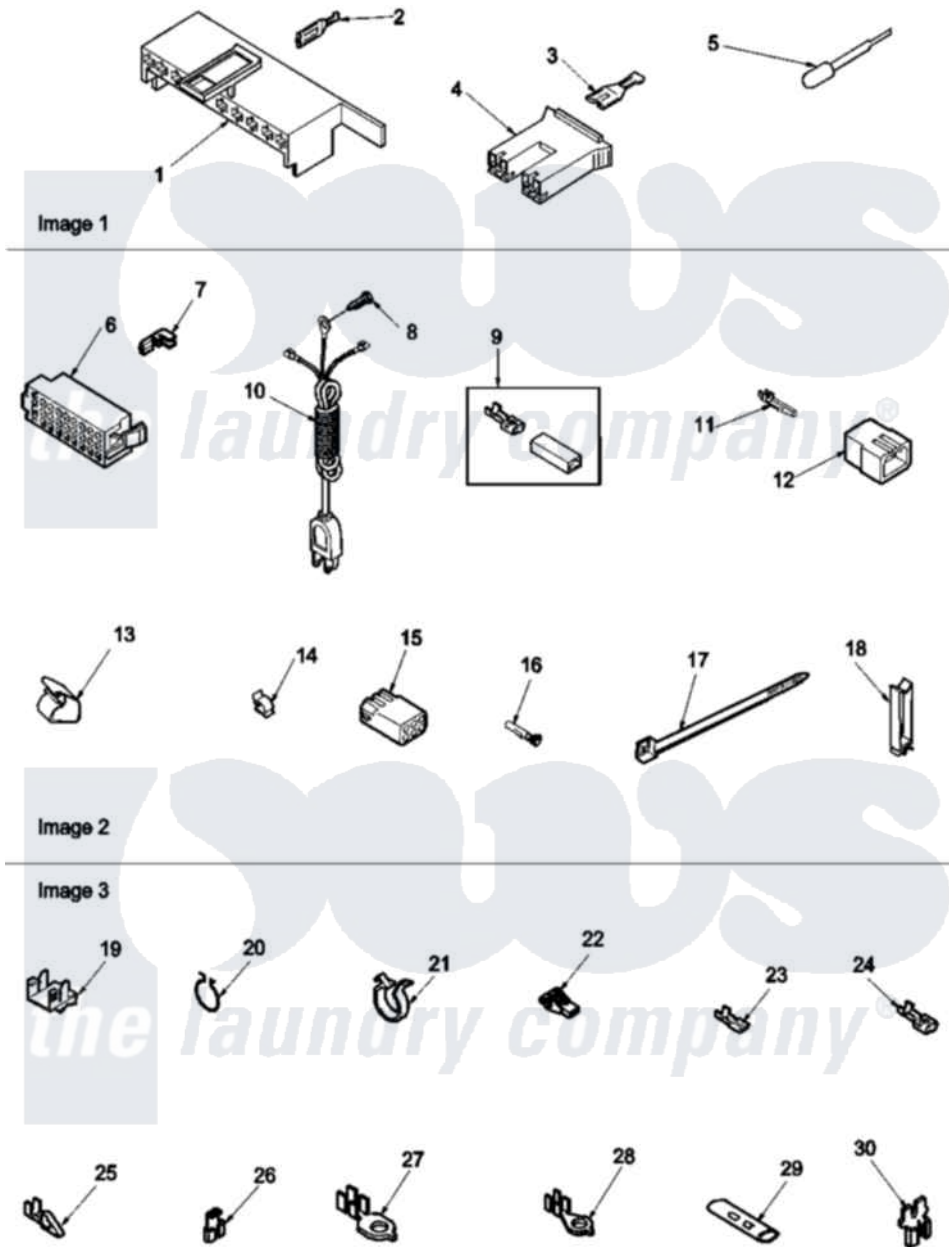

Amana Residential Amana LWC07AW (BOM: PLWC07AW) Washer Parts Parts Diagram 04 - CONNECTION BLOCKS AND EXTRACTOR TOOL

[Click on the part number to view part](#)

| Item | Original Part Number | Replaced By | Status | Part Description |
|------|------------------------|-----------------------|---------------|---|
| 1 | 34677 | | | 10 Circuit Plug |
| 2 | Y00188 | | | Molex Terminal |
| 3 | Y00121 | | Not Available | SPADE TERMINAL(12 GAUGE) (1/4 INCH-(2) 18 GAUGE WIRES O |
| 4 | 34675 | | Not Available | PLUG |
| " | 34676 | | | Plug |
| 5 | 283P4 | | | Terminal Extractor Tool |
| 6 | 32746 | | | Housing, RH-24 Positi |
| " | 34123 | | | Housing, LH -24 Position |
| 7 | Y00188 | | | Molex Terminal |
| 8 | 52909 | | | Screw, 10B-16 X 1/2 HeX |
| 9 | 00234 | 00359 | | Terminal Ultra Pod 250 X032F |
| 10 | Y34458 | | Not Available | POWER CORD ALL |
| 11 | Y00116 | | | Terminal, Pin-Male |

| | | | |
|----|------------------------|--------------------------|---|
| 12 | 23041 | | Plug, 6 Circuit |
| " | 23033 | | Plug, 9 Circuit |
| " | 26302 | Not Available | PLUG,1 CIRCUIT |
| 13 | 35521 | Not Available | CLIP,HARNESS HOLDER |
| 14 | 21036 | | Clip, Cable |
| 15 | 26301 | | Receptacle, Molex |
| " | 26708 | | Receptacle, 6 Circuit |
| " | 26163 | | Receptacle, 9 Circuit |
| 16 | Y00117 | 5011-XX | 093 Female Socket |
| 17 | 36466 | M0321209 | Tie-Electrical |
| 18 | 36274 | Not Available | CLIP, HARNESS |
| 19 | Y00161 | B5733302 | Clip, Ground |
| 20 | 51291 | | Clip, Wire |
| 21 | 504034 | | Clip, Wire |
| 22 | 70210 | Not Available | INSULATOR,BLUE |
| 23 | 00112 | | Terminal, Spade-3/16 Fe |
| 24 | Y00119 | Not Available | SPADE TERMINAL(18 GAUGE) (1/4 INCH-(1) 18 GAUGE WIRE) |
| 25 | 00220 | Not Available | TERMINAL,CRIMP-SINGLE |
| 26 | Y00120 | | Terminal, Flag-1/4 Fema |
| 27 | Y00113 | Not Available | TERMINAL,RING-1/4 STUD |
| 28 | 00110 | | No.10 18 Gauge Wire |
| 29 | 21091 | Not Available | CONNECTOR TWO 1/4 INCH MALE |
| 30 | 29673 | Not Available | DOUBLE CONNECTOR |

