

**Amana TW3502G (BOM: P1163209W G) 09 - INLET/FILL HOSE & MIXING VLV MTG BRKT**

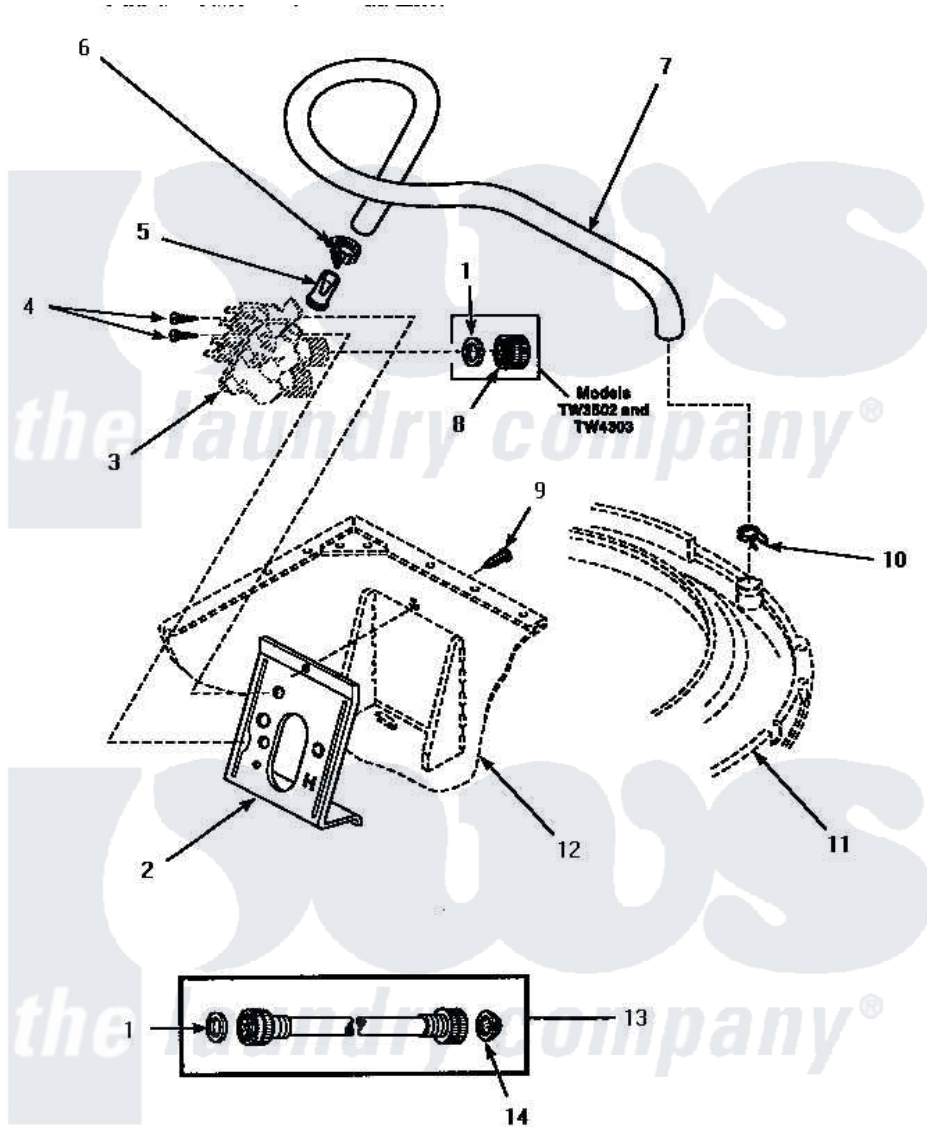

**INLET HOSE, FILL HOSE AND MIXING VALVE MOUNTING BRACKET**

Amana [Residential Amana TW3502G \(BOM: P1163209W G\) Washer Parts](#) Parts Diagram 09 - INLET/FILL HOSE & MIXING VLV MTG BRKT

[Click on the part number to view part](#)

Item	Original Part Number	Replaced By	Status	Part Description
1	20290	<a href="#">Y013783</a>		Washer, Inlet Hose
2	34972	<a href="#">39407</a>		Bracket, Valve
3	Y00000000		Not Available	SEE NOTE MIXING VALVE ASSEMBLY
4	56392		Not Available	SCREW,8-18 X 3/8 TAPPI
5	34500	<a href="#">22001900</a>		Preventer, Back Flow
6	27643	<a href="#">596669</a>		Clamp, Manifold
7	35874	<a href="#">38155</a>		Hose, Mix Valve To TU
8	<a href="#">24145</a>			Cap
9	33562	<a href="#">27001200</a>		Screw
10	<a href="#">29210</a>			Hose Clamp
11	Y00000000		Not Available	SEE NOTE OUTER TUB COVER
12	Y00000000		Not Available	SEE NOTE CABINET
13	28330P	<a href="#">202860</a>		Inlet Hose Assembly

