

# Hoover LATH300AKM 04 - TOP

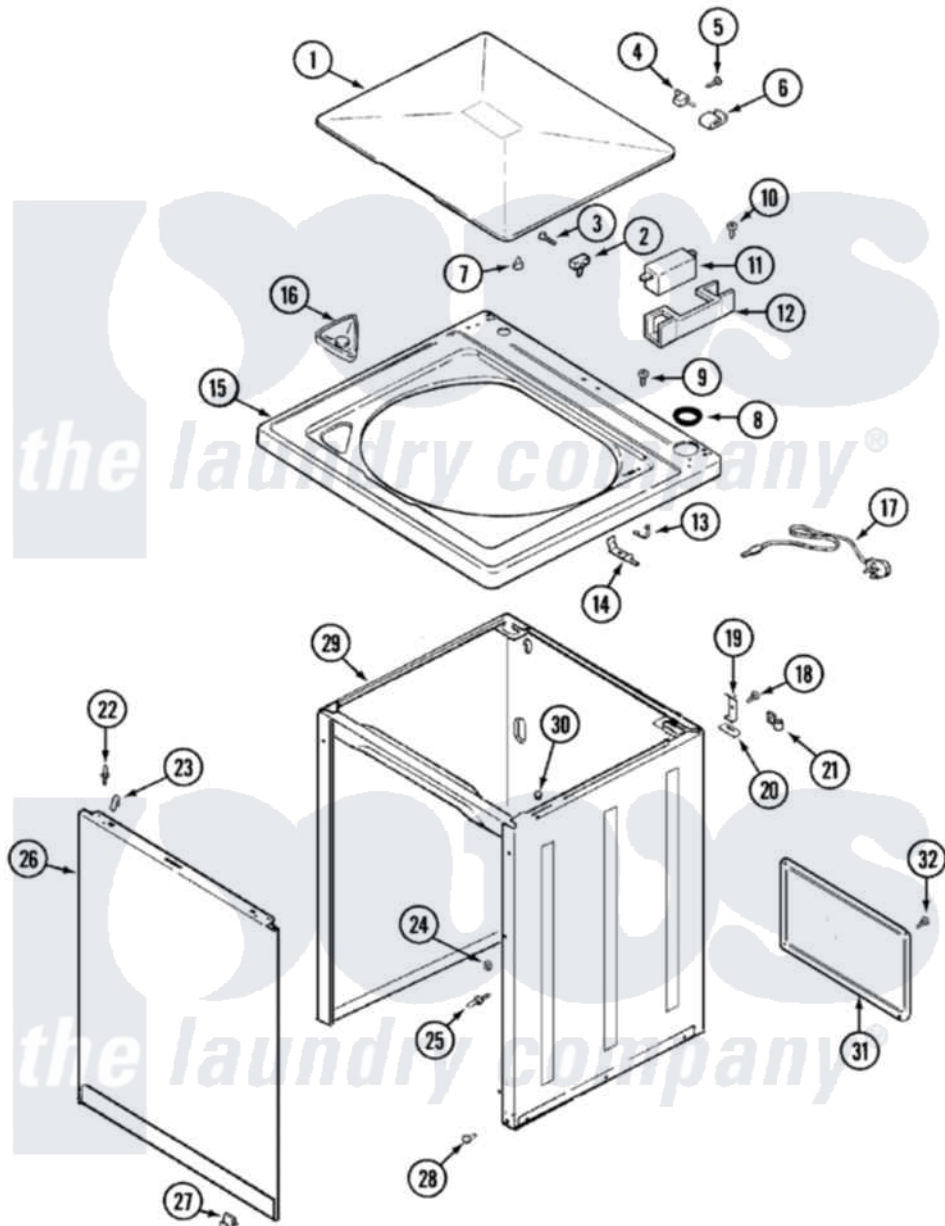

Hoover [Residential Hoover LATH300AKM Washer Parts](#) Parts Diagram 04 - TOP  
 Click on the part number to view part

Item	Original Part Number	Replaced By	Status	Part Description
1	35-2026-24		Not Available	LID (ALM)
2	<a href="#">25-7436</a>			Nylite Washer
"	<a href="#">43-0057</a>			Actuator, Door Switch
3	<a href="#">25-7438</a>			Screw
4	<a href="#">35-2045</a>			Pin, Hinge
5	<a href="#">25-7893</a>			Screw
6	<a href="#">35-2044</a>			Hinge, Lid
7	<a href="#">35-0581</a>			Bumper, Door
8	<a href="#">35-2063</a>			Bushing, Insulator
9	25-7463	<a href="#">7101P012-60</a>		Screw
10	21001136	<a href="#">3400872</a>		Screw, 8-18 X 3/8
11	21001148	<a href="#">12001187</a>		Kit, Lid Switch Assembly
"	35-2904		Not Available	PAD, LID SWITCH
"	21001137	<a href="#">12001187</a>		Kit, Lid Switch Assembly
12	<a href="#">21001135</a>			Housing, Lid Switch
13	<a href="#">25-7878</a>			Clip

14	<a href="#">21001134</a>		Lever, Lid Switch
15	35-2739-24	Not Available	TOP, CABINET (ALM)
16	<a href="#">21001167</a>		Dispenser, Bleach
17	21001376	Not Available	CORD, POWER
"	<a href="#">35-1007</a>		Strain Relief
18	25-7732	<a href="#">681414</a>	Screw, 10AB X 1/2
19	<a href="#">35-2846</a>		Hinge, Cabinet Top
20	<a href="#">35-4128</a>		Pad, Hinge
21	25-7796	<a href="#">596669</a>	Clamp, Manifold
22	<a href="#">53-0643</a>		Pin, Locator
"	<a href="#">35-4129</a>		Bumper, Cabinet
23	<a href="#">25-7220</a>		Clip, Cabinet Top
24	25-0224	<a href="#">3400029</a>	Nut, Adapter Plate
"	<a href="#">53-0200</a>		Sleeve, Locator Pin
25	<a href="#">53-0643</a>		Pin, Locator
26	<a href="#">35-2084-24</a>		Panel, Front
"	35-4200	<a href="#">21001281</a>	Damper, Sound Pad
27	<a href="#">53-0120</a>		Clip, Front Panel
28	<a href="#">33-2653</a>		Bumper, Cabinet
29	35-2106-24	<a href="#">12001802</a>	Kit, Cabinet/Rear Shield
30	<a href="#">33-2653</a>		Bumper, Cabinet
31	35-2108	<a href="#">21001871</a>	Cabinet
32	25-7733	<a href="#">681414</a>	Screw, 10AB X 1/2

