

Magic Chef YE26HN2 10 - TUMBLER (REV. E-G)

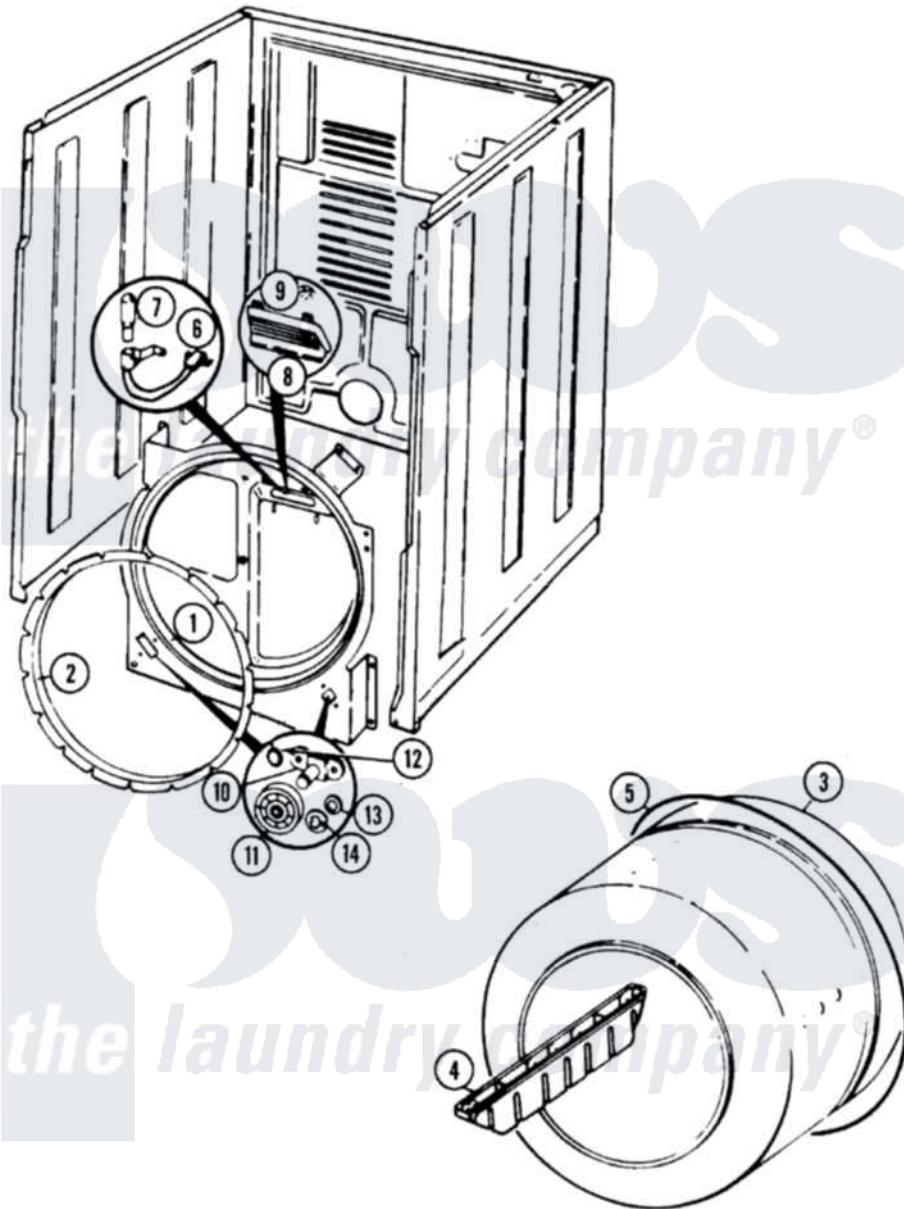

Magic Chef [Residential Magic Chef YE26HN2 Dryer Parts](#) Parts Diagram 10 - TUMBLER (REV. E-G)
 Click on the part number to view part

| Item | Original Part Number | Replaced By | Status | Part Description |
|------|-------------------------|--------------------------|---------------|--------------------------------|
| 1 | 53-0131 | LA-1054 | | Dryer Bulkhead Kit |
| " | 25-7733 | 681414 | | Screw, 10AB X 1/2 |
| 2 | 53-0282 | 31001637 | | Seal Assembly, Cylinder Front |
| 3 | 53-0178 | 53-1250 | | Cylinder |
| 4 | 25-7759 | 3196164 | | Screw |
| " | 53-0117 | | Not Available | BAFFLE, GRAY |
| 5 | 53-1080 | 341241 | | Belt |
| 6 | 25-3457 | | | Screw, Sems |
| " | 53-1580 | | | Receptacle Assembly |
| 7 | 53-0570 | A3167501 | | Lamp Oven, Int. |
| 8 | 53-0174 | | | Lens, Bulb |
| 9 | 25-3562 | 3195558 | | Nut |
| 10 | 53-0197 | | | Support Assembly-Cylinder Rear |
| " | 25-7101 | 3351614 | | Screw, Gearcase Cover Mounting |
| 11 | 53-0642 | 31001096 | | Roller |

| | | |
|----|-------------------------|-----------------|
| 12 | 25-7813 | Spacer |
| 13 | 25-7814 | Washer |
| 14 | LA-1008 | Rr Roller Kit |
| " | 25-7854 | Ring, Retaining |

