

# Maytag 3RATW3005TQ0 04 - BRAKE, CLUTCH, GEARCASE, MOTOR AND PUMP PARTS

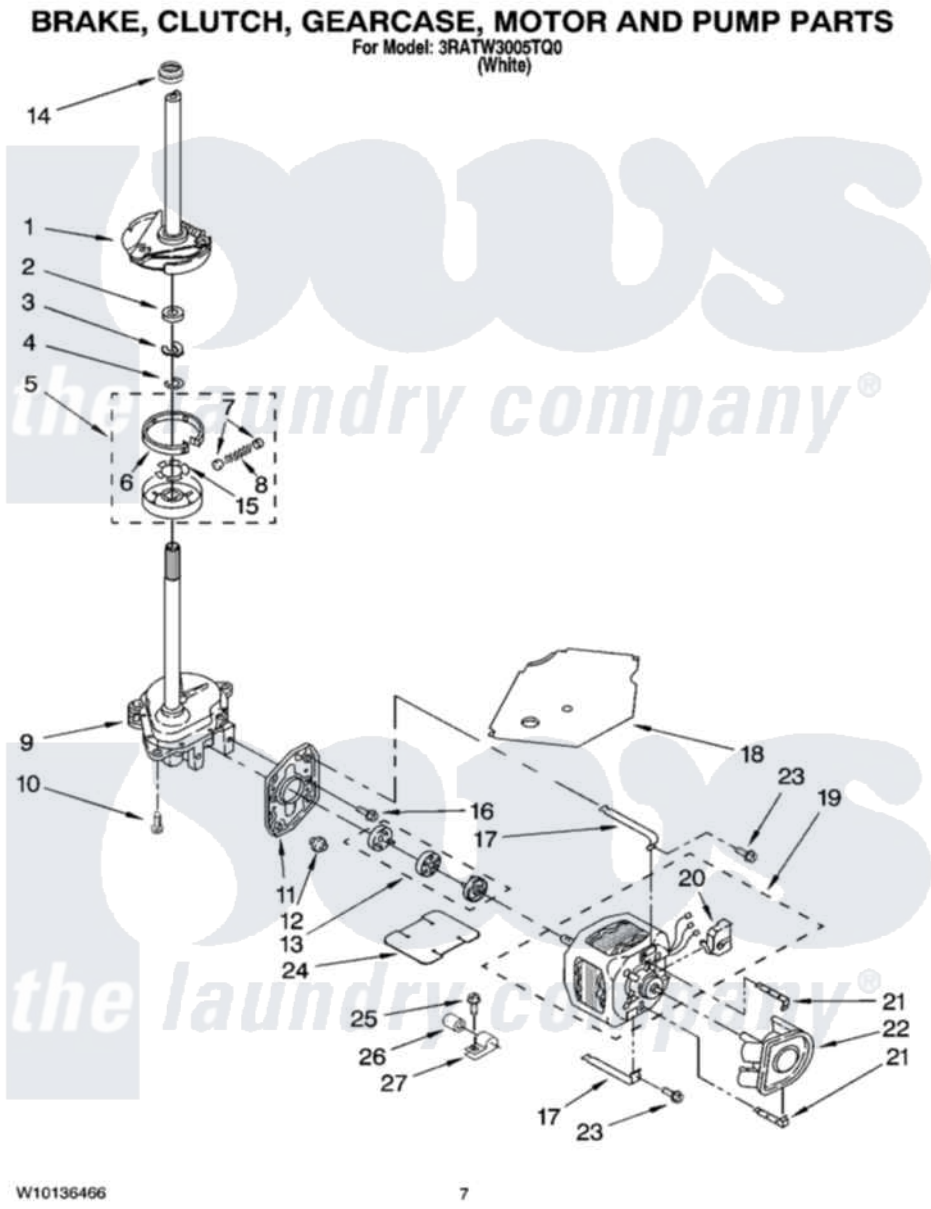

Maytag [Residential Maytag 3RATW3005TQ0 Washer Parts](#) Parts Diagram 04 - BRAKE, CLUTCH, GEARCASE, MOTOR AND PUMP PARTS  
Click on the part number to view part

Item	Original Part Number	Replaced By	Status	Part Description
1	<a href="#">W10117003</a>			Brake And Drive Tube
2	<a href="#">63292</a>			Washer, Spin Tube Thrust
3	<a href="#">W10080230</a>			Ring, Spin Tube Support
4	63283	<a href="#">285353</a>		Ring
5	<a href="#">W10116968</a>			Clutch
6	<a href="#">W10118761</a>			Band And Lining, Clutch
7	<a href="#">62646</a>			Cap, Clutch Spring
8	<a href="#">3946792</a>			Spring And Damper Assembly
9	W10116916	<a href="#">W10140308</a>		Gearcase
10	W10080600	<a href="#">W10080610</a>		Screw
11	<a href="#">62611</a>			Plate, Motor Mount To Gearcase
12	<a href="#">62691</a>			Grommet, Motor
13	3364003	<a href="#">285753A</a>		Coupling
14	<a href="#">8577374</a>			Seal, Centerpost

15	<a href="#">3355454</a>		Clip, Main Drive
16	<a href="#">W10080610</a>		Screw
17	<a href="#">W10086010</a>		Retainer, Motor
18	<a href="#">3362089</a>		Shield, Tub To Motor
19	<a href="#">3950297</a>		Motor, Main Drive
20	<a href="#">8529896</a>		Switch, Main Drive Motor
21	<a href="#">8546127</a>		Retainer, Pump
22	<a href="#">3363394</a>		Pump
23	W10080650	<a href="#">273556</a>	Screw, 10-16 X 5/8
24	<a href="#">8316060</a>		Shield, Tub To Motor
25	<a href="#">W10080260</a>		Screw, 10-16 X 5/16
26	8572719	<a href="#">482156</a>	Capacitor
27	<a href="#">W10083210</a>		Clamp, Capacitor

*the laundry company*<sup>®</sup>

*the laundry company*<sup>®</sup>

*the laundry company*<sup>®</sup>