

**Maytag 7MNTM5100TQ0 08 - GEARCASE PARTS, OPTIONAL PARTS  
(NOT INCLUDED)**

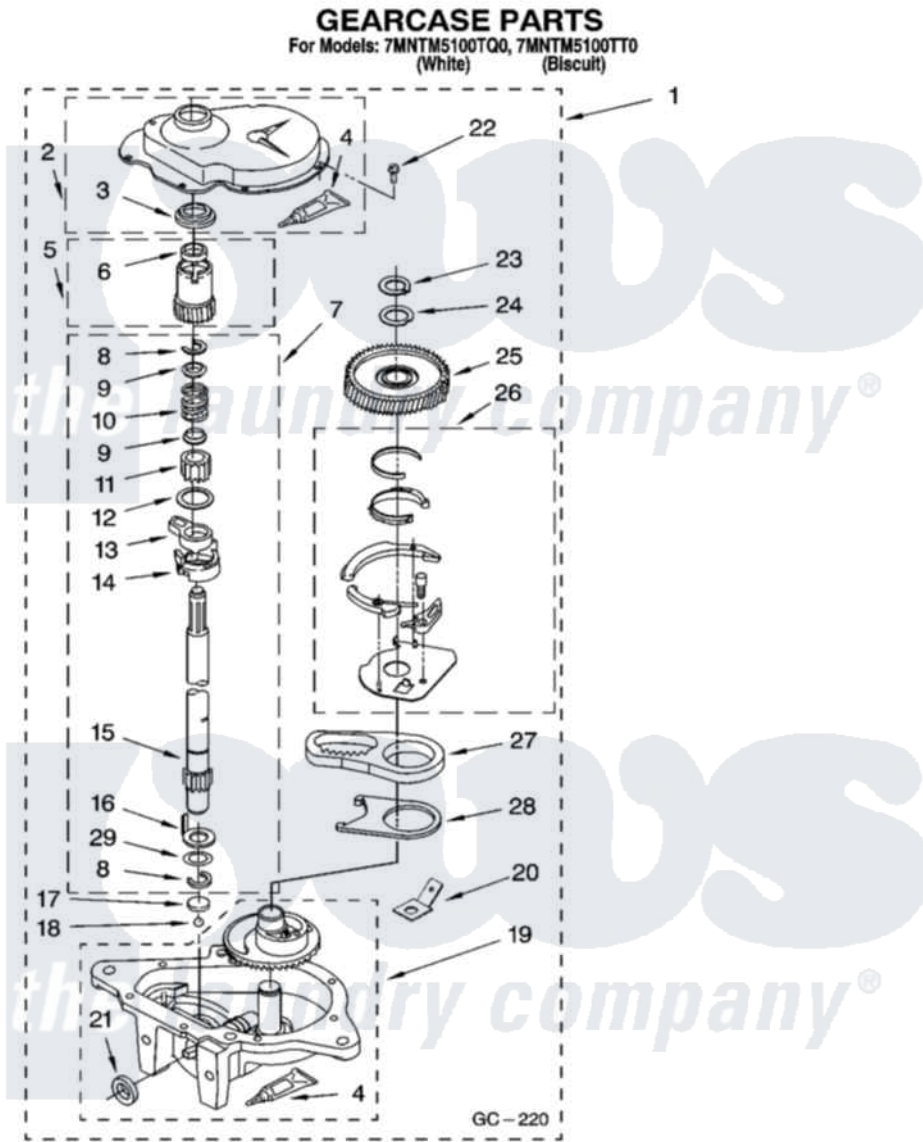

12

W10153364

Maytag Residential Maytag 7MNTM5100TQ0 Washer Parts Parts Diagram 08 - GEARCASE PARTS, OPTIONAL PARTS (NOT INCLUDED)

Click on the part number to view part

| Item | Original Part Number    | Replaced By             | Status        | Part Description      |
|------|-------------------------|-------------------------|---------------|-----------------------|
| 1    | 8532118                 | <a href="#">3360629</a> |               | Gearcase              |
| 2    | <a href="#">285202</a>  |                         |               | Cover, Gearcase       |
| 3    | <a href="#">3349985</a> |                         |               | Seal, Gearcase Cover  |
| 4    | <a href="#">285195</a>  |                         |               | Sealer Sealer, Gasket |
| 5    | 63320                   | <a href="#">285362</a>  |               | Gear and Pinion       |
| 6    | <a href="#">356427</a>  |                         |               | Seal, Spin Pinion     |
| 7    | <a href="#">389387</a>  |                         |               | Shaft, Agitator       |
| 8    | 90369                   |                         | Not Available | Ring, Retaining (2)   |
| 9    | <a href="#">62677</a>   |                         |               | Retainer, Spring      |
| 10   | <a href="#">62676</a>   |                         |               | Spring, Agitator      |
| 11   | 63273                   | <a href="#">285509</a>  |               | Shaft, Agitator       |
| 12   | <a href="#">62619</a>   |                         |               | Washer, Agitator Gear |
| 13   | 62580                   | <a href="#">285206</a>  |               | Cam-Agitator          |
| 14   | 62581                   | <a href="#">285206</a>  |               | Cam-Agitator          |
| 15   | <a href="#">285509</a>  |                         |               | Shaft, Agitator       |

|    |                           |                         |                                                                                                                    |
|----|---------------------------|-------------------------|--------------------------------------------------------------------------------------------------------------------|
| 16 | <a href="#">62618</a>     |                         | Washer, Cam Thrust                                                                                                 |
| 17 | 16018                     | <a href="#">285205</a>  | Bearing                                                                                                            |
| 18 | 85529                     | <a href="#">285205</a>  | Bearing                                                                                                            |
| 19 | 389230                    | <a href="#">285515</a>  | Gearcase                                                                                                           |
| 20 | 3949116                   | Not Available           | BLOCK TAB, TERMINAL                                                                                                |
| 21 | <a href="#">285352</a>    |                         | Seal Kit, Thrust Plug                                                                                              |
| 22 | <a href="#">3351614</a>   |                         | Screw, Gearcase Cover Mounting                                                                                     |
| 23 | 3362552                   | <a href="#">285765</a>  | Ring-Retrn                                                                                                         |
| 24 | 285735                    | <a href="#">285766</a>  | Washer Kit, Thrust                                                                                                 |
| 25 | 62570                     | <a href="#">285362</a>  | Gear and Pinon                                                                                                     |
| 26 | 388253                    | <a href="#">999516</a>  | Shelf-Glas                                                                                                         |
| 27 | 3349296                   | <a href="#">8546456</a> | Rack, Connecting                                                                                                   |
| 28 | <a href="#">62621</a>     |                         | Actuator, Shift                                                                                                    |
| 29 | <a href="#">388815</a>    |                         | Washer, Intermediate 1<br>3976263 Miscellaneous Parts<br>Bag 2 3976300 Washer, Inlet<br>Hose 3 3366913 Clamp, Hose |
| NI | <a href="#">72017</a>     |                         | Paint, Touch-Up                                                                                                    |
| "  | <a href="#">4392899</a>   |                         | Paint, Touch-Up                                                                                                    |
| "  | <a href="#">350938</a>    |                         | Paint, Pressurized Spray B                                                                                         |
| "  | <a href="#">350930</a>    |                         | Paint, Pressurized Spray B                                                                                         |
| "  | <a href="#">4392901</a>   |                         | Paint, Pressurized Spray                                                                                           |
| "  | <a href="#">799344</a>    |                         | Paint, Touch-Up )                                                                                                  |
| "  | <a href="#">4392900</a>   |                         | Paint, Bulk )                                                                                                      |
| "  |                           | Not Available           |                                                                                                                    |
| "  | <a href="#">350572</a>    |                         | Oil                                                                                                                |
| "  |                           | Not Available           |                                                                                                                    |
| "  | <a href="#">285208</a>    |                         | Lubricant                                                                                                          |
| "  | <a href="#">W10340308</a> |                         | Control-Elec                                                                                                       |
| "  | <a href="#">285195</a>    |                         | Sealer Sealer, Gasket                                                                                              |
| "  |                           | Not Available           |                                                                                                                    |
| "  | <a href="#">63580</a>     |                         | Dispenser, Fabric Softener                                                                                         |
| "  | <a href="#">367031</a>    |                         | Water System Parts                                                                                                 |
| "  | 280129                    | <a href="#">280129A</a> | Break-Sphn                                                                                                         |
| "  | 280130                    | <a href="#">280130A</a> | Adapter                                                                                                            |
| "  | 280131                    | <a href="#">40922</a>   | Hose                                                                                                               |

