

# Maytag A17CA 05 - TRANSMISSION

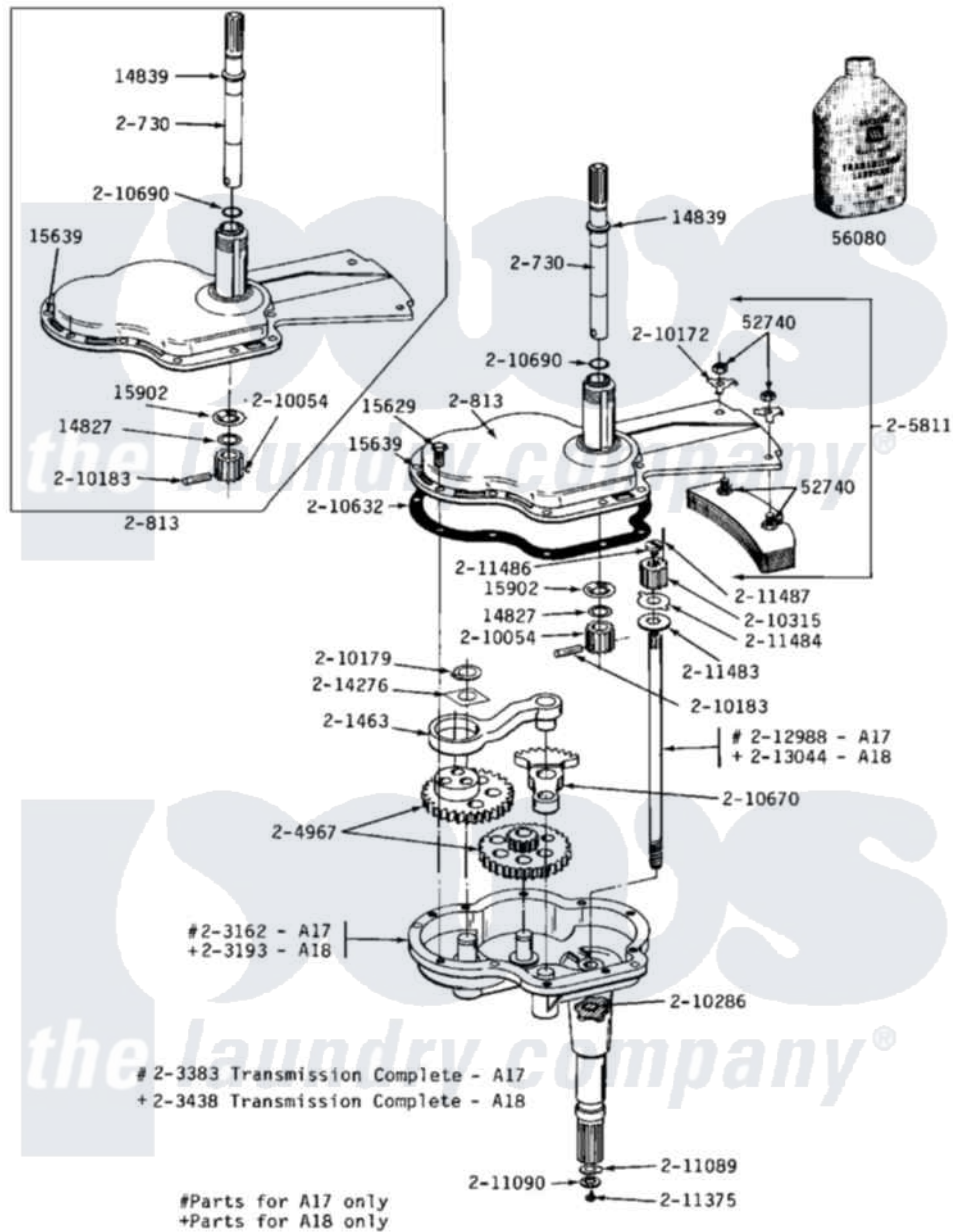

Maytag [Residential Maytag A17CA Washer Parts](#) Parts Diagram 05 - TRANSMISSION  
 Click on the part number to view part

Item	Original Part Number	Replaced By	Status	Part Description
001	<a href="#">Y014827</a>			Washer-Center Shaft
002	<a href="#">Y014839</a>			Collar-Drive Shaft
003	<a href="#">Y015629</a>			Bolt, Grinding Chamber
004	NLA		Not Available	DOWEL PIN
005	<a href="#">Y015902</a>			Spring For Agitator
006	Y052740	<a href="#">62739</a>		Nut, Lock
007	Y056080	<a href="#">6-0560800</a>		Oil
008	200730	<a href="#">22002124</a>		Shaft- Agi
009	NLA		Not Available	GEAR CASE COVER ASSEMBLY
010	NLA		Not Available	PITMAN WITH WRIST PIN
011	NLA		Not Available	GEAR HOUSING W/STUDS & TUBE
012	203383	<a href="#">W10172458</a>		Transmison
013	<a href="#">204967</a>			Gear Kit-Power Fin Agitator
014	NLA		Not Available	COUNTERWEIGHT
015	<a href="#">210054</a>			Pinion

016	NLA		Not Available	LOCK WASHER
017	NLA		Not Available	RETAINING RING
018	<a href="#">210183</a>			Groove Pin
019	<a href="#">210286</a>			Seal
020	<a href="#">210315</a>			Pinion
021	210632	<a href="#">22210632</a>		Gasket
022	NLA		Not Available	SEGMENT
023	<a href="#">210690</a>			Seal, Rubber
024	<a href="#">211089</a>			Lug, Stop Pulley
025	211090	<a href="#">22003555</a>		Washer, Stop Lug
026	211375	<a href="#">681582</a>		Screw
027	211483	<a href="#">6-2114830</a>		Washer- SP
028	<a href="#">211484</a>			Washer, Lug
029	<a href="#">211486</a>			Screw, 3/8-16 X 1/2 Inch
030	NLA		Not Available	GROOV-PIN
031	<a href="#">212988</a>			Part Not Used
032	NLA		Not Available	WASHER FOR GEARS

