

Maytag A212S 08 - TOP COVER, CONSOLE & LID SWITCH (SER 11)

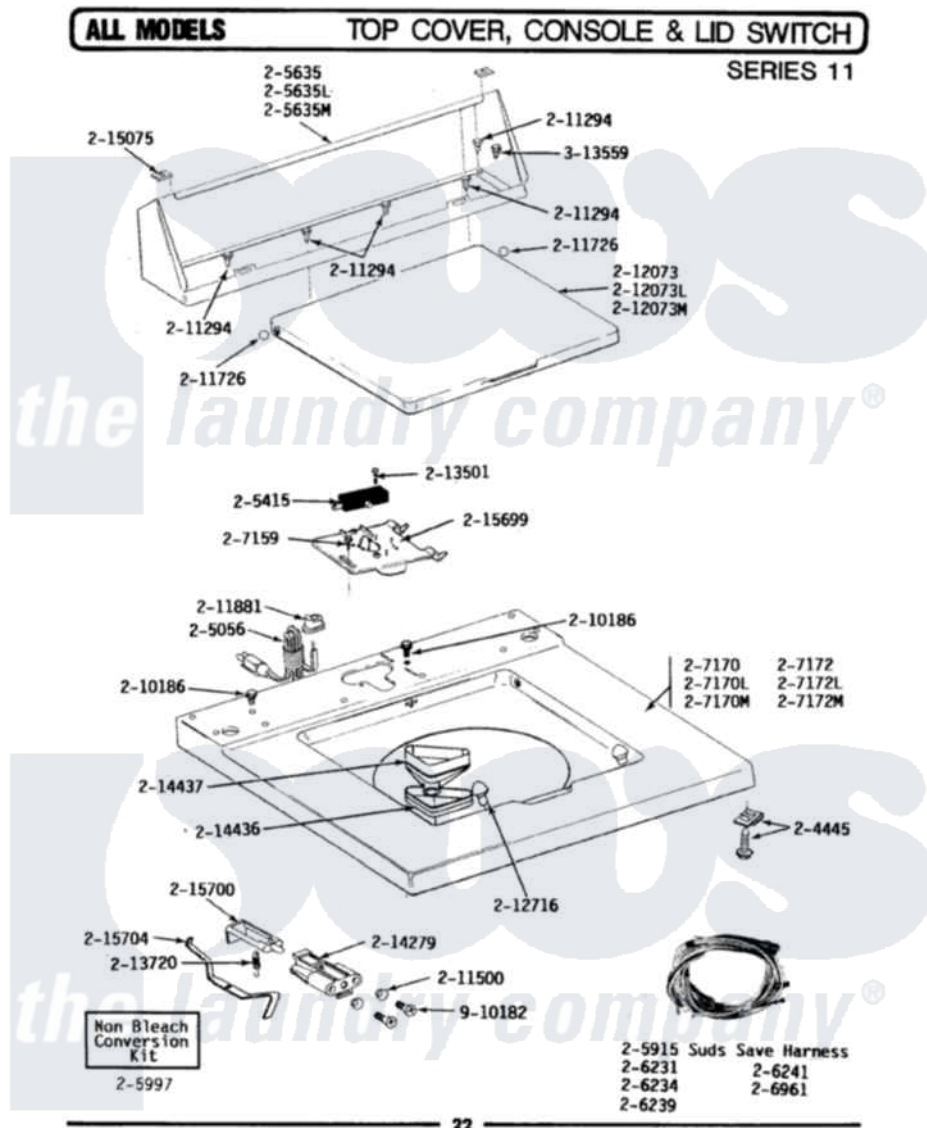

Maytag Residential Maytag A212S Washer Parts Parts Diagram 08 - TOP COVER, CONSOLE & LID SWITCH (SER 11)
 Click on the part number to view part

Item	Original Part Number	Replaced By	Status	Part Description
NI	Y201808			Converter
2	204445			Screw And Fastener Assembly
NI	204968			Plunger And Bracket Assembly--W
4	205056	204590		Cord, Power
5	205415	279347		Switch-Lid
6	205635			Console
8	205915		Not Available	SUDS SAVE HARNESS
9	205997			Non-Bleach Conversion Kit
10	206231			Wire Harness
11	207159	489355		Screw, 8 X 1/2
12	207170			Top Cover
14	207172			Top Cover
17	210186	3370225		Screw
18	211294	90767		Screw, 8A X 3/8 HeX Washer Head Tapping
19	211500			Washer, Bracket To Top Cover

20	211726		Hinge, Ball Lid
NI	211737	248562	Terminal
24	211881		Grommet, Cord Part Not Used- Gas Models Only
25	212073		LID (WHITE)
27	212716		Bumper, Lid
28	213501		Screw, No.6-20 X 1-1/8 Inch
NI	213718		Plunger, Lid Switch
30	213720		Spring, Lid Switch
31	214279	204968	Plunger And Bracket Assembly--W
32	214436		Gasket
NI	214805		Pin For Unbalance Lever
"	214813	Not Available	LEVER FOR LID SWITCH
"	214898		Cover For Lid Switch
"	214987		Moisture Barrier For Switch
37	215075		Fastener, Control Panel To Console
NI	215236	214804	Unbalance Lever
"	215577		Bleach Inlet White
"	215579	215580	Cup, Bleach
43	Y215699	22001678	Bracket, Switch And Fuse
44	215700	Not Available	LID SWITCH PLUNGER
45	215704		Lever, Unbalance
NI	301548		Clamp, Ground Wire
"	311155		Ground Wire And Clamp
48	Y312140		Wire Connector
"	Y313559		Screw
NI	410635		Fastener
50	910182	25-7809	Screw, No.6-20 1/2 Flthd Torx
NI	911267		Screw, Pump Cover

