

MODELS A105-A283-A284 **TRANSMISSION**
PRIOR TO SERIES 10

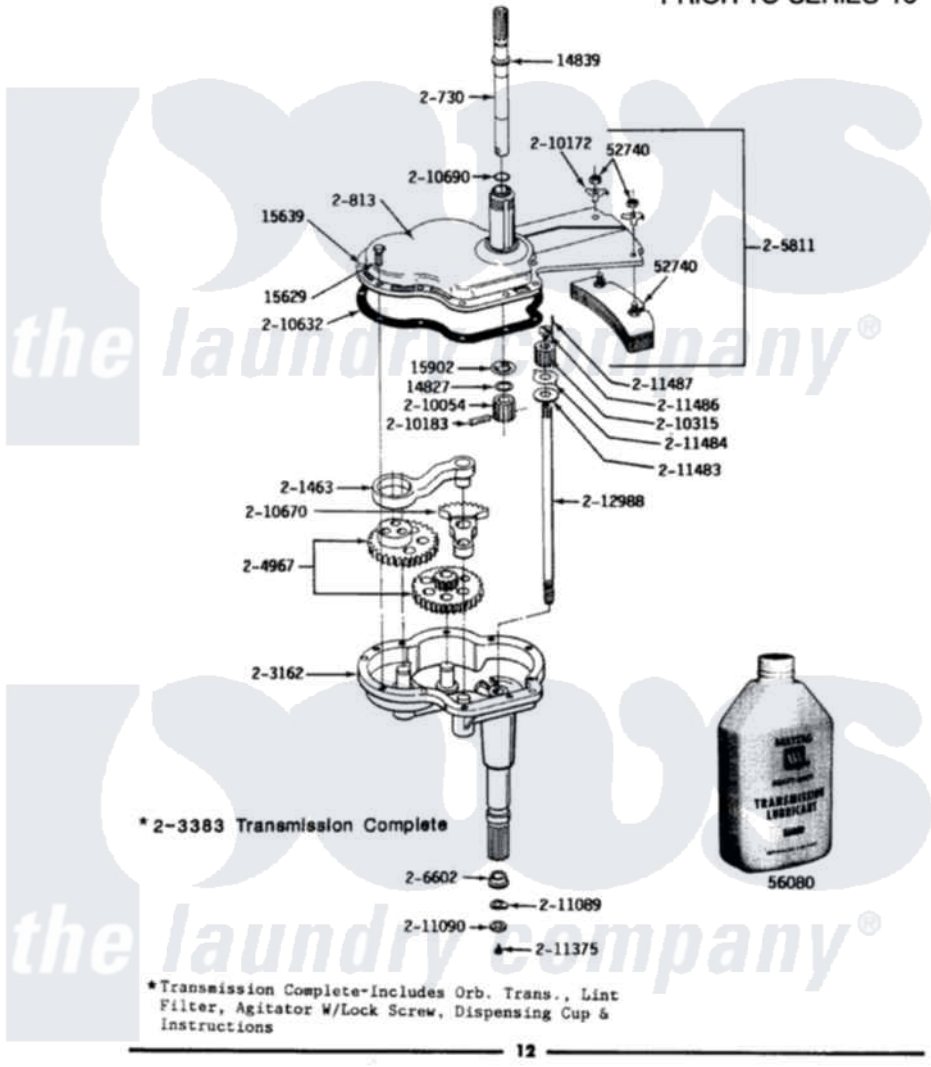

Maytag Residential Maytag A283 Washer Parts Parts Diagram 08 - TRANSMISSION
Click on the part number to view part

Item	Original Part Number	Replaced By	Status	Part Description
1	Y014827			Washer-Center Shaft
2	Y014839			Collar-Drive Shaft
NI	Y015629			Bolt, Grinding Chamber
4	Y015629			Bolt, Grinding Chamber
5	015639			Dowel Pin
6	Y015902			Spring For Agitator
7	Y052740	62739		Nut, Lock
8	Y056080	6-0560800		Oil
9	200730	22002124		Shaft- Agi
10	200813		Not Available	GEAR CASE COVER ASSEMBLY
11	201463		Not Available	PITMAN WITH WRIST PIN
12	203162			Gear Housing W/Studs And Tube
13	203383	W10172458		Transmison
14	204967			Gear Kit-Power Fin Agitator
15	205811			Counterweight

16	206602	207843	Lip Seal Repair Kit
17	210054		Pinion
18	210172		Lock Washer
19	210183		Groove Pin
NI	210286		Seal
21	210315		Pinion
22	210632	22210632	Gasket
23	210670		Segment
24	210690		Seal, Rubber
25	211089		Lug, Stop Pulley
26	211090	22003555	Washer, Stop Lug
27	211375	681582	Screw
28	211483	6-2114830	Washer- SP
29	211484		Washer, Lug
30	211486		Screw, 3/8-16 X 1/2 Inch
31	211487		Groov-Pin
32	212988		Part Not Used

