

Maytag A612 08 - TOP COVER, CONSOLE & LID SWITCH (SER 11)

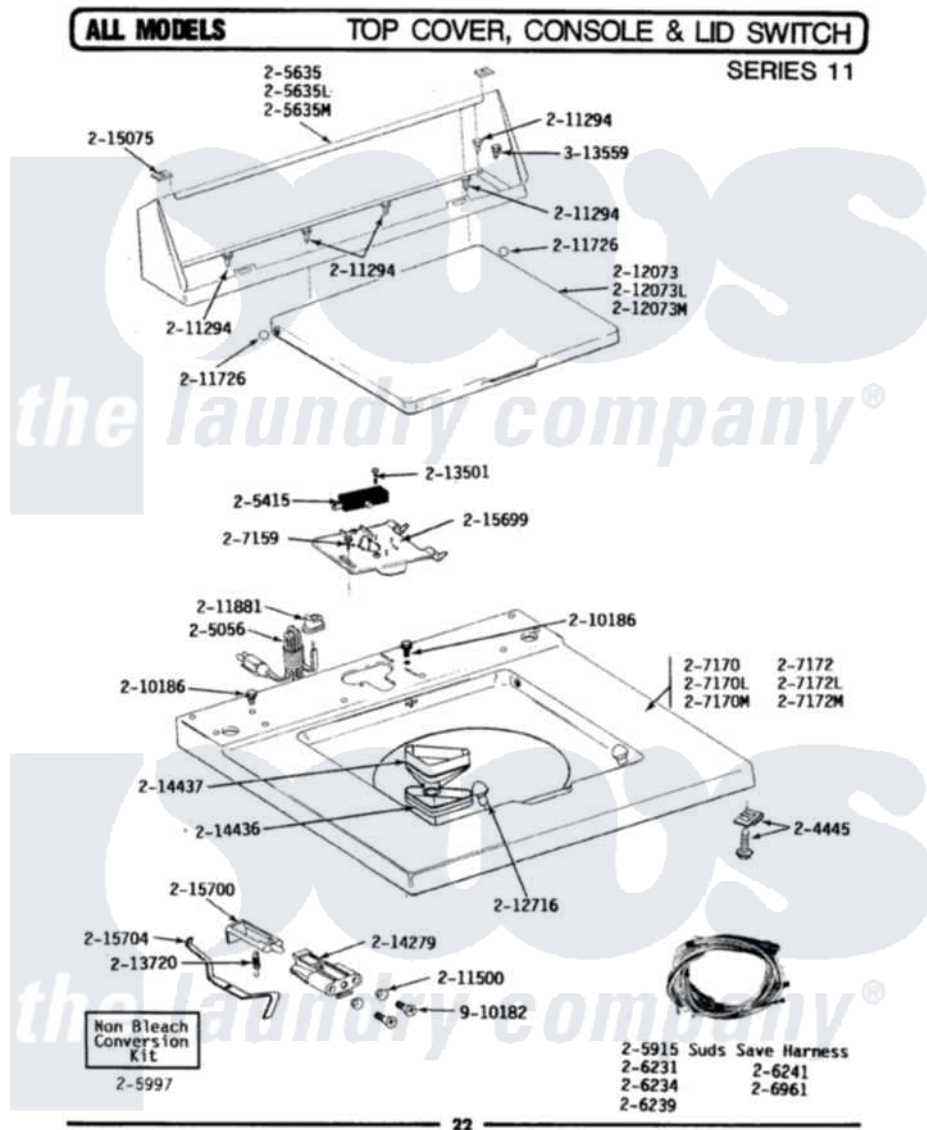

Maytag Residential Maytag A612 Washer Parts Parts Diagram 08 - TOP COVER, CONSOLE & LID SWITCH (SER 11)
 Click on the part number to view part

Item	Original Part Number	Replaced By	Status	Part Description
NI	Y201808			Converter
2	204445			Screw And Fastener Assembly
NI	204968			Plunger And Bracket Assembly--W
4	205056	204590		Cord, Power
5	205415	279347		Switch-Lid
6	205635			Console
9	205997			Non-Bleach Conversion Kit
10	206231			Wire Harness
11	207159	489355		Screw, 8 X 1/2
12	207170			Top Cover
14	207172			Top Cover
17	210186	3370225		Screw
18	211294	90767		Screw, 8A X 3/8 HeX Washer Head Tapping
19	211500			Washer, Bracket To Top Cover
20	211726			Hinge, Ball Lid

NI	211737	248562	Terminal
24	211881		Grommet, Cord Part Not Used-Gas Models Only
25	212073		LID (WHITE)
27	212716		Bumper, Lid
28	213501		Screw, No.6-20 X 1-1/8 Inch
NI	213718		Plunger, Lid Switch
30	213720		Spring, Lid Switch
31	214279	204968	Plunger And Bracket Assembly--W
32	214436		Gasket
NI	214805		Pin For Unbalance Lever
"	214813	Not Available	LEVER FOR LID SWITCH
"	214898		Cover For Lid Switch
"	214987		Moisture Barrier For Switch
37	215075		Fastener, Control Panel To Console
NI	215236	214804	Unbalance Lever
"	215577		Bleach Inlet White
"	215579	215580	Cup, Bleach
43	Y215699	22001678	Bracket, Switch And Fuse
44	215700	Not Available	LID SWITCH PLUNGER
45	215704		Lever, Unbalance
NI	301548		Clamp, Ground Wire
47	311155		Ground Wire And Clamp
48	Y312140		Wire Connector
"	Y313559		Screw
NI	410635		Fastener
50	910182	25-7809	Screw, No.6-20 1/2 Flthd Torx
NI	911267		Screw, Pump Cover

