

# Maytag DE9700 07 - LINT SCREEN, TUMBLER (FRONT & BACK)

SECTION: LINT SCREEN, TUMBLER, TUMBLER FRONT & BACK  
 MODEL: DE-DG MODELS

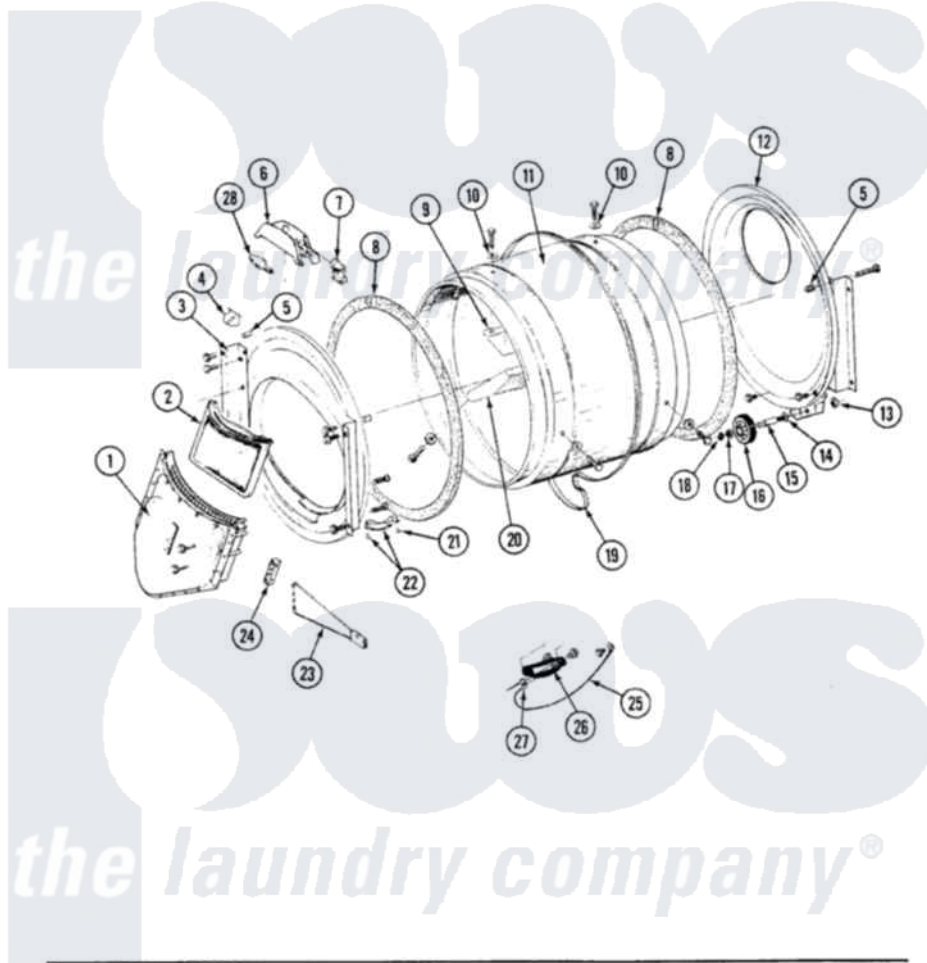

Issue Date: 6/90

44

Maytag Residential Maytag DE9700 Dryer Parts Parts Diagram 07 - LINT SCREEN, TUMBLER (FRONT & BACK)  
 Click on the part number to view part

Item	Original Part Number	Replaced By	Status	Part Description
1	Y307112	<a href="#">33001016</a>		Outlet Duct Assembly
"	Y314110	<a href="#">33002917</a>		Screw, No.10-16
2	Y307107	<a href="#">33002970</a>		Lint Filte
3	Y310632	<a href="#">1163839</a>		Screw
"	313764		Not Available	SCREW
"	<a href="#">Y313561</a>			Screw----NA
"	307311	<a href="#">33001179</a>		Front, Tumbler
4	<a href="#">Y310376</a>			Clip, Door Switch Harness
5	313915	<a href="#">31-3915</a>		Tech Sheet
8	<a href="#">314820</a>			Seal, Tumbler
9	<a href="#">Y310759</a>			Screw, Tumbler Baffles
"	314803	<a href="#">33001012</a>		Baffle
10	<a href="#">314158</a>			Washer, Baffle To Tumbler
11	306663		Not Available	TUMBLER W/BAFFLES
"	314802		Not Available	TUMBLER W/OUT BAFFLES
12	Y307114	<a href="#">33001178</a>		Back, Tumbler

"	211294	<a href="#">90767</a>	Screw, 8A X 3/8 HeX Washer Head Tapping
13	312538	<a href="#">33001443</a>	Nut, Hex
14	Y313347	<a href="#">312535</a>	Washer, Vault Mounting Brk.
15	Y312948	<a href="#">6-3129480</a>	Shaft- Tumbler
16	Y303373	<a href="#">12001541</a>	Drum Roller/Washer Assembly--W
17	<a href="#">312535</a>		Washer, Vault Mounting Brk.
18	410233	<a href="#">9703438</a>	Ring-Retrn
19	<a href="#">Y312959</a>		Poly "V" Belt For Tumbler
20	314804	<a href="#">33001004</a>	Baffle, Tall
"	<a href="#">Y310759</a>		Screw, Tumbler Baffles
21	<a href="#">210720</a>		Rivet, Bearing To Tumbler Fmt
22	<a href="#">306508</a>		Tumbler Bearing Kit ----W
25	211294	<a href="#">90767</a>	Screw, 8A X 3/8 HeX Washer Head Tapping
"	<a href="#">Y303711</a>		Sensor Ground Wire
26	<a href="#">304997</a>		Sensor Assembly With Screws
"	Y251119	<a href="#">3177991</a>	Screw
27	<a href="#">Y312658</a>		Receptacle, Sensor Ground Wire

