

Maytag DG26CS 10 - INLET DUCT, GAS VALVE, CONE & EXTENSION

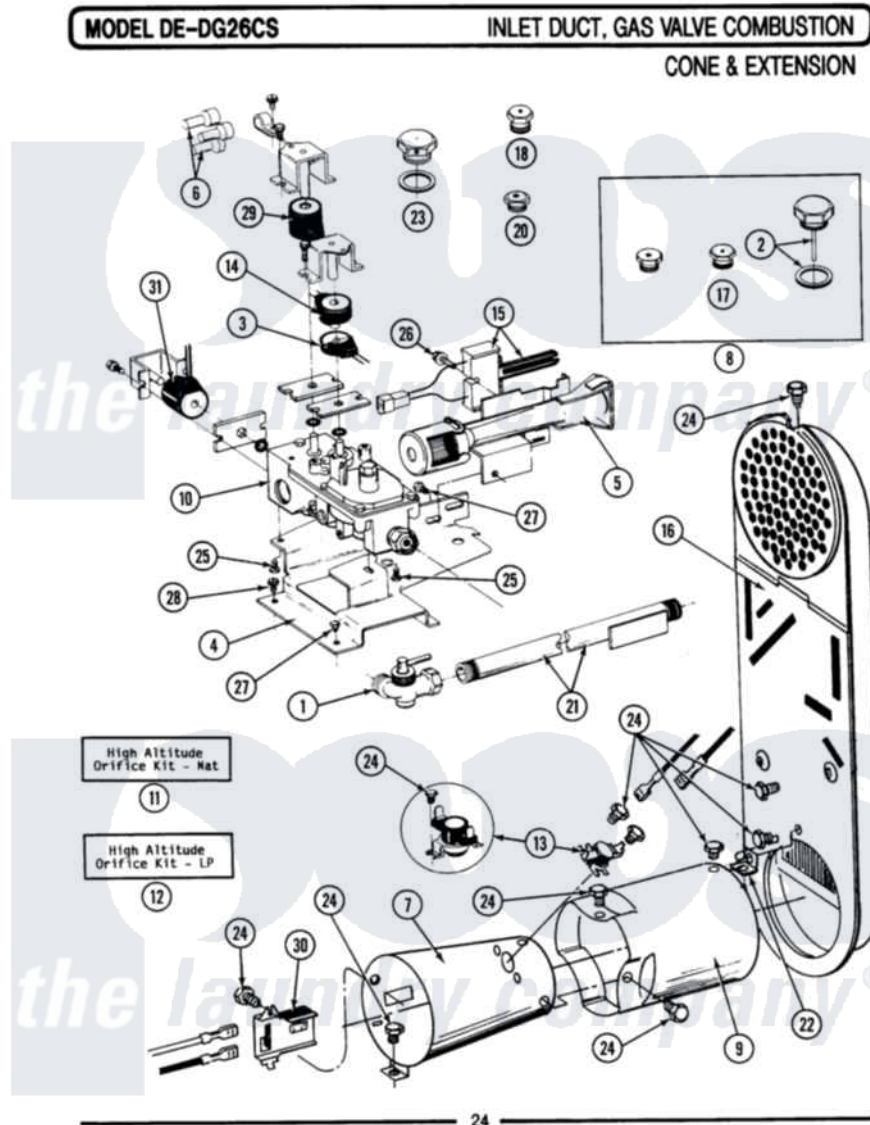

Maytag Residential Maytag DG26CS Dryer Parts Parts Diagram 10 - INLET DUCT, GAS VALVE, CONE & EXTENSION
Click on the part number to view part

Item	Original Part Number	Replaced By	Status	Part Description
001	Y303349			Angle Shut-Off, Gas Valve
002	NLA		Not Available	SCREW ASSY - BLUE BLOCK OPE
003	305605			Booster Coil
004	312929			Gas Valve Bracket
005	304974	33002793		Burner Assembly
006	311546	911445		Wire Connector
007	Y303368			Cone, Combustion
"	Y308548			Combustion Cone Assembly
008	Y303779			Conversion Kit
009	Y303841			Cone, Extension
010	Y303777	W10116794		Gas Valve
011	NLA		Not Available	WIRE
012	NLA		Not Available	ORIFICE KIT, LP (HIGH ALT.)
013	305169			Thermostat, Hi-Limit Gas
014	305604			Holding Coil
015	304970	4391996		Ignitor

016	307119		Duct, Inlet Assembly
017	NLA	Not Available	INTERNAL ORIFICE (LP)
018	313367		Main Burner Orifice-Int-NAT
019	NLA	Not Available	MAIN BURNER ORIFICE (LP)
020	313366		Main Burner Orifice-Ext-NAT
021	Y303383	33001735	Pipe And Bracket Assembly Series 18 Not Needed Use Vavle
022	Y312890		Retainer, Heater Chamber
023	NLA	Not Available	SCREW ASSEMBLY, LEAK LIMIT
024	211294	90767	Screw, 8A X 3/8 HeX Washer Head Tapping
025	NLA	Not Available	SCREW, HEX HD No.8 X 3/8 INCH
026	304971		Screw Note: Screw, Igniter
027	Y310632	1163839	Screw
028	Y313561		Screw---NA
029	305603		Secondary Coil
030	Y303377	338906	Radiant, Sensor
031	Y304626		Side Coil

