

Maytag DG50PN1 07 - FRONT PANEL ASSY. (LATCH TYPE-DG30/50)

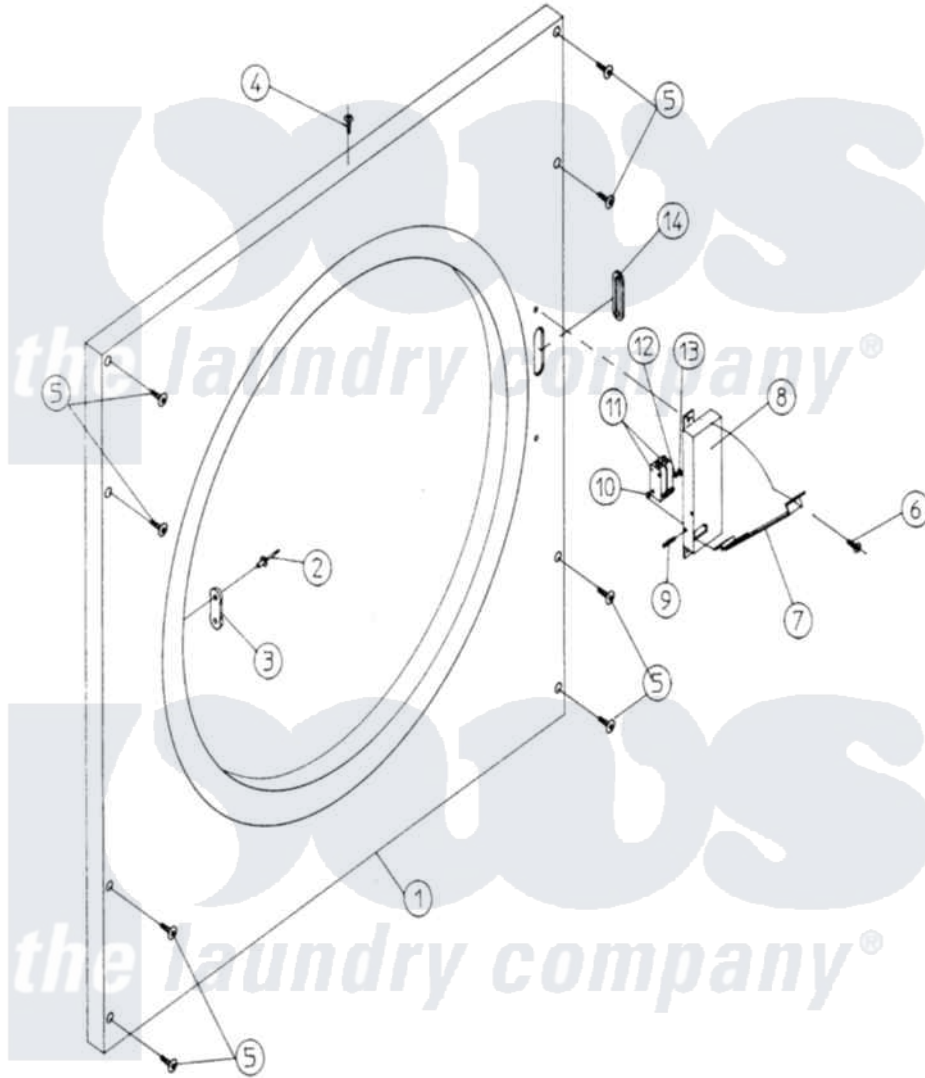

Maytag Residential Maytag DG50PN1 Dryer Parts Parts Diagram 07 - FRONT PANEL ASSY. (LATCH TYPE-DG30/50)  
 Click on the part number to view part

| Item | Original Part Number | Replaced By                | Status        | Part Description  |
|------|----------------------|----------------------------|---------------|---|
| 000  | W10124350            |                            | Not Available | ORDER PARTS FROM AMERICAN DRYER CORP AT 508-678-9000        |
| 001  | A875300              | <a href="#">W10147918</a>  |               | 15-30- Ins  |
| "    | A875301              | <a href="#">W10147919</a>  |               | 25-50- Ins  |
| 002  | A152215              |                            | Not Available | RIVET, POP (1/8")   |
| 003  | A170330              |                            | Not Available | LATCH, DOOR (FRICTION)                                      |
| 004  | A150300              | <a href="#">5307527001</a> |               | Switch  |
| 005  | A150415              |                            | Not Available | SCREW, CRIMPTITE (PH. RD.HD.) (No.10-16 X 1/2" PH. RD. HD.) |
| 006  | A150301              | <a href="#">150301</a>     |               | 8-18 X 7  |
| 007  | A313215              | <a href="#">W10146843</a>  |               | DR SW Accu  |
| 008  | A313217              | <a href="#">W10146844</a>  |               | Main DR SW  |
| "    | A800445              | <a href="#">W10147060</a>  |               | Micro DR S  |
| "    | A800446              | <a href="#">800446</a>     |               | Micro DR S  |
| 009  | A150025              | <a href="#">150025</a>     |               | 4-40 X 1  |
| 010  | A153045              | <a href="#">153045</a>     |               | 4 Split L   |

|     |         |                         |            |
|-----|---------|-------------------------|------------|
| 011 | A137004 | <a href="#">137004</a>  | Ns Series  |
| 012 | A153045 | <a href="#">153045</a>  | 4 Split L  |
| 013 | A152016 | <a href="#">152016</a>  | 4-40 Hex N |
| 014 | A121405 | <a href="#">121405</a>  | Rubber Gro |
| "   | A404500 | <a href="#">WB22X55</a> | Switch     |
| "   | A404502 | <a href="#">404502</a>  | White 0.6  |

