

MODELS A105-A283-A284

TRANSMISSION
PRIOR TO SERIES 10

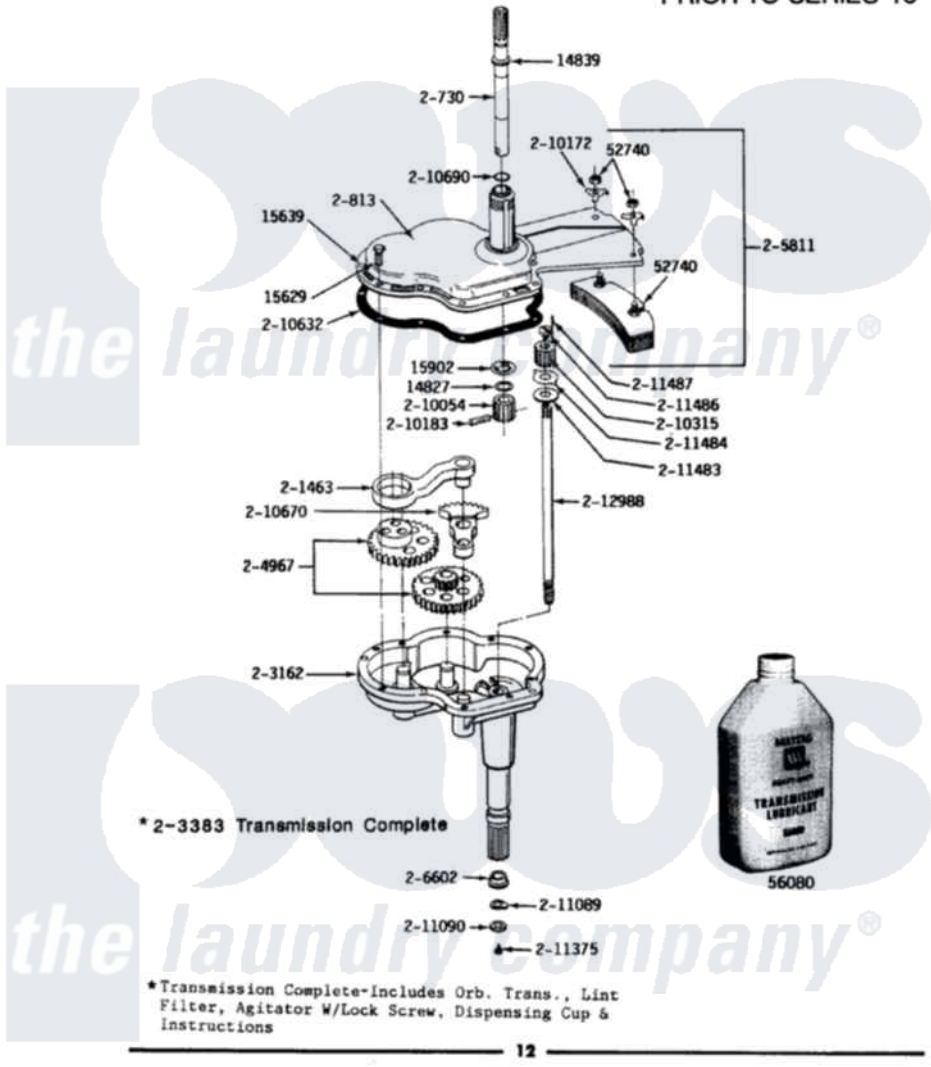

Maytag Residential Maytag GA284 Washer Parts Parts Diagram 08 - TRANSMISSION
Click on the part number to view part

Item	Original Part Number	Replaced By	Status	Part Description
1	Y014827			Washer-Center Shaft
2	Y014839			Collar-Drive Shaft
3	Y015629			Bolt, Grinding Chamber
4	015639			Dowel Pin
5	Y015902			Spring For Agitator
6	Y052740	62739		Nut, Lock
7	Y056080	6-0560800		Oil
8	200730	22002124		Shaft- Agi
9	200813		Not Available	GEAR CASE COVER ASSEMBLY
10	201463		Not Available	PITMAN WITH WRIST PIN
11	203162			Gear Housing W/Studs And Tube
12	203383	W10172458		Transmison
13	204967			Gear Kit-Power Fin Agitator
14	205811			Counterweight
15	206602	207843		Lip Seal Repair Kit

16	210054		Pinion
17	210172		Lock Washer
18	210183		Groove Pin
NI	210286		Seal
20	210315		Pinion
21	210632	22210632	Gasket
22	210670		Segment
23	210690		Seal, Rubber
24	211089		Lug, Stop Pulley
25	211090	22003555	Washer, Stop Lug
26	211375	681582	Screw
27	211483	6-2114830	Washer- SP
28	211484		Washer, Lug
29	211486		Screw, 3/8-16 X 1/2 Inch
30	211487		Groov-Pin
31	212988		Part Not Used

