

Maytag GA484 05 - MOTOR & PUMP ASSEMBLY

Section: MOTOR & PUMP ASSEMBLY

P/N 1600021

Models: ALL MODELS

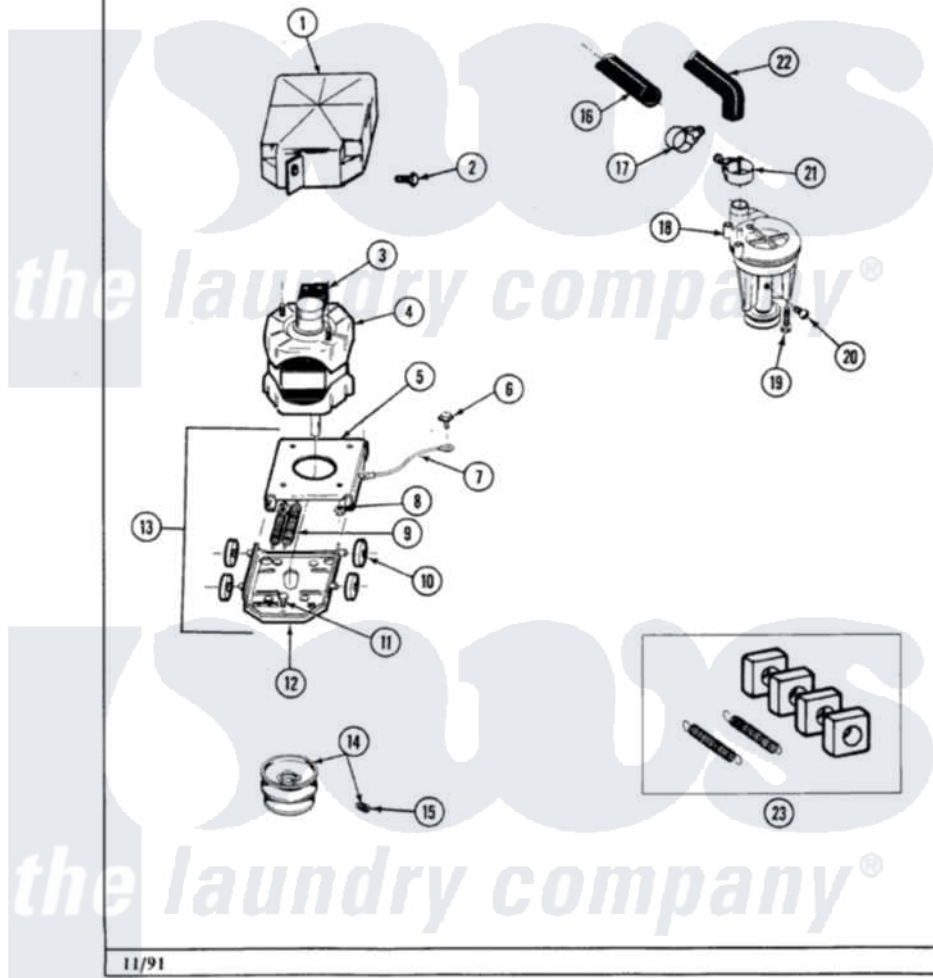

11/91

28

Maytag [Residential Maytag GA484 Washer Parts](#) Parts Diagram 05 - MOTOR & PUMP ASSEMBLY

[Click on the part number to view part](#)

Item	Original Part Number	Replaced By	Status	Part Description
1	215098			Shield, Motor
2	213121	3400111		Screw, 12-14 X 5/8
3	205134		Not Available	MOTOR EXTERNAL START SWITCH
"	205131			Switch, Motor External Start
"	205132		Not Available	SWITCH, MOTOR EXTERNAL START No.201664-14,205463-4 & 201800-4
"	205133		Not Available	(PROD. IDNo. 2-1664-8 & 2-5463)
"	206504			Motor External Start Switch
4	201805	12002351		Motor-Drve
5	214956			Motor Mount Assembly
6	210186	3370225		Screw
7	901220			Ground Wire
8	Y311426	3400029		Nut, Adapter Plate
9	202718			Springs, Tension
10	204998	205000		Roller And Spring Kit 4+Spr

11	Y313561		Screw---NA
12	205908		Motor Mount Assembly
13	205999		Motor Mount Assembly
14	200816	6-2008160	Pulley- MO
15	Y053241		Set Screw, Motor Pulley
16	214767	22001448	Hose, Pump
17	200461	285655	Clamp, Hose
18	202203	6-2022030	Pump As Pa
19	211880		Screw, HeX Head No.10 X 1/2 Inc
20	Y015408	22003235	Screw, Bearing Insert
21	202574	3367052	Clamp, Hose
22	213045		Hose, Outer Tub Part Not Used
23	205000		Roller And Spring Kit 4+Spr

