

Maytag GA8210 01 - BASE ASSEMBLY

SECTION: BASE ASSEMBLY
 MODEL: A8120 A8210

P/N 16000168

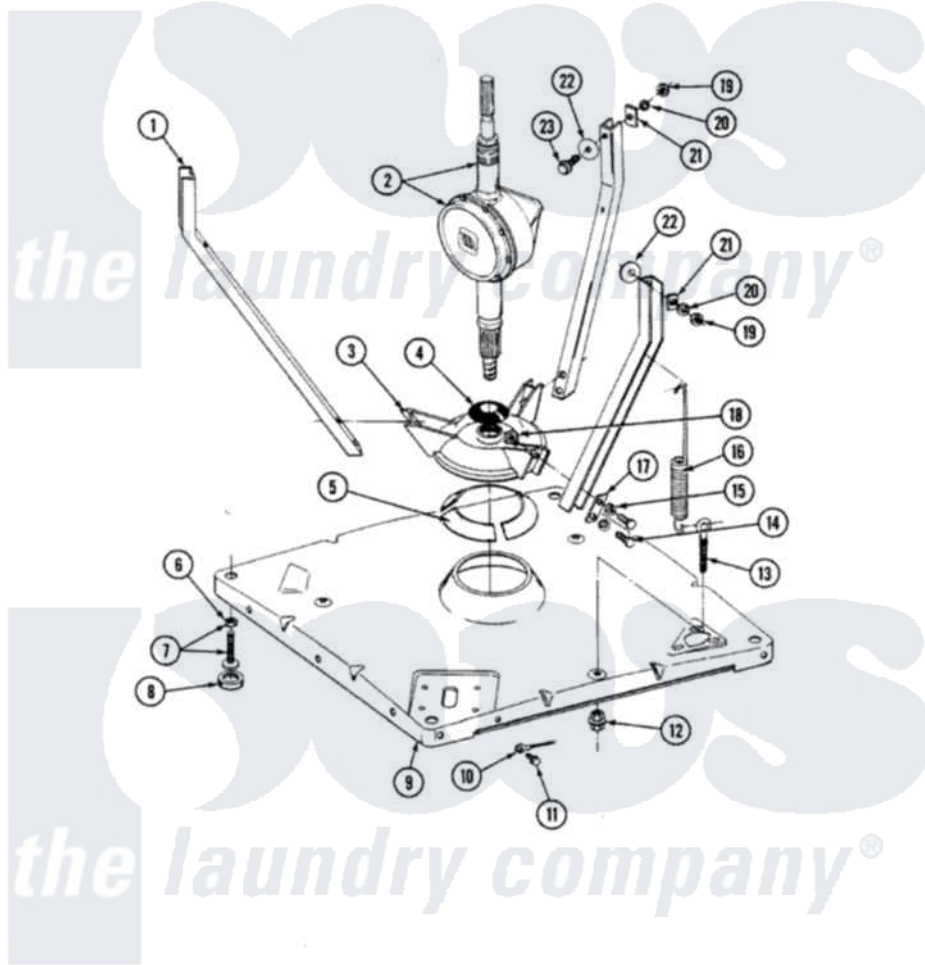

Issue Date: 5/91

16

Maytag [Residential Maytag GA8210 Washer Parts](#) Parts Diagram 01 - BASE ASSEMBLY
 Click on the part number to view part

Item	Original Part Number	Replaced By	Status	Part Description
1	213100		Not Available	PART NOT USED
2	206708	6-2097790		Transmison
3	203725			Damper W/Bolt And Clip
4	211028	22001586		Deflector, Water
5	203956			Damper Pad Kit
6	210385			Lock Nut For Adjustable Leg
7	Y302699	22003428		Leg, Adjustable
8	210684			Foot, Adjustable Leg
9	203274			Base With Damper Pads
10	204807			Ground Wire, Supp. Plte To Top Cover
11	210186	3370225		Screw
12	211949			Nut, Adjustment Eyebolt
13	213120	216416		Bolt, Eye/Centering Spring
14	Y015627			Screw- Hex
15	911852	486009		Lockwasher
16	213054			Centering Spring - 3 Used

17	213073		Washer, Double Brace
18	Y052785		Nut, Brace To Damper
19	Y052734		Nut, Carrage Bolts And Bracket
20	Y054867		Washer, Lock
21	212979	Not Available	WASHER, TUB BRACE
22	211100		Washer, Outer Tub
23	200744	W10175939	Bolt

