

Maytag GA884 05 - MOTOR & PUMP ASSEMBLY

Section: MOTOR & PUMP ASSEMBLY

P/N 1600021

Models: ALL MODELS

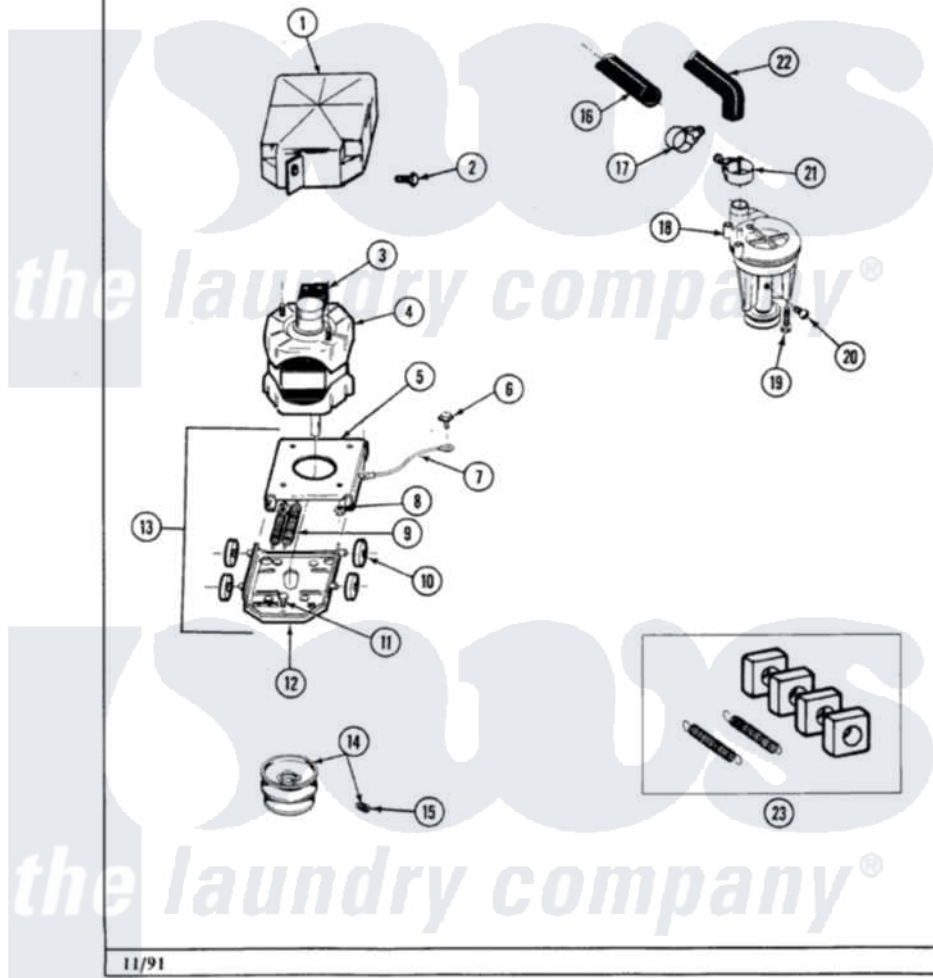

11/91

28

Maytag Residential Maytag GA884 Washer Parts Parts Diagram 05 - MOTOR & PUMP ASSEMBLY

Click on the part number to view part

| Item | Original Part Number | Replaced By | Status | Part Description |
|------|------------------------|--------------------------|---------------|---|
| 1 | 215098 | | | Shield, Motor |
| 2 | 213121 | 3400111 | | Screw, 12-14 X 5/8 |
| 3 | 205134 | | Not Available | MOTOR EXTERNAL START SWITCH |
| " | 205131 | | | Switch, Motor External Start |
| " | 205132 | | Not Available | SWITCH, MOTOR EXTERNAL START No.201664-14,205463-4 & 201800-4 |
| " | 205133 | | Not Available | (PROD. IDNo. 2-1664-8 & 2-5463) |
| " | 206504 | | | Motor External Start Switch |
| 4 | 201807 | 12002353 | | Motor-Drve |
| 5 | 214956 | | | Motor Mount Assembly |
| 6 | 210186 | 3370225 | | Screw |
| 7 | 901220 | | | Ground Wire |
| 8 | Y311426 | 3400029 | | Nut, Adapter Plate |
| 9 | 202718 | | | Springs, Tension |
| 10 | 204998 | 205000 | | Roller And Spring Kit 4+Spr |

| | | | |
|----|-------------------------|---------------------------|------------------------------------|
| 11 | Y313561 | | Screw---NA |
| 12 | 205908 | | Motor Mount Assembly |
| 13 | 205999 | | Motor Mount Assembly |
| 14 | 200816 | 6-2008160 | Pulley- MO |
| 15 | Y053241 | | Set Screw, Motor Pulley |
| 16 | 214767 | 22001448 | Hose, Pump |
| 17 | 200461 | 285655 | Clamp, Hose |
| 18 | 202203 | 6-2022030 | Pump As Pa |
| 19 | 211880 | | Screw, HeX Head No.10 X 1/2 Inc |
| 20 | Y015408 | 22003235 | Screw, Bearing Insert |
| 21 | 202574 | 3367052 | Clamp, Hose |
| 22 | 213045 | | Hose, Outer Tub Part Not Used |
| 23 | 205000 | | Roller And Spring Kit 4+Spr |

