

# Maytag GDE482 08 - TUMBLER-BEIGE

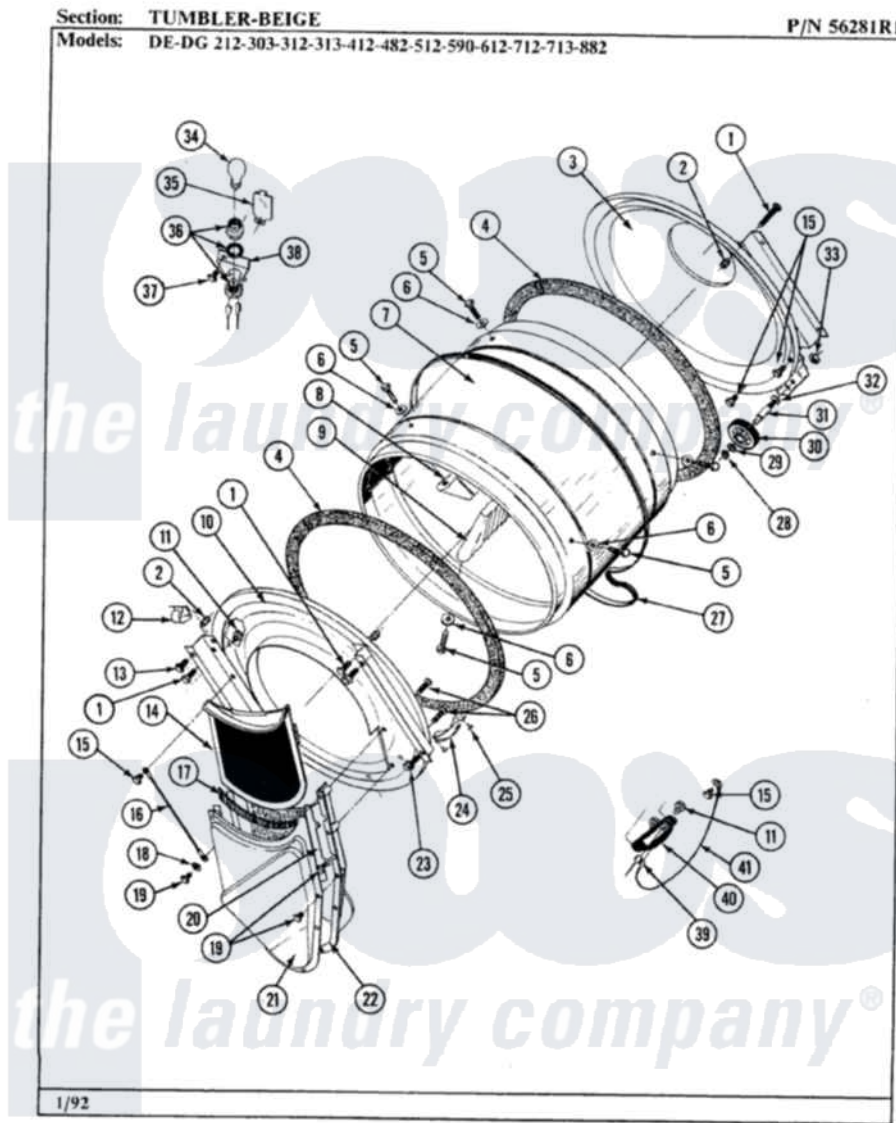

34

Maytag [Residential Maytag GDE482 Dryer Parts](#) Parts Diagram 08 - TUMBLER-BEIGE  
 Click on the part number to view part

Item	Original Part Number	Replaced By	Status	Part Description
1	313764		Not Available	SCREW
2	313915	<a href="#">31-3915</a>		Tech Sheet
3	Y306660	<a href="#">33001106</a>		Back, Tumbler
4	<a href="#">314820</a>			Seal, Tumbler
5	<a href="#">Y310759</a>			Screw, Tumbler Baffles
6	<a href="#">314158</a>			Washer, Baffle To Tumbler
7	314802		Not Available	TUMBLER W/OUT BAFFLES
"	306663		Not Available	TUMBLER W/BAFFLES
8	314803	<a href="#">33001012</a>		Baffle
9	314804	<a href="#">33001004</a>		Baffle, Tall
10	306670		Not Available	TUMBLER FRONT----NA
12	<a href="#">Y310376</a>			Clip, Door Switch Harness
13	<a href="#">Y313561</a>			Screw----NA
14	Y306666	<a href="#">33001003</a>		Screen, Lint
15	211294	<a href="#">90767</a>		Screw, 8A X 3/8 HeX Washer Head Tapping
16	<a href="#">205810</a>			Wire, Ground

17	<a href="#">Y313796</a>		Lint Seal
18	<a href="#">310557</a>		Washer
19	Y312961	<a href="#">W10116751</a>	Screw
20	<a href="#">Y313795</a>		Guide For Lint Screen
21	Y312964	Not Available	OUTLET DUCT - OUTER HALF
22	306656	Not Available	OUTLET DUCT & GRID ASSEMBLY
"	306657	Not Available	OUTLET DUCT & GRID
23	Y310632	<a href="#">1163839</a>	Screw
24	<a href="#">306508</a>		Tumbler Bearing Kit ----W
25	<a href="#">210720</a>		Rivet, Bearing To Tumbler Fmt
26	Y314110	<a href="#">33002917</a>	Screw, No.10-16
27	<a href="#">Y312959</a>		Poly "V" Belt For Tumbler
28	410233	<a href="#">9703438</a>	Ring-Retrn
29	<a href="#">312535</a>		Washer, Vault Mounting Brk.
30	Y303373	<a href="#">12001541</a>	Drum Roller/Washer Assembly--W
31	Y312948	<a href="#">6-3129480</a>	Shaft- Tumbler
32	Y313347	<a href="#">312535</a>	Washer, Vault Mounting Brk.
33	312538	<a href="#">33001443</a>	Nut, Hex

