

Maytag GDE9900 08 - MOTOR, BLOWER, BASE FRAME & THERMOSTATS

SECTION: MOTOR, BLOWER, BASE FRAME & THERMOSTATS
 MODEL: DG-DE MODELS

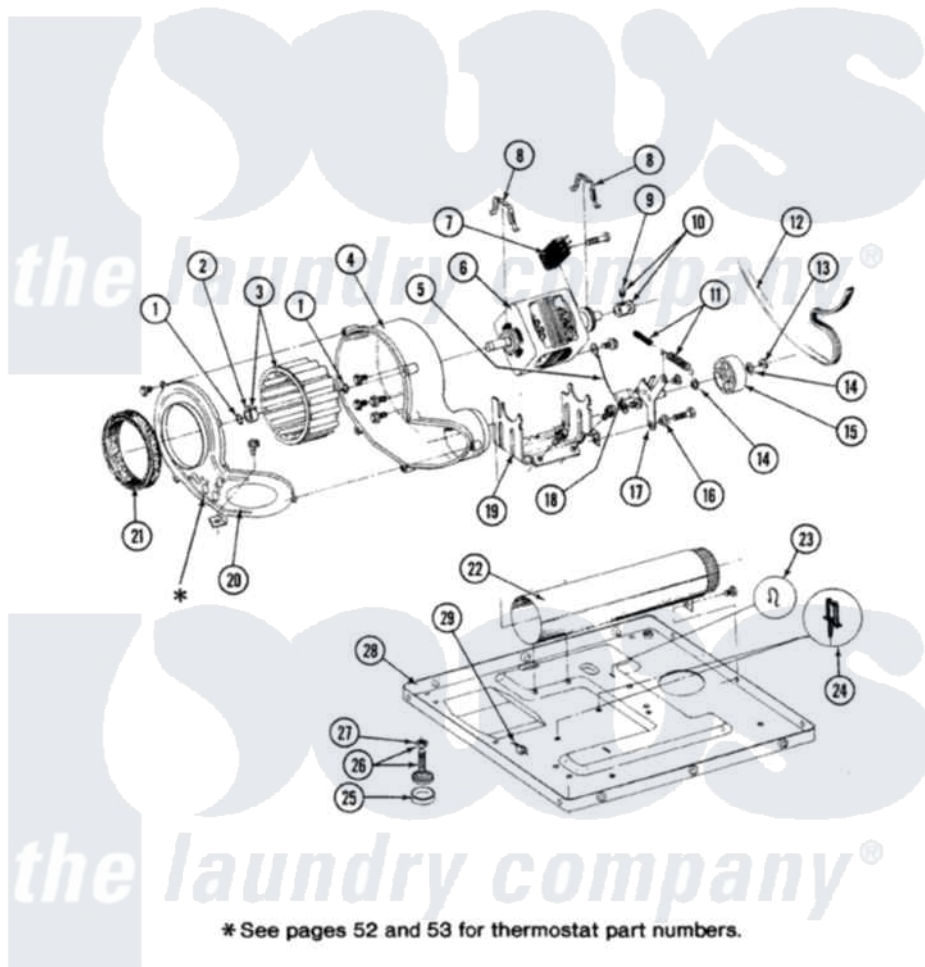

Issue Date: 6/90

50

Maytag [Residential Maytag GDE9900 Dryer Parts](#) Parts Diagram 08 - MOTOR, BLOWER, BASE FRAME & THERMOSTATS

[Click on the part number to view part](#)

| Item | Original Part Number | Replaced By | Status | Part Description |
|------|-------------------------|---------------------------|---------------|---|
| 1 | 410233 | 9703438 | | Ring-Retrn |
| 2 | 312967 | | | Clamp, Blower Housing |
| 3 | Y303836 | | | Blower Wheel Assembly And Clamp |
| 4 | Y310632 | 1163839 | | Screw |
| " | Y312893 | | | Housing, Blower |
| 5 | 901220 | | | Ground Wire |
| " | 211294 | 90767 | | Screw, 8A X 3/8 HeX Washer Head Tapping |
| " | 910343 | 488234 | | Screw 8-32 X 1/4 |
| 6 | Y303358 | W10410999 | | Motor-Drve |
| 7 | 306207 | | Not Available | (PROD. No.303358-8 & No.303358-9) |
| " | Y303877 | | Not Available | SWITCH, MOTOR EXTERNAL START No.303358-2, No.303358-4, 303358-7 |
| " | Y303879 | | | Switch, Motor External Start |

| | | | |
|----|-------------------------|---------------------------|-------------------------------|
| 8 | Y015825 | | Clip, Motor To Motor Support |
| 9 | Y053241 | | Set Screw, Motor Pulley |
| 10 | Y305185 | 6-3051850 | Pulley- MO |
| 11 | Y303945 | | IDLER SPRING ASSY. W/PLUG |
| 12 | Y312959 | | Poly "V" Belt For Tumbler |
| 13 | 312958 | 354987 | Ring, Retaining |
| 14 | Y312527 | | Washer, Idler Shaft |
| 15 | Y303705 | 6-3037050 | Pulley- ID |
| 16 | Y312894 | 315772 | Sleeve, Idler Arm |
| 17 | Y014874 | | Screw, Idler Arm And Sleeve |
| " | Y303363 | 6-3033630 | Idler Arm |
| " | Y312961 | W10116751 | Screw |
| 18 | Y313582 | W10116756 | Spacer |
| 19 | Y313561 | | Screw----NA |
| " | 312897 | Not Available | SUPPORT, MOTOR |
| 20 | 314778 | Not Available | COVER, BLOWER HOUSING |
| " | Y313561 | | Screw----NA |
| " | Y312961 | W10116751 | Screw |
| 21 | Y312901 | | Seal, Housing Cover |
| 22 | Y303442 | | EXHAUST DUCT ASSEMBLY |
| " | Y310632 | 1163839 | Screw |
| 23 | 410490 | | Spring, Retainer Wire Harness |
| 24 | Y313262 | W10116752 | Retainer- |
| 25 | Y314137 | | Foot, Rubber |
| 26 | Y305086 | | Adjustable Leg And Nut |
| 27 | Y052740 | 62739 | Nut, Lock |
| 28 | Y303361 | Not Available | BASE ASSY. (UPPER & LOWER) |
| 29 | Y310376 | | Clip, Door Switch Harness |

