

# Maytag GDG26CS 07 - LINT SCREEN, TUMBLER (FRONT & BACK)

MODEL DE-DG26CS LINT SCREEN, TUMBLER, TUMBLER FRONT & BACK

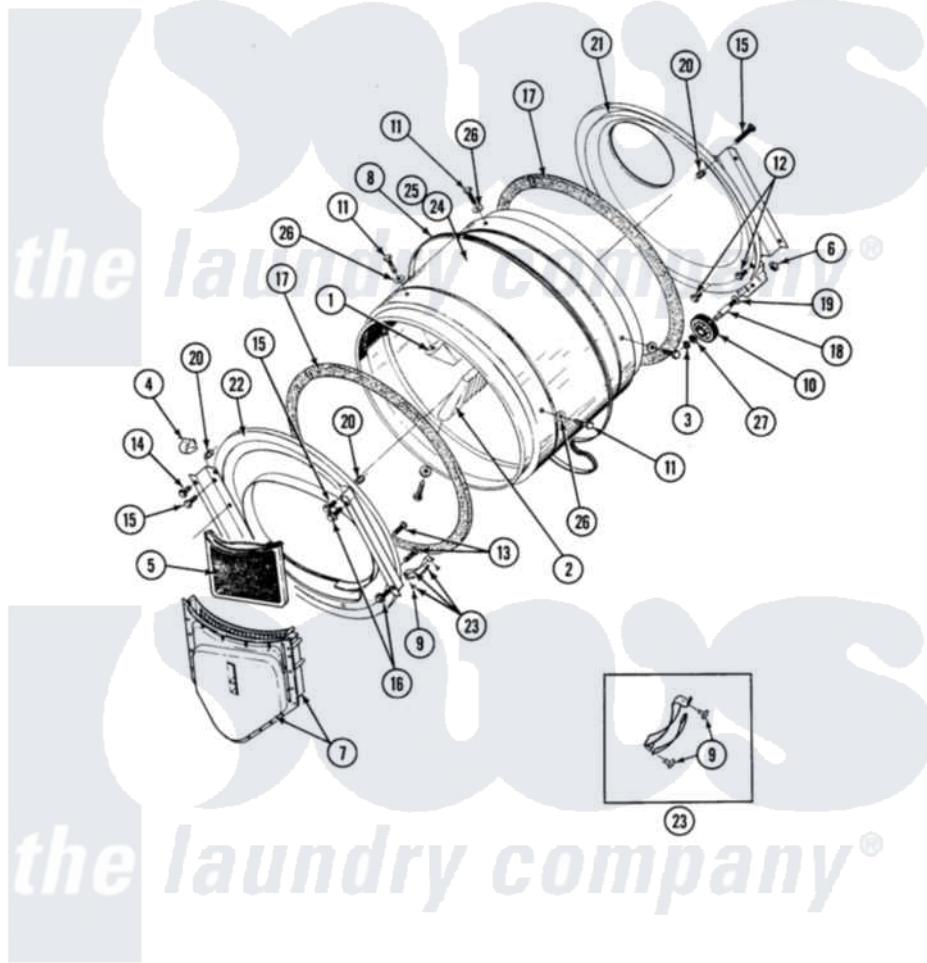

Maytag Residential Maytag GDG26CS Dryer Parts Parts Diagram 07 - LINT SCREEN, TUMBLER (FRONT & BACK)  
 Click on the part number to view part

Item	Original Part Number	Replaced By	Status	Part Description
001	314803	<a href="#">33001012</a>		Baffle
002	314804	<a href="#">33001004</a>		Baffle, Tall
003	410233	<a href="#">9703438</a>		Ring-Retrn
004	<a href="#">Y310376</a>			Clip, Door Switch Harness
005	307108	<a href="#">33002970</a>		Lint Filte
006	312538	<a href="#">33001443</a>		Nut, Hex
007	Y307112	<a href="#">33001016</a>		Outlet Duct Assembly
008	<a href="#">Y312959</a>			Poly "V" Belt For Tumbler
009	<a href="#">210720</a>			Rivet, Bearing To Tumbler Frmt
010	Y303373	<a href="#">12001541</a>		Drum Roller/Washer Assembly--W
011	<a href="#">Y310759</a>			Screw, Tumbler Baffles
012	211294	<a href="#">90767</a>		Screw, 8A X 3/8 HeX Washer Head Tapping
013	Y314110	<a href="#">33002917</a>		Screw, No.10-16
014	<a href="#">Y313561</a>			Screw----NA
015	NLA		Not Available	SCREW

016	Y310632	<a href="#">1163839</a>	Screw
017	<a href="#">314820</a>		Seal, Tumbler
018	Y312948	<a href="#">6-3129480</a>	Shaft- Tumbler
019	Y313347	<a href="#">312535</a>	Washer, Vault Mounting Brk.
020	NLA	Not Available	COVER, THREAD
021	Y307114	<a href="#">33001178</a>	Back, Tumbler
"	Y308544	<a href="#">33001178</a>	Back, Tumbler
022	307109	<a href="#">33001179</a>	Front, Tumbler
023	<a href="#">306508</a>		Tumbler Bearing Kit ----W
024	314802	Not Available	TUMBLER W/OUT BAFFLES
025	306663	Not Available	TUMBLER W/BAFFLES
026	<a href="#">314158</a>		Washer, Baffle To Tumbler
027	<a href="#">312535</a>		Washer, Vault Mounting Brk.

*the laundry company*<sup>®</sup>

*the laundry company*<sup>®</sup>

*the laundry company*<sup>®</sup>