

Maytag GDG26CS 08 - MOTOR, BLOWER, BASE FRAME & THERMOSTATS

MODEL DE-DG26CS **MOTOR, BLOWER, BASE FRAME**
& THERMOSTATS

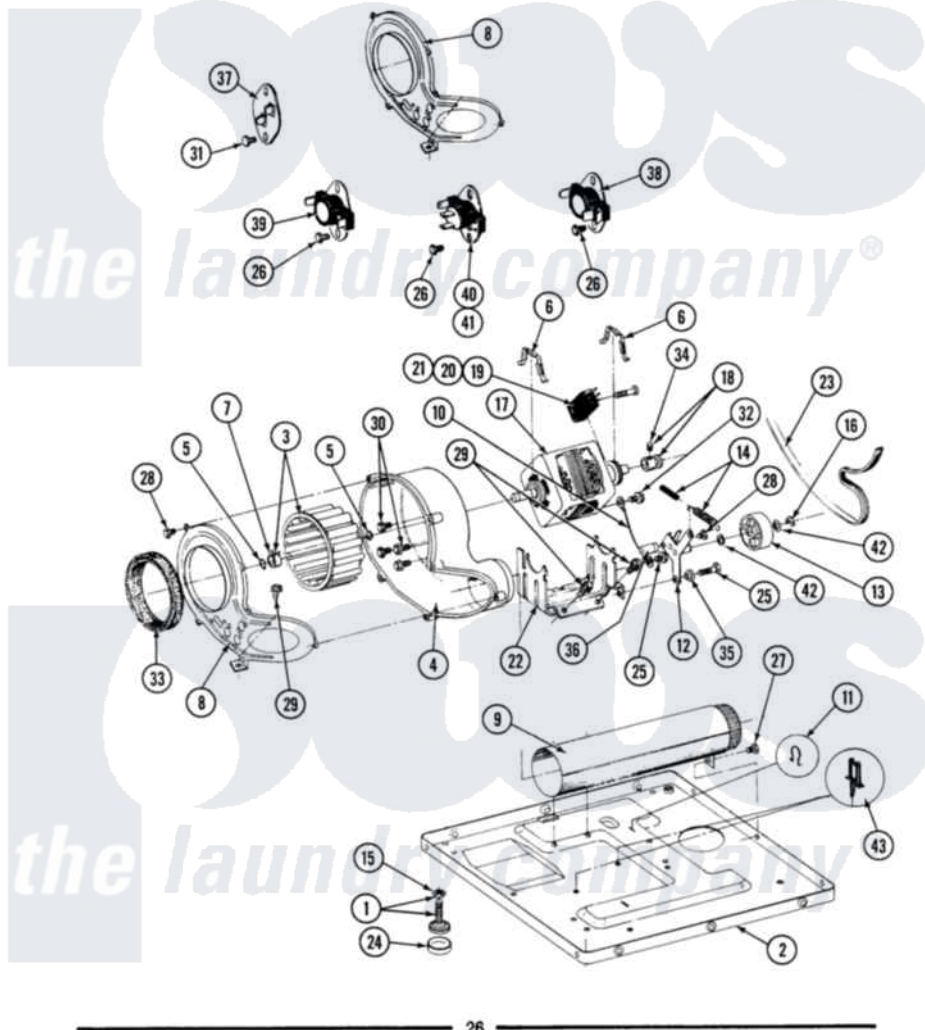

26

Maytag [Residential Maytag GDG26CS Dryer Parts](#) Parts Diagram 08 - MOTOR, BLOWER, BASE FRAME & THERMOSTATS

[Click on the part number to view part](#)

Item	Original Part Number	Replaced By	Status	Part Description
001	Y305086			Adjustable Leg And Nut
002	Y303361		Not Available	BASE ASSY. (UPPER & LOWER)
003	Y303836			Blower Wheel Assembly And Clamp
004	Y312893			Housing, Blower
005	410233	9703438		Ring-Retrn
006	Y015825			Clip, Motor To Motor Support
007	312967			Clamp, Blower Housing
008	314847			COVER, BLOWER HOUSING
009	Y303442			EXHAUST DUCT ASSEMBLY
010	901220			Ground Wire
011	410490			Spring, Retainer Wire Harness
012	Y303363	6-3033630		Idler Arm
013	Y303705	6-3037050		Pulley- ID

014	Y303945		IDLER SPRING ASSY. W/PLUG
015	Y052740	62739	Nut, Lock
016	312958	354987	Ring, Retaining
017	Y303358	W10410999	Motor-Drve
018	Y305185	6-3051850	Pulley- MO
019	Y303877	Not Available	SWITCH, MOTOR EXTERNAL START No.303358-2, No.303358-4, 303358-7
020	Y303879		Switch, Motor External Start
021	306207	Not Available	(PROD. No.303358-8 & No.303358-9)
"	NLA	Not Available	SWITCH, MOTOR START
022	NLA	Not Available	SUPPORT, MOTOR
023	Y312959		Poly "V" Belt For Tumbler
024	Y314137		Foot, Rubber
025	Y014874		Screw, Idler Arm And Sleeve
026	211294	90767	Screw, 8A X 3/8 HeX Washer Head Tapping
027	Y310632	1163839	Screw
028	Y312961	W10116751	Screw
029	Y313561		Screw----NA
030	314818	1163839	Screw
031	NLA	Not Available	SCREW
032	910343	488234	Screw 8-32 X 1/4
033	Y312901		Seal, Housing Cover
034	Y053241		Set Screw, Motor Pulley
035	Y312894	315772	Sleeve, Idler Arm
036	Y313582	W10116756	Spacer
037	306604		Cut-Off, Thermal Part Not Used
038	Y303225		Thermostat, Permanent Press
039	303392		Thermostat, Cycling
040	306966		Thermostat, Multi-Temp Part Not Used Mdg26ct-MN Only
041	306967		Thermostat, Multi-Temp Part Not Used Mde26ct-MN Only
042	Y312527		Washer, Idler Shaft
043	Y313262	W10116752	Retainer-

