

Maytag GDG26CS 10 - INLET DUCT, GAS VALVE, CONE & EXTENSION

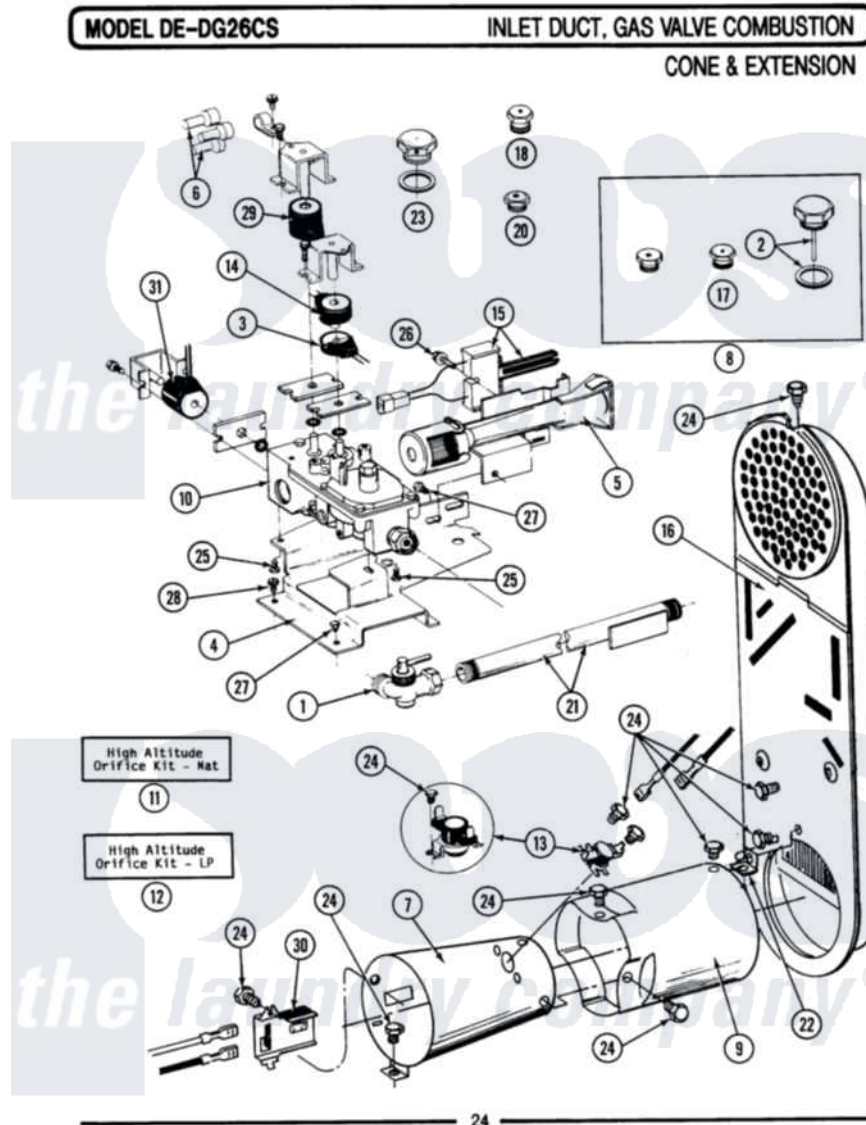

Maytag [Residential Maytag GDG26CS Dryer Parts](#) Parts Diagram 10 - INLET DUCT, GAS VALVE, CONE & EXTENSION

[Click on the part number to view part](#)

| Item | Original Part Number | Replaced By | Status | Part Description |
|------|-------------------------|---------------------------|---------------|-----------------------------|
| 001 | Y303349 | | | Angle Shut-Off, Gas Valve |
| 002 | NLA | | Not Available | SCREW ASSY - BLUE BLOCK OPE |
| 003 | 305605 | | | Booster Coil |
| 004 | 312929 | | | Gas Valve Bracket |
| 005 | 304974 | 33002793 | | Burner Assembly |
| 006 | 311546 | 911445 | | Wire Connector |
| 007 | Y303368 | | | Cone, Combustion |
| " | Y308548 | | | Combustion Cone Assembly |
| 008 | Y303779 | | | Conversion Kit |
| 009 | Y303841 | | | Cone, Extension |
| 010 | Y303777 | W10116794 | | Gas Valve |
| 011 | NLA | | Not Available | WIRE |
| 012 | NLA | | Not Available | ORIFICE KIT, LP (HIGH ALT.) |
| 013 | 305169 | | | Thermostat, Hi-Limit Gas |
| 014 | 305604 | | | Holding Coil |

| | | | |
|-----|-------------------------|--------------------------|--|
| 015 | 304970 | 4391996 | Ignitor |
| 016 | 307119 | | Duct, Inlet Assembly |
| 017 | NLA | Not Available | INTERNAL ORIFICE (LP) |
| 018 | 313367 | | Main Burner Orifice-Int-NAT |
| 019 | NLA | Not Available | MAIN BURNER ORIFICE (LP) |
| 020 | 313366 | | Main Burner Orifice-Ext-NAT |
| 021 | Y303383 | 33001735 | Pipe And Bracket Assembly Series 18 Not Needed Use Vavle |
| 022 | Y312890 | | Retainer, Heater Chamber |
| 023 | NLA | Not Available | SCREW ASSEMBLY, LEAK LIMIT |
| 024 | 211294 | 90767 | Screw, 8A X 3/8 HeX Washer Head Tapping |
| 025 | NLA | Not Available | SCREW, HEX HD No.8 X 3/8 INCH |
| 026 | 304971 | | Screw Note: Screw, Igniter |
| 027 | Y310632 | 1163839 | Screw |
| 028 | Y313561 | | Screw---NA |
| 029 | 305603 | | Secondary Coil |
| 030 | Y303377 | 338906 | Radiant, Sensor |
| 031 | Y304626 | | Side Coil |

