

Maytag GDG8420 06 - LINT SCREEN, TUMBLER (FRONT & BACK)

SECTION: LINT SCREEN, TUMBLER, TUMBLER FRONT & BACK
 MODEL: DE-DG MODELS

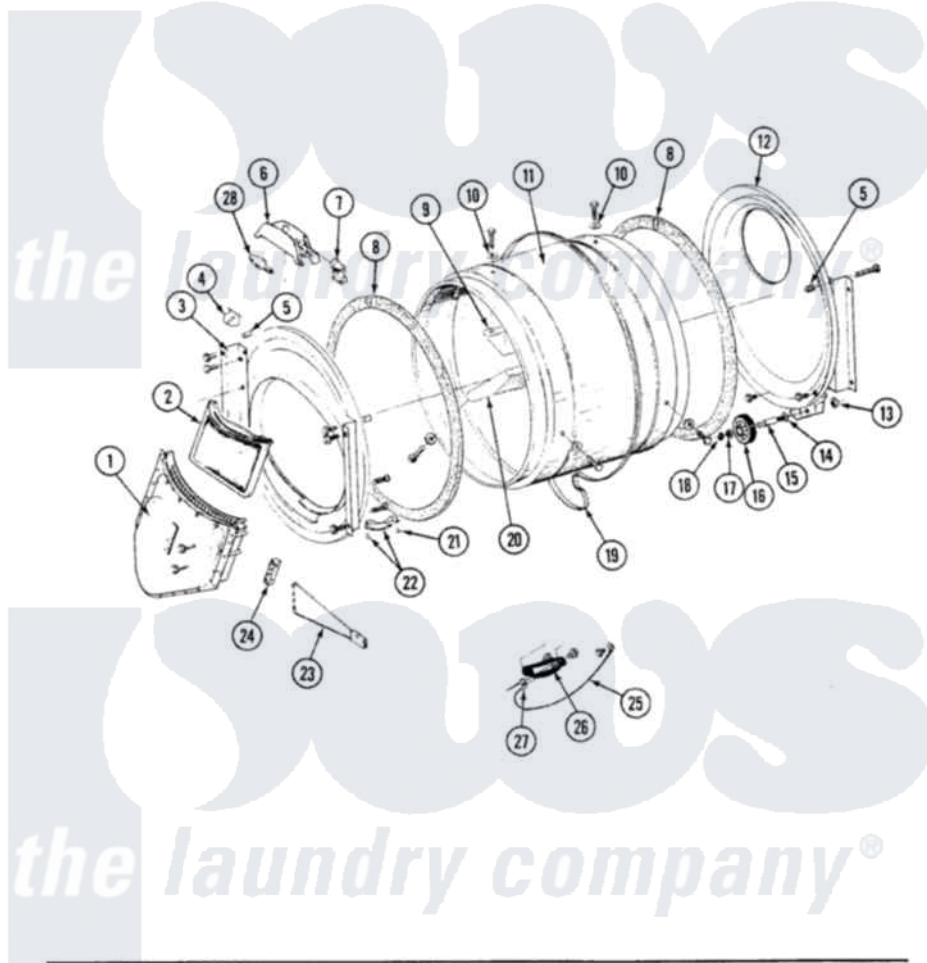

Issue Date: 6/90

44

Maytag [Residential Maytag GDG8420 Dryer Parts](#) Parts Diagram 06 - LINT SCREEN, TUMBLER (FRONT & BACK)
 Click on the part number to view part

| Item | Original Part Number | Replaced By | Status | Part Description |
|------|-------------------------|--------------------------|---------------|---|
| 1 | Y307112 | 33001016 | | Outlet Duct Assembly |
| " | Y314110 | 33002917 | | Screw, No.10-16 |
| 2 | Y307107 | 33002970 | | Lint Filte |
| 3 | 313764 | | Not Available | SCREW |
| " | 307109 | 33001179 | | Front, Tumbler |
| " | Y313561 | | | Screw----NA |
| " | Y310632 | 1163839 | | Screw |
| 4 | Y310376 | | | Clip, Door Switch Harness |
| 5 | 313915 | 31-3915 | | Tech Sheet |
| 8 | 314820 | | | Seal, Tumbler |
| 9 | 314803 | 33001012 | | Baffle |
| " | Y310759 | | | Screw, Tumbler Baffles |
| 10 | 314158 | | | Washer, Baffle To Tumbler |
| 11 | 314802 | | Not Available | TUMBLER W/OUT BAFFLES |
| " | 306663 | | Not Available | TUMBLER W/BAFFLES |
| 12 | 211294 | 90767 | | Screw, 8A X 3/8 HeX Washer Head Tapping |

| | | | |
|----|-------------------------|---------------------------|--|
| " | Y308544 | 33001178 | Back, Tumbler |
| " | Y307114 | 33001178 | Back, Tumbler |
| 13 | 312538 | 33001443 | Nut, Hex |
| 14 | Y313347 | 312535 | Washer, Vault Mounting Brk. |
| 15 | Y312948 | 6-3129480 | Shaft- Tumbler |
| 16 | Y303373 | 12001541 | Drum Roller/Washer Assembly--W |
| 17 | 312535 | | Washer, Vault Mounting Brk. |
| 18 | 410233 | 9703438 | Ring-Retrn |
| 19 | Y312959 | | Poly "V" Belt For Tumbler |
| 20 | 314804 | 33001004 | Baffle, Tall |
| " | Y310759 | | Screw, Tumbler Baffles |
| 21 | 210720 | | Rivet, Bearing To Tumbler Fmt |
| 22 | 306508 | | Tumbler Bearing Kit ---W |
| 25 | 211294 | 90767 | Screw, 8A X 3/8 HeX Washer Head Tapping |
| 27 | Y312658 | | Receptacle, Sensor Ground Wire |

