

Maytag GW20F6A 04 - TRANSMISSION (REV. A-D)

MASTER CASE GW20F6 TRANSMISSION

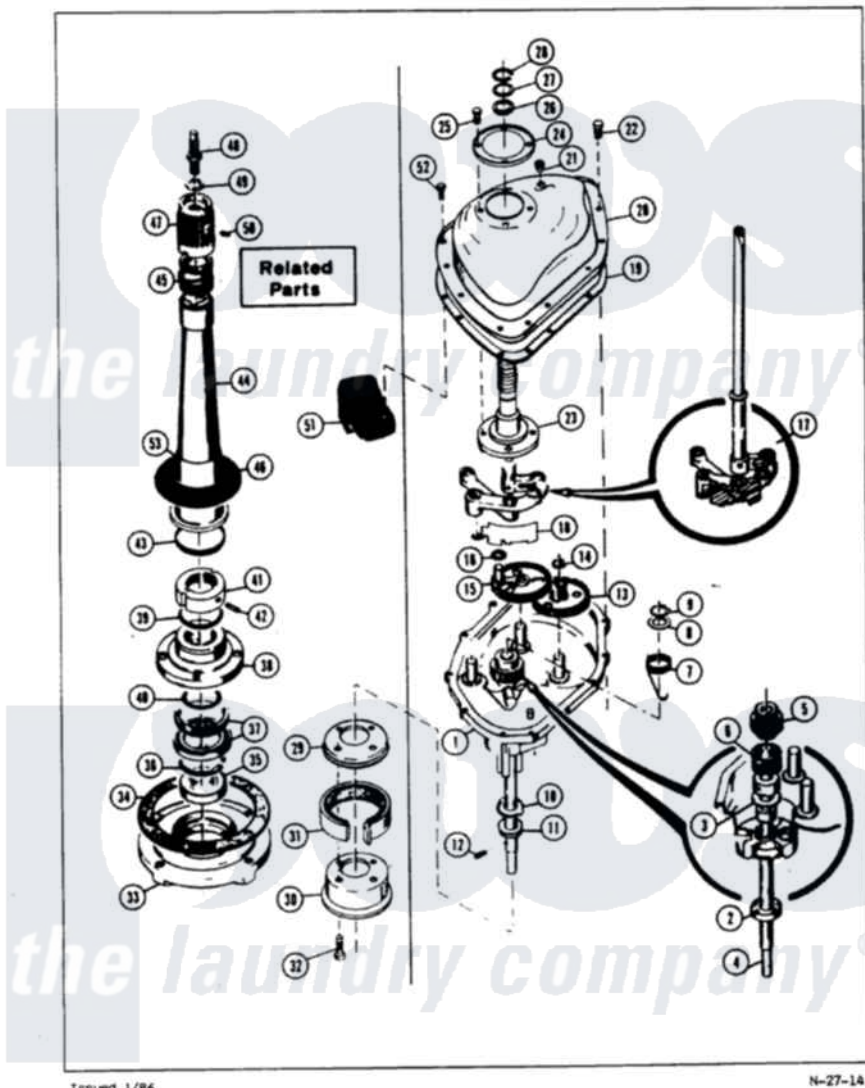

Issued 1/86

N-27-14

Maytag Residential Maytag GW20F6A Washer Parts Parts Diagram 04 - TRANSMISSION (REV. A-D)
 Click on the part number to view part

Item	Original Part Number	Replaced By	Status	Part Description
1	35-0630		Not Available	TRANSMISSION
"	33-9986		Not Available	TRANSM HOUSING
2	33-9208		Not Available	SEAL
3	33-9023N		Not Available	CLUTCH ASM
"	25-7274		Not Available	WASHER, STEEL
4	33-9022		Not Available	DRIVE SHAFT
5	33-6115		Not Available	DRIVE PINION
6	33-3195		Not Available	SPRING
7	33-6463			Spring
8	25-7415		Not Available	WASHER, FLAT
9	25-7173		Not Available	25-7708
10	33-9217		Not Available	THRUST WASHER
11	33-4944			Bearing
12	25-6120		Not Available	PIN
13	33-3228	35-0547		Cluster Gear
14	25-7175	25-7933		Ring, Retaining

15	33-5910	Not Available	GEAR CRANK
16	25-7091		Thrust Washer
17	33-9796	35-3573	Linkage As
"	35-0628	35-3573	Linkage As
18	33-9103	Not Available	OIL SPLSH PLATE
"	25-7175	25-7933	Ring, Retaining
19	33-9366	Not Available	COVER GASKET
"	33-4286N		Transmission Cover Kit
20	33-7182	Not Available	TRANSM COVER
21	33-9373	Not Available	OIL FILL PLUG
22	25-7758		Screw
23	33-8763	33-4286N	Transmission Cover Kit
24	33-7187		Covr Reinforcmt
25	25-7498	25-7359	Screw
26	25-7057		Washer, Flat
27	25-7051	25-7057	Washer, Flat
28	LA-1000	Not Available	BRAKE KIT
"	25-7708	25-7848	Retaining Ring
29	33-9984		Retainer Plate
30	33-9983	Not Available	BRAKE HUB
31	33-9686	35-0483	Band andl Lning Assembly
32	25-7399		Screw
"	33-4282N		Housing Kit
33	33-9522		Bearing And Housing Assembly
34	33-9046	35-0929	Gasket
35	33-0260	35-2205	Bearing, Spin
36	25-7178	25-7849	Retaining Ring
37	33-7224	33-7224N	Tub Seal Assembly
38	33-9230	Not Available	BASKET HUB ASM
"	33-9987	Not Available	BASKET HUB ASM
39	25-7749		O Ring
40	25-7722	33-4293N	Gasket Kit
41	33-9504		Locknut
42	25-7120		Set Screw
"	33-4283N	Not Available	CENTERPOST KIT
43	33-8718		Gasket
44	33-9498	Not Available	CENTERPOST ASM
45	33-7806	33-7806N	Seal Assembly
46	33-9047	35-0930	Gasket
"	33-9461		Gasket
47	33-9729	Not Available	DRIVE BLOCK ASM
48	34-1248	33-6817	Stud
49	25-7316		Flat Washer
50	25-7378		Set Screw
51	35-0013	Not Available	COUNTERWEIGHT
52	25-7359		Screw
53	35-0466	21001415	Gallon Of Oil
"	33-6790		Bearing, Agitator