

# Maytag LA210S 01 - BASE\PUMP\MOTOR

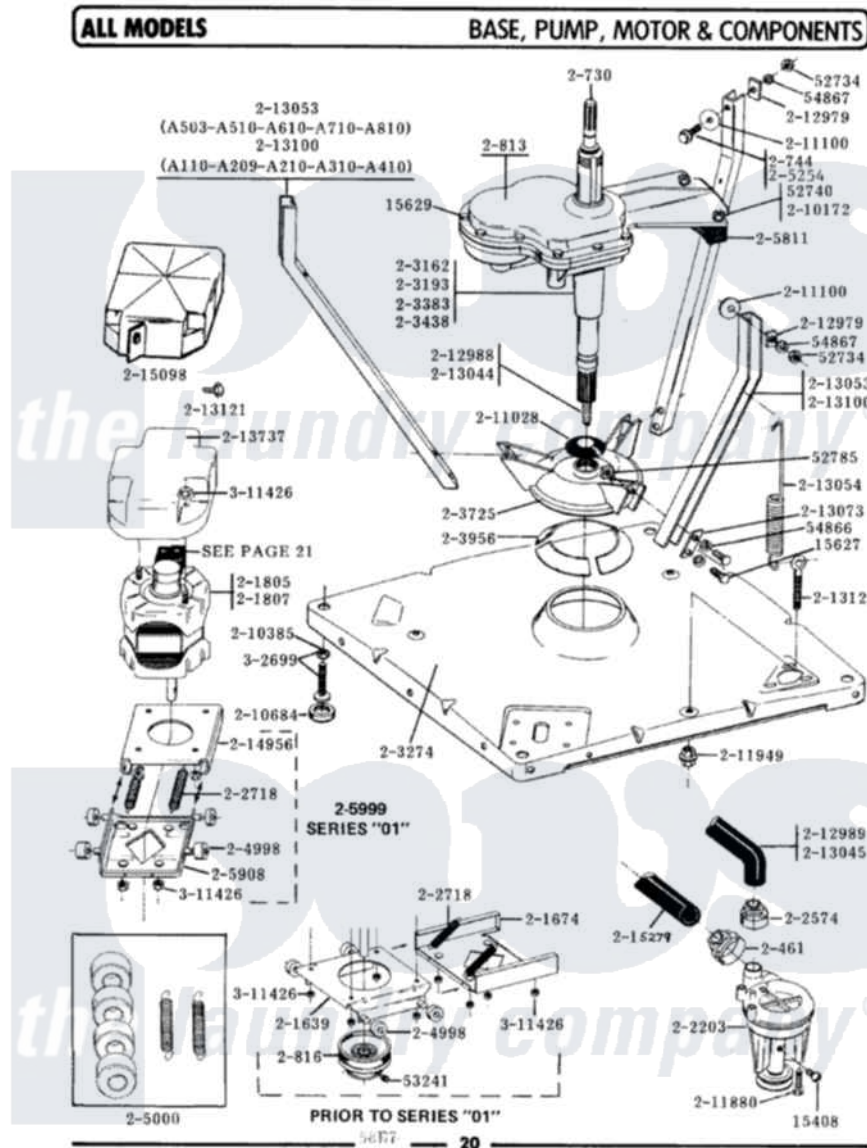

Maytag Residential Maytag LA210S Washer Parts Parts Diagram 01 - BASE\PUMP\MOTOR  
 Click on the part number to view part

| Item | Original Part Number    | Replaced By               | Status        | Part Description               |
|------|-------------------------|---------------------------|---------------|--------------------------------|
| 1    | Y015408                 | <a href="#">22003235</a>  |               | Screw, Bearing Insert          |
| 2    | <a href="#">Y015627</a> |                           |               | Screw- Hex                     |
| 3    | <a href="#">Y015629</a> |                           |               | Bolt, Grinding Chamber         |
| 4    | <a href="#">Y052734</a> |                           |               | Nut, Carrage Bolts And Bracket |
| 5    | Y052740                 | <a href="#">62739</a>     |               | Nut, Lock                      |
| 6    | <a href="#">Y052785</a> |                           |               | Nut, Brace To Damper           |
| 7    | <a href="#">Y053241</a> |                           |               | Set Screw, Motor Pulley        |
| 8    | Y054866                 | <a href="#">486009</a>    |               | Lockwasher                     |
| 9    | <a href="#">Y054867</a> |                           |               | Washer, Lock                   |
| 10   | 200461                  | <a href="#">285655</a>    |               | Clamp, Hose                    |
| 11   | 200730                  | <a href="#">22002124</a>  |               | Shaft- Agi                     |
| 12   | 200744                  | <a href="#">W10175939</a> |               | Bolt                           |
| 13   | 200750                  |                           | Not Available | GEAR CASE COVER                |
| 14   | 200813                  |                           | Not Available | GEAR CASE COVER ASSEMBLY       |
| 15   | 200816                  | <a href="#">6-2008160</a> |               | Pulley- MO                     |

|    |                        |                           |  |
|----|------------------------|---------------------------|--|
| 16 | <a href="#">201639</a> |                           | Upper Motor Mount  |
| 17 | 201674                 | Not Available             | LOWER MOTOR MOUNT---<br>NA   |
| 19 | 202203                 | <a href="#">6-2022030</a> | Pump As Pa   |
| 20 | 202574                 | <a href="#">3367052</a>   | Clamp, Hose  |
| 22 | <a href="#">202718</a> |                           | Springs, Tension   |
| 25 | <a href="#">203274</a> |                           | Base With Damper Pads  |
| 27 | <a href="#">203725</a> |                           | Damper W/Bolt And Clip   |
| 28 | <a href="#">203956</a> |                           | Damper Pad Kit   |
| 30 | <a href="#">204807</a> |                           | Ground Wire, Supp. Plte To<br>Top Cover                              |
| 31 | 204998                 | <a href="#">205000</a>    | Roller And Spring Kit 4+Spr  |
| 32 | <a href="#">205000</a> |                           | Roller And Spring Kit 4+Spr  |
| 33 | <a href="#">205131</a> |                           | Switch, Motor External Start   |
| 34 | 205132                 | Not Available             | SWITCH, MOTOR EXTERNAL<br>START No.201664-14,205463-<br>4 & 201800-4 |
| 35 | 205133                 | Not Available             | (PROD. IDNo. 2-1664-8 & 2-<br>5463)                                  |
| 36 | 205134                 | Not Available             | MOTOR EXTERNAL START<br>SWITCH                                       |
| 37 | <a href="#">205811</a> |                           | Counterweight  |
| 38 | <a href="#">205908</a> |                           | Motor Mount Assembly   |
| 39 | <a href="#">205999</a> |                           | Motor Mount Assembly   |
| 40 | <a href="#">210172</a> |                           | Lock Washer  |
| 41 | <a href="#">210385</a> |                           | Lock Nut For Adjustable Leg  |
| 42 | <a href="#">210684</a> |                           | Foot, Adjustable Leg   |
| 43 | 211028                 | <a href="#">22001586</a>  | Deflector, Water   |
| 44 | <a href="#">211100</a> |                           | Washer, Outer Tub  |
| 45 | <a href="#">211880</a> |                           | Screw, HeX Head No.10 X 1/2<br>Inc                                   |
| 46 | <a href="#">211949</a> |                           | Nut, Adjustment Eyebolt  |
| 47 | 212979                 | Not Available             | WASHER, TUB BRACE  |
| 53 | <a href="#">213054</a> |                           | Centering Spring - 3 Used  |
| 54 | <a href="#">213073</a> |                           | Washer, Double Brace   |
| 56 | 213120                 | <a href="#">216416</a>    | Bolt, Eye/Centering Spring   |
| 57 | 213121                 | <a href="#">3400111</a>   | Screw, 12-14 X 5/8   |
| 58 | <a href="#">213737</a> |                           | Shield, Motor  |
| 59 | 215279                 | <a href="#">22003410</a>  | Hose, Drain  |
| 60 | <a href="#">214956</a> |                           | Motor Mount Assembly   |
| 61 | <a href="#">215098</a> |                           | Shield, Motor  |
| 62 | Y302699                | <a href="#">22003428</a>  | Leg, Adjustable  |
| 63 | Y311426                | <a href="#">3400029</a>   | Nut, Adapter Plate   |

*the laundry company*<sup>®</sup>