

# Maytag LA211S 08 - TRANSMISSION-HELICAL DRIVE

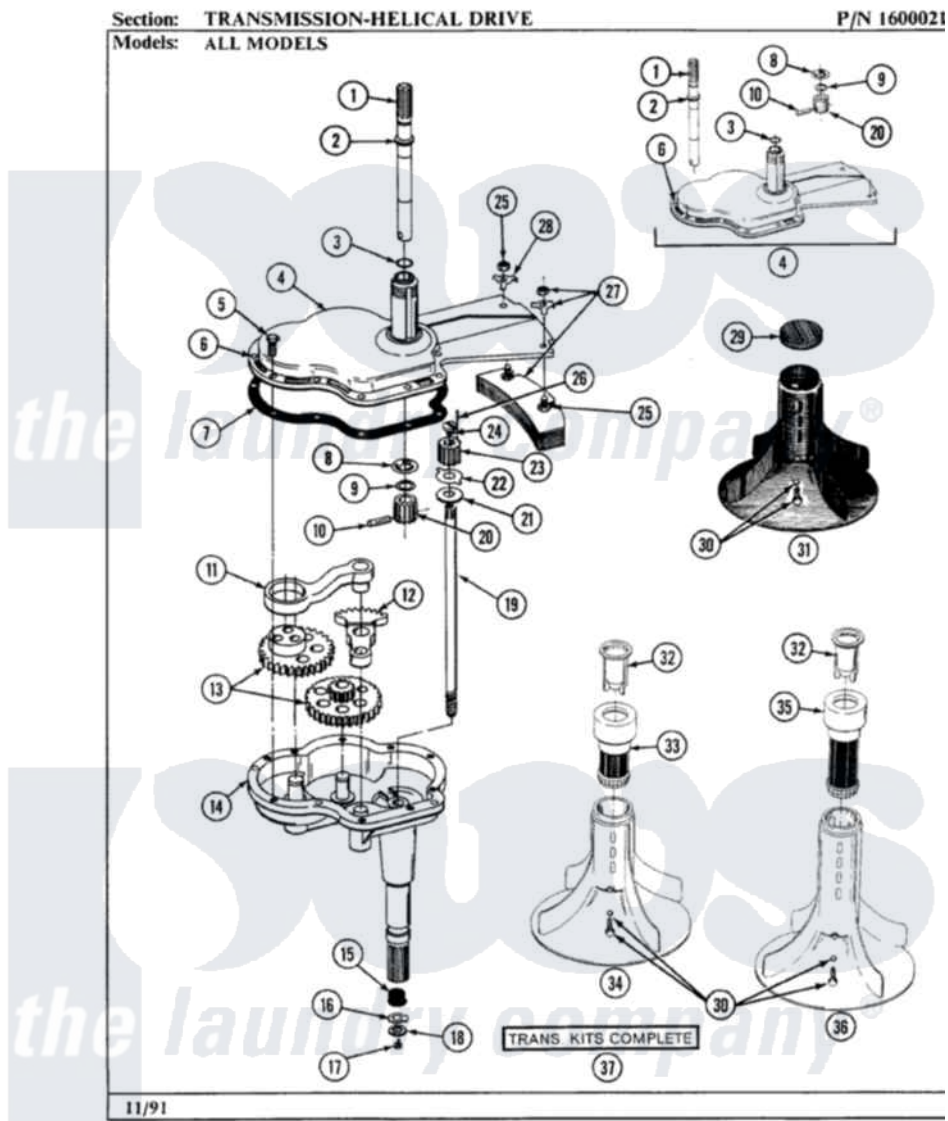

22

Maytag Residential Maytag LA211S Washer Parts Parts Diagram 08 - TRANSMISSION-HELICAL DRIVE  
 Click on the part number to view part

| Item | Original Part Number    | Replaced By              | Status        | Part Description              |
|------|-------------------------|--------------------------|---------------|-------------------------------|
| 1    | 200730                  | <a href="#">22002124</a> |               | Shaft- Agi                    |
| 2    | <a href="#">Y014839</a> |                          |               | Collar-Drive Shaft            |
| 3    | <a href="#">210690</a>  |                          |               | Seal, Rubber                  |
| 4    | 200813                  |                          | Not Available | GEAR CASE COVER ASSEMBLY      |
| 5    | <a href="#">Y015629</a> |                          |               | Bolt, Grinding Chamber        |
| 6    | <a href="#">015639</a>  |                          |               | Dowel Pin                     |
| 7    | 210632                  | <a href="#">22210632</a> |               | Gasket                        |
| 8    | <a href="#">Y015902</a> |                          |               | Spring For Agitator           |
| 9    | <a href="#">Y014827</a> |                          |               | Washer-Center Shaft           |
| 10   | <a href="#">210183</a>  |                          |               | Groove Pin                    |
| 11   | 201463                  |                          | Not Available | PITMAN WITH WRIST PIN         |
| 12   | <a href="#">210670</a>  |                          |               | Segment                       |
| 13   | <a href="#">204967</a>  |                          |               | Gear Kit-Power Fin Agitator   |
| 14   | <a href="#">203162</a>  |                          |               | Gear Housing W/Studs And Tube |
| 15   | 206602                  | <a href="#">207843</a>   |               | Lip Seal Repair Kit           |

|    |                        |                           |                             |
|----|------------------------|---------------------------|-----------------------------|
| 16 | <a href="#">211089</a> |                           | Lug, Stop Pulley            |
| 17 | 211375                 | <a href="#">681582</a>    | Screw                       |
| 18 | 211090                 | <a href="#">22003555</a>  | Washer, Stop Lug            |
| 19 | <a href="#">212988</a> |                           | Part Not Used               |
| 20 | <a href="#">210054</a> |                           | Pinion                      |
| 21 | 211483                 | <a href="#">6-2114830</a> | Washer- SP                  |
| 22 | <a href="#">211484</a> |                           | Washer, Lug                 |
| 23 | <a href="#">210315</a> |                           | Pinion                      |
| 24 | <a href="#">211486</a> |                           | Screw, 3/8-16 X 1/2 Inch    |
| 25 | Y052740                | <a href="#">62739</a>     | Nut, Lock                   |
| 26 | <a href="#">211487</a> |                           | Groov-Pin                   |
| 27 | <a href="#">205811</a> |                           | Counterweight               |
| 28 | <a href="#">210172</a> |                           | Lock Washer                 |
| 30 | 206478                 | Not Available             | SCREW & WASHER FOR AGITATOR |
| 31 | 201379                 | Not Available             | AGITATOR - BLACK            |
| 32 | 212815                 | Not Available             | DISPENSER CUP               |
| 33 | 203320                 | Not Available             | LINT FILTER - DISPENSER     |
| 34 | 205054                 | Not Available             | AGITATOR                    |
| 37 | 203383                 | <a href="#">W10172458</a> | Transmison                  |

