

Maytag LA612S 08 - TOP COVER, CONSOLE & LID SWITCH (SER 11)

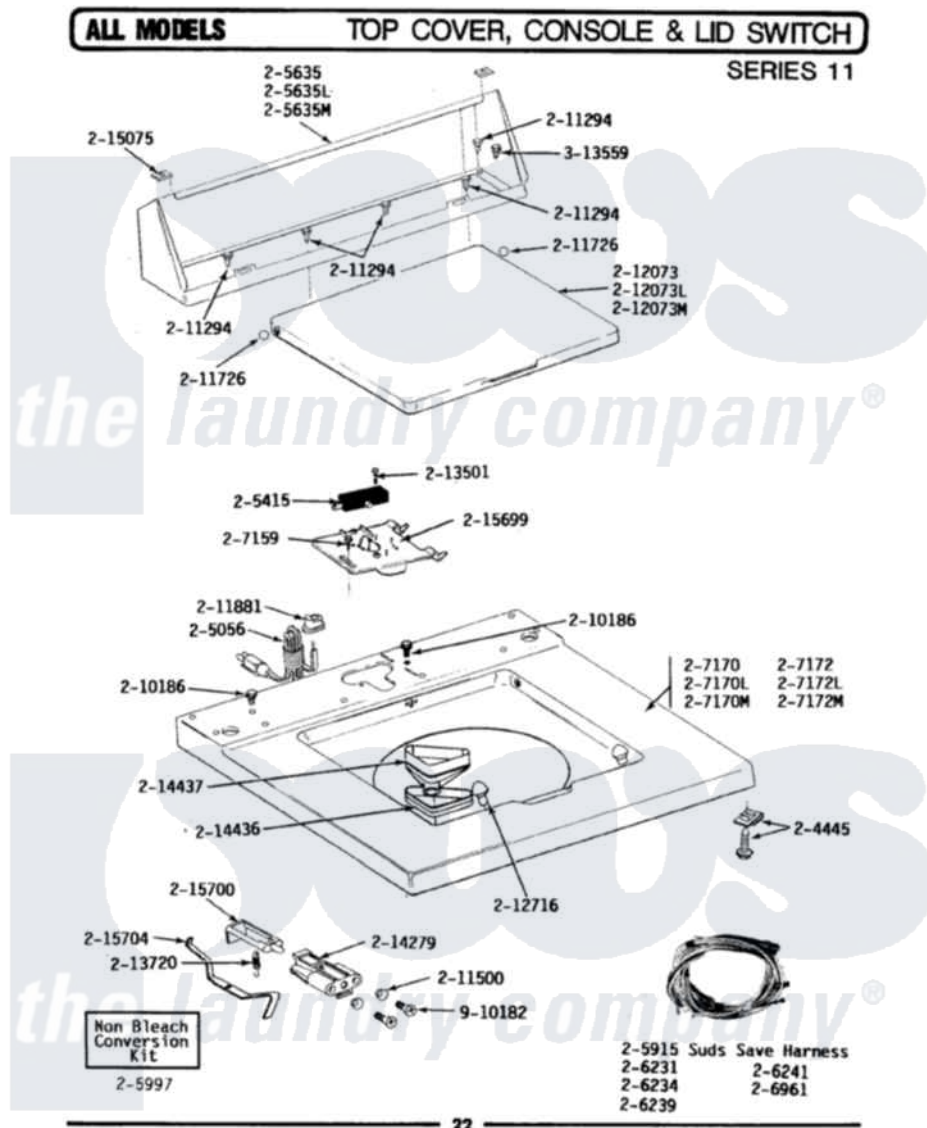

Maytag [Residential Maytag LA612S Washer Parts](#) Parts Diagram 08 - TOP COVER, CONSOLE & LID SWITCH (SER 11)

Click on the part number to view part

Item	Original Part Number	Replaced By	Status	Part Description
1	Y201808			Converter
2	204445			Screw And Fastener Assembly
3	204968			Plunger And Bracket Assembly--W
4	205056	204590		Cord, Power
5	205415	279347		Switch-Lid
7	205635L		Not Available	CONSOLE (ALM)
8	205915		Not Available	SUDS SAVE HARNESS
9	205997			Non-Bleach Conversion Kit
10	206231			Wire Harness
11	207159	489355		Screw, 8 X 1/2
13	207170L			Top Cover Assembly ALM---NA
16	207172L			Top Cover Assembly ALM---NA
17	210186	3370225		Screw
18	211294	00767		Screw, 8A X 3/8 Hex Washer

18	211294	90707	Head Tapping
19	211500		Washer, Bracket To Top Cover
20	211726		Hinge, Ball Lid
23	211737	248562	Terminal
24	211881		Grommet, Cord Part Not Used- Gas Models Only
26	212073L		Not Available LID-ALMOND
27	212716		Bumper, Lid
28	213501		Screw, No.6-20 X 1-1/8 Inch
29	213718		Plunger, Lid Switch
30	213720		Spring, Lid Switch
31	214279	204968	Plunger And Bracket Assembly--W
32	214436		Gasket
33	214805		Pin For Unbalance Lever
34	214813		Not Available LEVER FOR LID SWITCH
35	214898		Cover For Lid Switch
36	214987		Moisture Barrier For Switch
37	215075		Fastener, Control Panel To Console
38	215236	214804	Unbalance Lever
40	215578		Bleach Inlet Almond
42	215580		Cup, Bleach
43	Y215699	22001678	Bracket, Switch And Fuse
44	215700		Not Available LID SWITCH PLUNGER
45	215704		Lever, Unbalance
46	301548		Clamp, Ground Wire
47	311155		Ground Wire And Clamp
48	Y312140		Wire Connector
"	Y313559		Screw
49	410635		Fastener
50	910182	25-7809	Screw, No.6-20 1/2 Flthd Torx
51	911267		Screw, Pump Cover

