

# Maytag LA8210 01 - BASE ASSEMBLY

SECTION: BASE ASSEMBLY  
 MODEL: A8120 A8210

P/N 16000168

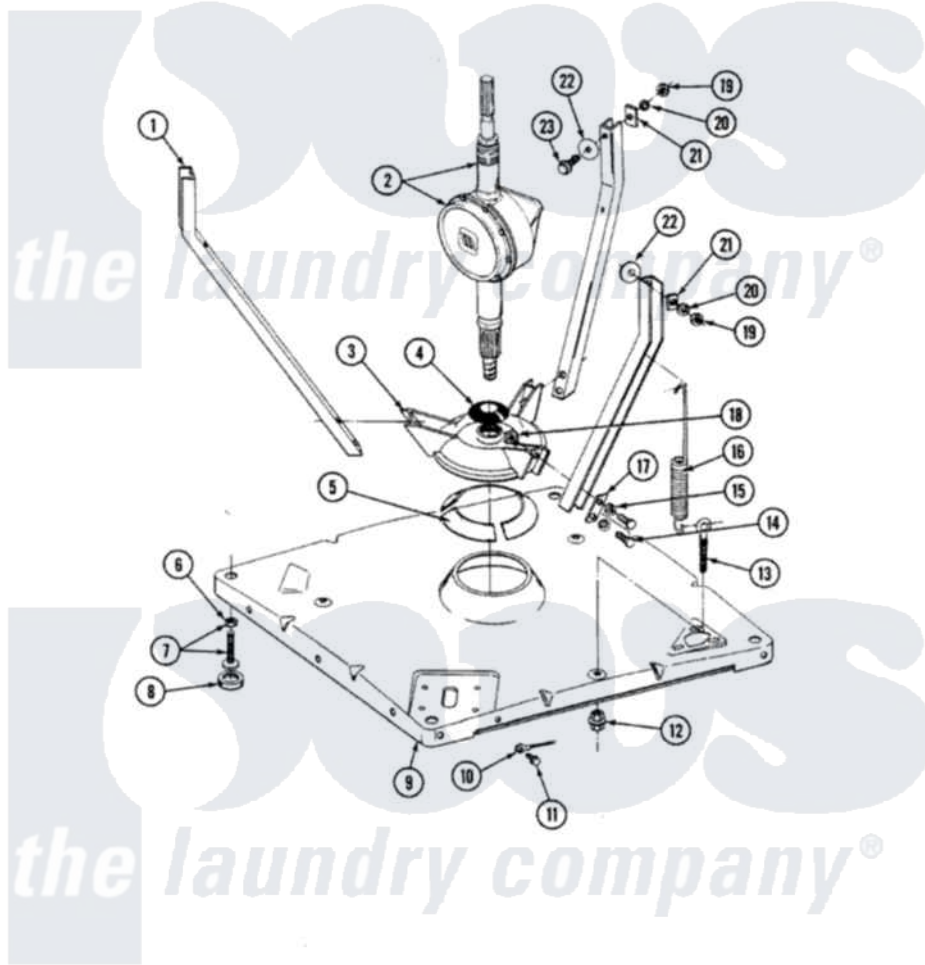

Issue Date: 5/91

16

Maytag Residential Maytag LA8210 Washer Parts Parts Diagram 01 - BASE ASSEMBLY  
 Click on the part number to view part

Item	Original Part Number	Replaced By	Status	Part Description
1	213100		Not Available	PART NOT USED
2	206708	<a href="#">6-2097790</a>		Transmison
3	<a href="#">203725</a>			Damper W/Bolt And Clip
4	211028	<a href="#">22001586</a>		Deflector, Water
5	<a href="#">203956</a>			Damper Pad Kit
6	<a href="#">210385</a>			Lock Nut For Adjustable Leg
7	Y302699	<a href="#">22003428</a>		Leg, Adjustable
8	<a href="#">210684</a>			Foot, Adjustable Leg
9	<a href="#">203274</a>			Base With Damper Pads
10	<a href="#">204807</a>			Ground Wire, Supp. Plte To Top Cover
11	210186	<a href="#">3370225</a>		Screw
12	<a href="#">211949</a>			Nut, Adjustment Eyebolt
13	213120	<a href="#">216416</a>		Bolt, Eye/Centering Spring
14	<a href="#">Y015627</a>			Screw- Hex
15	911852	<a href="#">486009</a>		Lockwasher
16	<a href="#">213054</a>			Centering Spring - 3 Used

17	<a href="#">213073</a>		Washer, Double Brace
18	<a href="#">Y052785</a>		Nut, Brace To Damper
19	<a href="#">Y052734</a>		Nut, Carrage Bolts And Bracket
20	<a href="#">Y054867</a>		Washer, Lock
21	212979	Not Available	WASHER, TUB BRACE
22	<a href="#">211100</a>		Washer, Outer Tub
23	200744	<a href="#">W10175939</a>	Bolt

