

Maytag LAT8306ABE 02 - CABINET

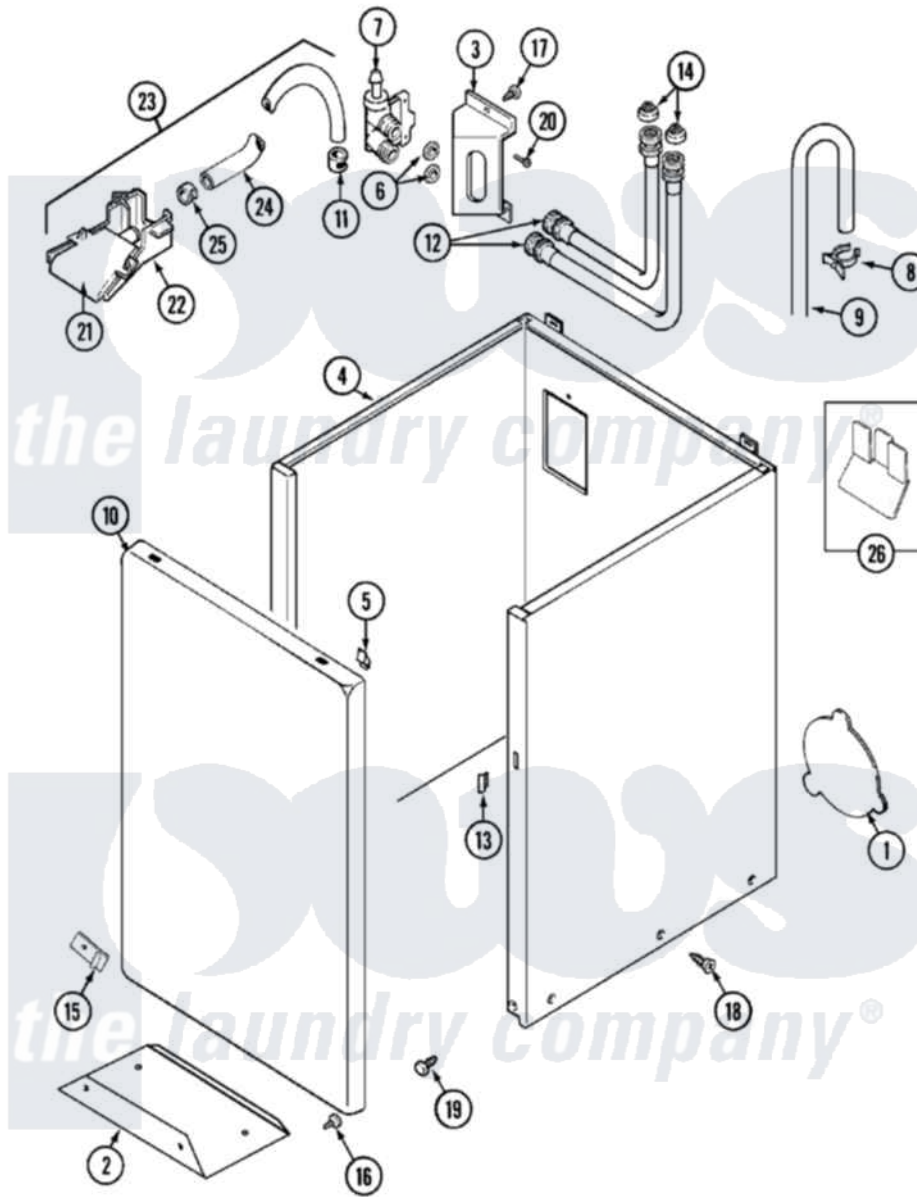

Maytag [Residential Maytag LAT8306ABE Washer Parts](#) Parts Diagram 02 - CABINET
 Click on the part number to view part

| Item | Original Part Number | Replaced By | Status | Part Description |
|------|--------------------------|--------------------------|---------------|---|
| 1 | 22001683 | 22002924 | | Plate, Access |
| " | 211878 | | Not Available | PLATE, ACCESS |
| " | 211294 | 90767 | | Screw, 8A X 3/8 HeX Washer Head Tapping |
| 2 | 213846 | | | Guard, Belt |
| 3 | 22002361 | | | Bracket, Water Valve |
| " | 22002361 | | | Bracket, Water Valve |
| 4 | 22002379 | 22004425 | | Cabinet White Aspack |
| 5 | 22001650 | | | Fastener, Spring |
| 6 | Y013783 | | | Washer, Inlet Hose |
| 7 | 22002360 | | | Valve, Water |
| " | 214337 | 96160 | | Screen |
| 8 | 22001815 | 22002765 | | Clip, Hose |
| 9 | 22001816 | | | Hose, Drain |
| 10 | 22001817 | | | Sheet, Sound Damper |
| " | 22002366 | | Not Available | PANEL, FRONT (WHT) |
| 11 | 216169 | 596669 | | Clamp, Manifold |

| | | | |
|----|--------------------------|---------------------------|---|
| 12 | 202860 | | Inlet Hose Assembly |
| 13 | 214376 | 22002331 | Spacer, Front Panel |
| 14 | 200961 | 12001413 | Strainer And Washer Kit |
| 15 | 22001995 | | Screw Note: Screw, Tumbler Front And Shroud |
| " | 22002378 | 27001200 | Screw |
| " | 22002377 | | Clip, Retainer |
| " | 22002376 | | Clip |
| " | 12001341 | | Screw And Fastener Kit |
| 16 | 211294 | 90767 | Screw, 8A X 3/8 HeX Washer Head Tapping |
| 17 | 212276 | W10116760 | Screw |
| " | 22002372 | | Screw |
| 18 | 213007 | | Xfor Cabinet See Cabinet, Back |
| 19 | 213121 | 3400111 | Screw, 12-14 X 5/8 |
| " | 213122 | 27001200 | Screw |
| 20 | Y313561 | | Screw---NA |
| 21 | 22001187 | | Injector |
| 22 | 22001186 | | Injector |
| 23 | 22001304 | | Water Injector Assembly |
| 24 | 22001190 | | Hose, Injector |
| 25 | 216169 | 596669 | Clamp, Manifold |
| 26 | 22001972 | | Clip, Cabinet |

