

# Maytag LDE8420ACL 08 - TUMBLER

Section: TUMBLER

P/N 1600028

Models: ALL MODELS

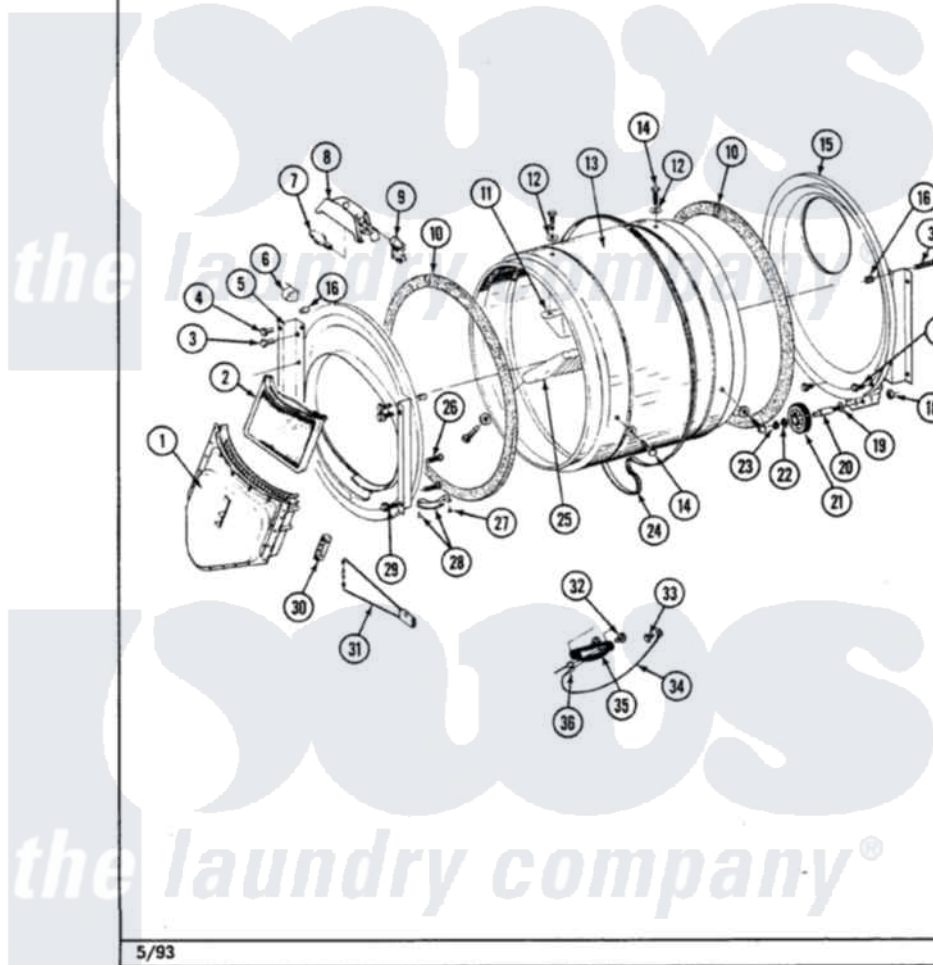

5/93

Maytag [Residential Maytag LDE8420ACL Dryer Parts](#) Parts Diagram 08 - TUMBLER

[Click on the part number to view part](#)

Item	Original Part Number	Replaced By	Status	Part Description
1	Y307112	<a href="#">33001016</a>		Outlet Duct Assembly
2	Y307107	<a href="#">33002970</a>		Lint Filte
3	313764		Not Available	SCREW
4	<a href="#">Y313561</a>			Screw----NA
5	307109	<a href="#">33001179</a>		Front, Tumbler
6	<a href="#">Y310376</a>			Clip, Door Switch Harness
10	<a href="#">314820</a>			Seal, Tumbler
11	314803	<a href="#">33001012</a>		Baffle
12	<a href="#">314158</a>			Washer, Baffle To Tumbler
13	306663		Not Available	TUMBLER W/BAFFLES
"	314802		Not Available	TUMBLER W/OUT BAFFLES
14	<a href="#">Y310759</a>			Screw, Tumbler Baffles
15	Y308544	<a href="#">33001178</a>		Back, Tumbler
"	Y307114	<a href="#">33001178</a>		Back, Tumbler
16	313915	<a href="#">31-3915</a>		Tech Sheet
17	211294	<a href="#">90767</a>		Screw, 8A X 3/8 HeX Washer Head Tapping

18	312538	<a href="#">33001443</a>	Nut, Hex
19	Y313347	<a href="#">312535</a>	Washer, Vault Mounting Brk.
20	Y312948	<a href="#">6-3129480</a>	Shaft- Tumbler
21	Y303373	<a href="#">12001541</a>	Drum Roller/Washer Assembly--W
22	<a href="#">312535</a>		Washer, Vault Mounting Brk.
23	410233	<a href="#">9703438</a>	Ring-Retrn
24	<a href="#">Y312959</a>		Poly "V" Belt For Tumbler
25	314804	<a href="#">33001004</a>	Baffle, Tall
26	Y314110	<a href="#">33002917</a>	Screw, No.10-16
27	<a href="#">210720</a>		Rivet, Bearing To Tumbler Frnt
28	<a href="#">306508</a>		Tumbler Bearing Kit ---W
29	Y310632	<a href="#">1163839</a>	Screw

*the laundry company*<sup>®</sup>

**Howes**  
*the laundry company*<sup>®</sup>

**Howes**  
*the laundry company*<sup>®</sup>