

Maytag LDE882 08 - TUMBLER-BEIGE

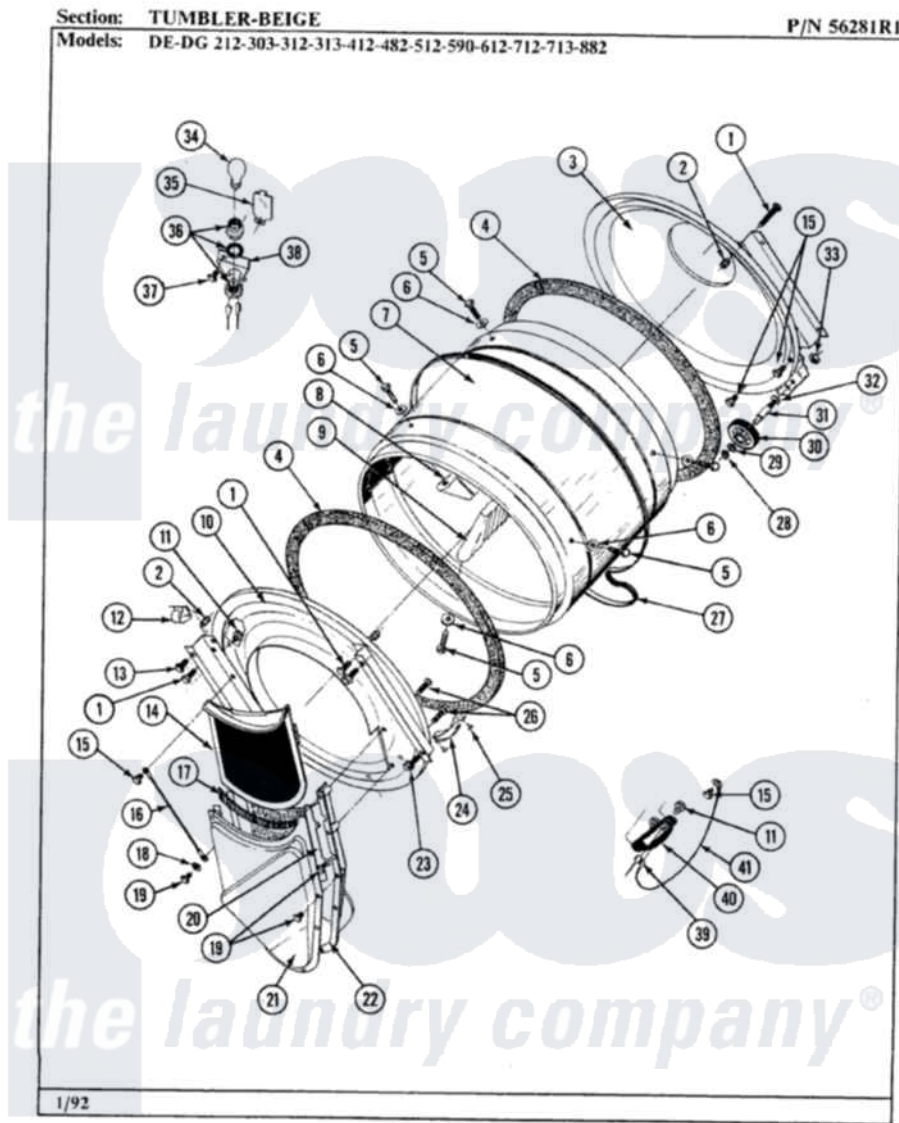

34

Maytag [Residential Maytag LDE882 Dryer Parts](#) Parts Diagram 08 - TUMBLER-BEIGE
 Click on the part number to view part

| Item | Original Part Number | Replaced By | Status | Part Description |
|------|-------------------------|--------------------------|---------------|---|
| 1 | 313764 | | Not Available | SCREW |
| 2 | 313915 | 31-3915 | | Tech Sheet |
| 3 | Y306660 | 33001106 | | Back, Tumbler |
| 4 | 314820 | | | Seal, Tumbler |
| 5 | Y310759 | | | Screw, Tumbler Baffles |
| 6 | 314158 | | | Washer, Baffle To Tumbler |
| 7 | 314802 | | Not Available | TUMBLER W/OUT BAFFLES |
| " | 306663 | | Not Available | TUMBLER W/BAFFLES |
| 8 | 314803 | 33001012 | | Baffle |
| 9 | 314804 | 33001004 | | Baffle, Tall |
| 10 | 306670 | | Not Available | TUMBLER FRONT----NA |
| 12 | Y310376 | | | Clip, Door Switch Harness |
| 13 | Y313561 | | | Screw----NA |
| 14 | Y306666 | 33001003 | | Screen, Lint |
| 15 | 211294 | 90767 | | Screw, 8A X 3/8 HeX Washer Head Tapping |
| 16 | 205810 | | | Wire, Ground |

| | | | |
|----|-------------------------|---------------------------|--------------------------------|
| 17 | Y313796 | | Lint Seal |
| 18 | 310557 | | Washer |
| 19 | Y312961 | W10116751 | Screw |
| 20 | Y313795 | | Guide For Lint Screen |
| 21 | Y312964 | Not Available | OUTLET DUCT - OUTER HALF |
| 22 | 306656 | Not Available | OUTLET DUCT & GRID ASSEMBLY |
| " | 306657 | Not Available | OUTLET DUCT & GRID |
| 23 | Y310632 | 1163839 | Screw |
| 24 | 306508 | | Tumbler Bearing Kit ----W |
| 25 | 210720 | | Rivet, Bearing To Tumbler Fmt |
| 26 | Y314110 | 33002917 | Screw, No.10-16 |
| 27 | Y312959 | | Poly "V" Belt For Tumbler |
| 28 | 410233 | 9703438 | Ring-Retrn |
| 29 | 312535 | | Washer, Vault Mounting Brk. |
| 30 | Y303373 | 12001541 | Drum Roller/Washer Assembly--W |
| 31 | Y312948 | 6-3129480 | Shaft- Tumbler |
| 32 | Y313347 | 312535 | Washer, Vault Mounting Brk. |
| 33 | 312538 | 33001443 | Nut, Hex |

