

# Maytag LSE7804ACM 10 - TOP & LID (LSE7804ACM & ADM)

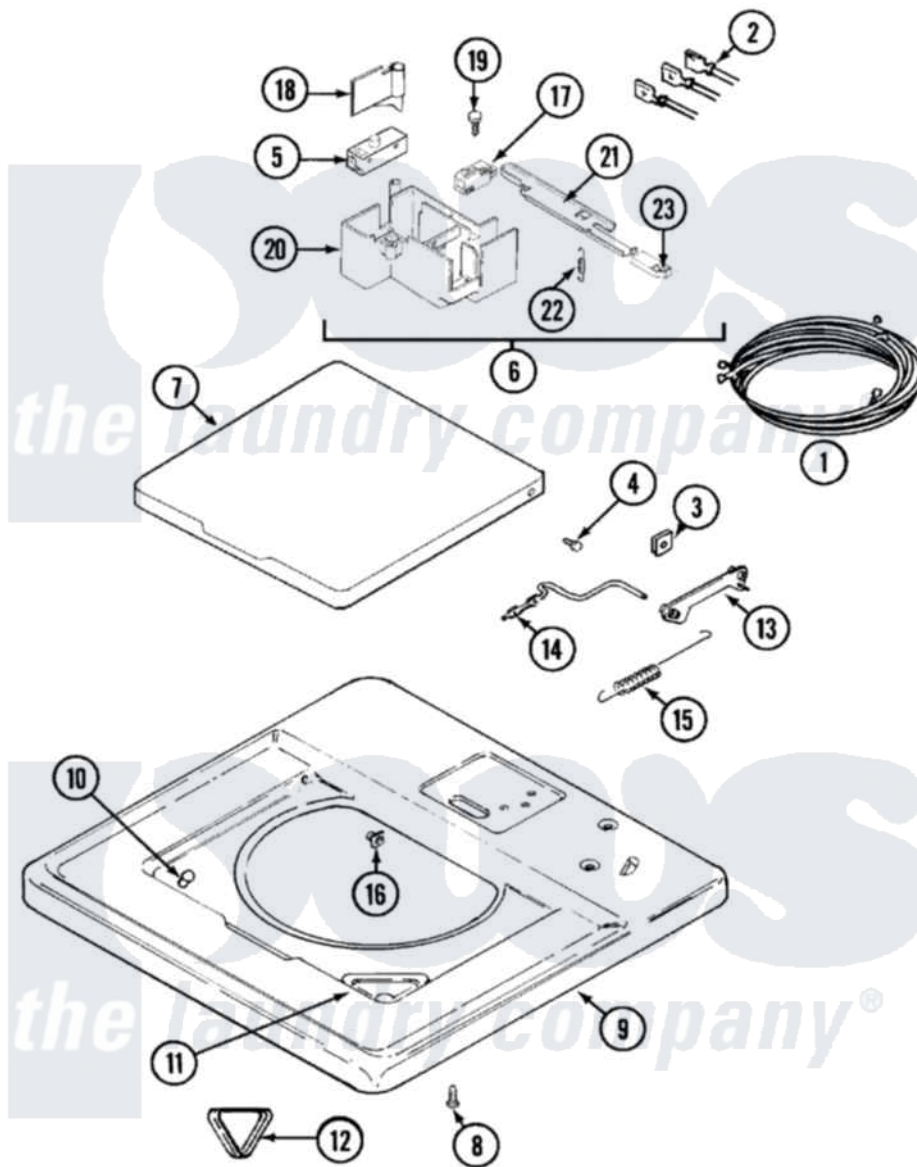

Maytag [Residential Maytag LSE7804ACM Stacked Washer and Dryer Parts](#) Parts Diagram 10 - TOP & LID (LSE7804ACM & ADM)

[Click on the part number to view part](#)

Item	Original Part Number	Replaced By	Status	Part Description
1	<a href="#">22001432</a>			Wire Harness
"	22001427		Not Available	WIRE HARNESS (UPR) NA
"	<a href="#">22001585</a>			Harness, Wire
2	<a href="#">22001443</a>			Harness, Wire
"	<a href="#">208781</a>			Wire Harness, Lid Switch
3	<a href="#">22001194</a>			Clip, Spring
4	<a href="#">22001001</a>			Screw
5	<a href="#">208823</a>			Pc Switch, Lid
6	22001581	<a href="#">12001514</a>		Switch-Lid
"	22001444	<a href="#">12001513</a>		Switch-Lid
7	22001081		Not Available	LID (ALM)---NA
8	<a href="#">214354</a>			Screw, Top Cover To Cabnt.
9	22001063	<a href="#">22002646</a>		Cover, Top
10	<a href="#">212716</a>			Bumper, Lid
11	<a href="#">215580</a>			Cup, Bleach
12	215374		Not Available	GASKET FOR BLEACH CUP

13	<a href="#">22001189</a>	Rod, Restraint
14	<a href="#">22001208</a>	Rod, Counter Balance
15	<a href="#">Y216184</a>	Spring, Counter Balance
16	<a href="#">22001193</a>	Bearing, Counter Balance
17	<a href="#">207166</a>	Switch, Check
18	<a href="#">22001283</a>	Trigger
19	<a href="#">215537</a>	Screw
"	<a href="#">22001183</a>	Screw
20	<a href="#">22001285</a>	Holder, Switch
21	<a href="#">22001286</a>	Switch, Arm
22	<a href="#">22001287</a>	Spring, Switch
23	<a href="#">22001250</a>	Glide, Switch Arm

*the laundry company*<sup>®</sup>

*the laundry company*<sup>®</sup>

*the laundry company*<sup>®</sup>