

Maytag LSE9900 07 - MOTOR, BLOWER, THERMOSTATS & LINT SCREEN

SECTION: MOTOR, BLOWER, THERMOSTATS & LINT SCREEN
 MODEL: SE-S69900

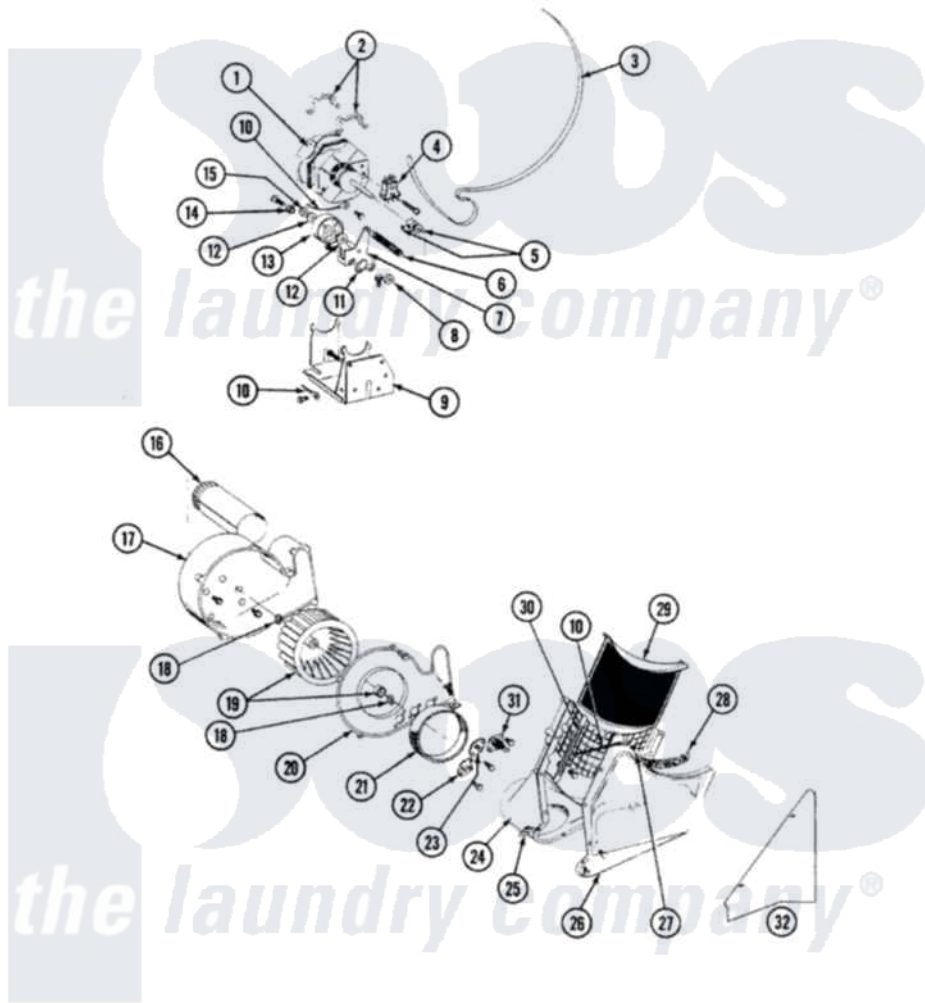

Issue Date: 8/90

14

Maytag [Residential Maytag LSE9900 Stacked Washer and Dryer Parts](#) Parts Diagram 07 - MOTOR, BLOWER, THERMOSTATS & LINT SCREEN
 Click on the part number to view part

| Item | Original Part Number | Replaced By | Status | Part Description |
|------|-------------------------|---------------------------|---------------|---|
| 1 | 306055 | W10411000 | | Motor-Drve |
| " | 910343 | 488234 | | Screw 8-32 X 1/4 |
| 2 | Y015825 | | | Clip, Motor To Motor Support |
| 3 | 314774 | Y312959 | | Poly "V" Belt For Tumbler |
| 4 | Y303877 | | Not Available | SWITCH, MOTOR EXTERNAL START No.303358-2, No.303358-4, 303358-7 |
| " | 306207 | | Not Available | (PROD. No.303358-8 & No.303358-9) |
| 5 | 306099 | | | Motor Pulley With Set Screw |
| " | Y053241 | | | Set Screw, Motor Pulley |
| 6 | 314473 | | | Spring For Idler |
| 7 | Y303363 | 6-3033630 | | Idler Arm |
| " | Y310842 | 8182296 | | Screw, Agitator |
| 8 | 314457 | | | Spacer For Idler Arm |
| 9 | 306054 | | | Support, Motor |
| " | 211204 | 00767 | | Screw, 8A X 3/8 HeX Washer |

| | | | |
|----|-------------------------|---------------------------|---|
| | 211294 | 90767 | Head Tapping |
| " | Y313561 | | Screw---NA |
| 10 | 901220 | | Ground Wire |
| 11 | Y312057 | 910624 | Screw |
| " | 314456 | | Spacer |
| 12 | Y312527 | | Washer, Idler Shaft |
| 13 | Y303705 | 6-3037050 | Pulley- ID |
| 14 | Y312894 | 315772 | Sleeve, Idler Arm |
| 15 | 312958 | 354987 | Ring, Retaining |
| 16 | 306637 | | Exhaust Duct Assembly |
| 17 | Y312893 | | Housing, Blower |
| " | Y310632 | 1163839 | Screw |
| 18 | 410233 | 9703438 | Ring-Retr |
| 19 | 312967 | | Clamp, Blower Housing |
| " | Y303836 | | Blower Wheel Assembly And Clamp |
| 20 | 314778 | Not Available | COVER, BLOWER HOUSING |
| " | Y313561 | | Screw---NA |
| " | Y312961 | W10116751 | Screw |
| 21 | Y312901 | | Seal, Housing Cover |
| 22 | 314848 | W10116760 | Screw |
| " | 306604 | | Cut-Off, Thermal Part Not Used |
| 23 | 306056 | | Thermistor Temp. Control Part Not Used Mde/G26pc Only. |
| " | 211294 | 90767 | Screw, 8A X 3/8 HeX Washer Head Tapping |
| 24 | 314801 | | Outlet Duct And Grid |
| 25 | 315274 | 488660 | Nut, Speed |
| 26 | Y312961 | W10116751 | Screw |
| " | 314485 | | Outlet Duct And Grid |
| 27 | 310557 | | Washer |
| " | Y312961 | W10116751 | Screw |
| 28 | Y313796 | | Lint Seal |
| 29 | Y306666 | 33001003 | Screen, Lint |
| 30 | Y313795 | | Guide For Lint Screen |
| " | Y312961 | W10116751 | Screw |
| 31 | 211294 | 90767 | Screw, 8A X 3/8 HeX Washer Head Tapping |
| " | 306060 | Not Available | THERMOSTAT |
| 32 | 315239 | | Shield For Outlet Duct |
| " | Y312961 | W10116751 | Screw |