

Maytag LSG1000 01 - BASE, TUB BRACES, DAMPER ASSY. & TRANS.

SECTION: BASE, TUB BRACES, DAMPER ASSEMBLY & TRANSMISSION
 MODEL: SE-S61000

P/N 56287R1

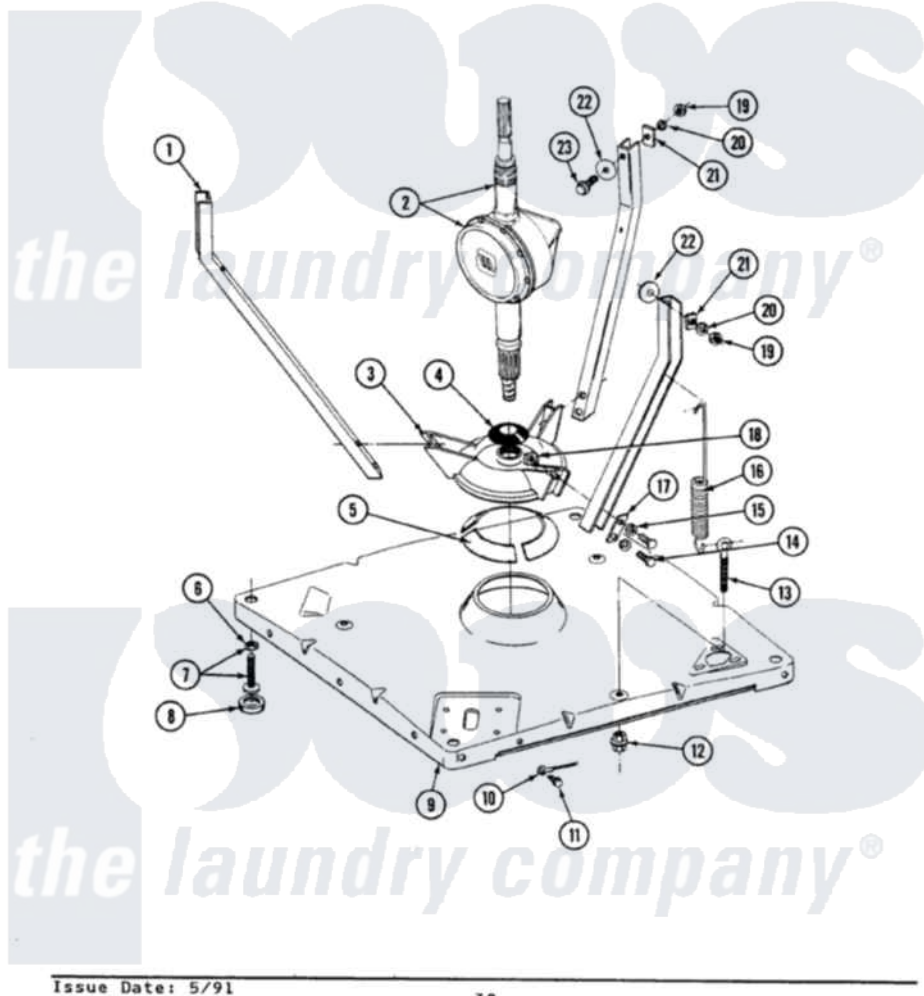

Issue Date: 5/91

38

Maytag Residential Maytag LSG1000 Stacked Washer and Dryer Parts Parts Diagram 01 - BASE, TUB BRACES, DAMPER ASSY. & TRANS.
 Click on the part number to view part

Item	Original Part Number	Replaced By	Status	Part Description
1	213053			Brace, Tub Part Not Used
2	207929		Not Available	TRANSMISSION KIT S1000
"	206707	6-2097750		Trans Dee
3	203725			Damper W/Bolt And Clip
4	211028	22001586		Deflector, Water
5	203956			Damper Pad Kit
6	210385			Lock Nut For Adjustable Leg
7	Y302699	22003428		Leg, Adjustable
8	210684			Foot, Adjustable Leg
9	203274			Base With Damper Pads
10	204807			Ground Wire, Supp. Plte To Top Cover
11	210186	3370225		Screw
12	211949			Nut, Adjustment Eyebolt
13	213120	216416		Bolt, Eye/Centering Spring
14	Y015627			Screw- Hex

15	911852	486009	Lockwasher
16	213054		Centering Spring - 3 Used
17	213073		Washer, Double Brace
18	Y052785		Nut, Brace To Damper
19	Y052734		Nut, Carrage Bolts And Bracket
20	Y054867		Washer, Lock
21	212979	Not Available	WASHER, TUB BRACE
22	211100		Washer, Outer Tub
23	200744	W10175939	Bolt
"	205254	W10175938	Bolt

