

Maytag LSG1000 02 - BLOWER HOUSING/THERMOSTATS & LINT SCREEN

SECTION: BLOWER HOUSING, THERMOSTATS & LINT SCREEN
 MODEL: SE-S61000

P/N 56287R1

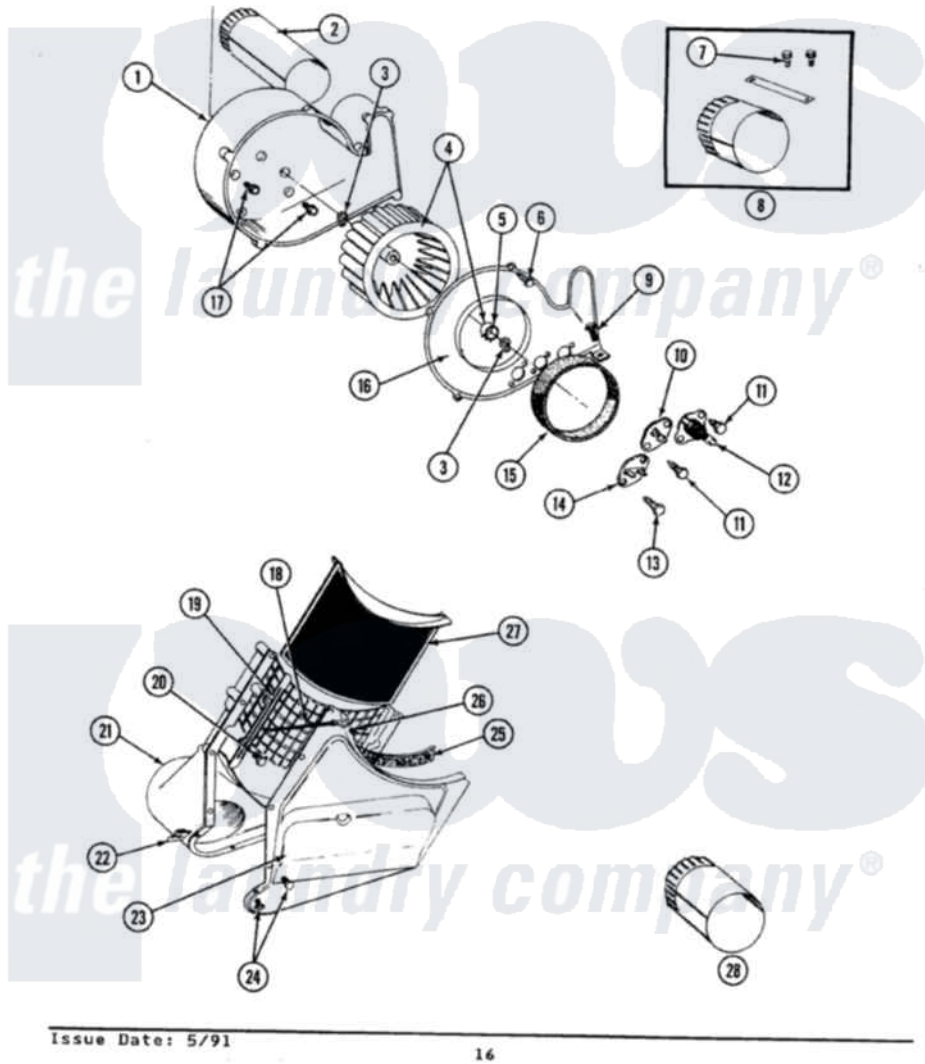

Issue Date: 5/91

16

Maytag [Residential Maytag LSG1000 Stacked Washer and Dryer Parts](#) Parts Diagram 02 - BLOWER HOUSING/THERMOSTATS & LINT SCREEN
 Click on the part number to view part

Item	Original Part Number	Replaced By	Status	Part Description
1	Y312893			Housing, Blower
2	306064		Not Available	EXHAUST DUCT
"	314716			Retainer Clip
3	410233	9703438		Ring-Retrnr
4	Y303836			Blower Wheel Assembly And Clamp
5	312967			Clamp, Blower Housing
6	Y312961	W10116751		Screw
7	Y310632	1163839		Screw
8	306643	8544761A		Exten-Exht
9	Y313561			Screw---NA
10	306056			Thermistor Temp. Control Part Not Used Mde/G26pc Only.
11	211294	90767		Screw, 8A X 3/8 HeX Washer Head Tapping
12	306060		Not Available	THERMOSTAT

13	314848	W10116760	Screw
14	306604		Cut-Off, Thermal Part Not Used
15	Y312901		Seal, Housing Cover
16	Y313770		COVER FOR BLOWER HOUSING
17	Y310632	1163839	Screw
18	901220		Ground Wire
19	Y313795		Guide For Lint Screen
20	Y312961	W10116751	Screw
21	306658	Not Available	OUTLET DUCT & GRID ASSY
"	314801		Outlet Duct And Grid
22	315274	488660	Nut, Speed
"	214894		Fastener, End Cap
23	314485		Outlet Duct And Grid
24	Y312961	W10116751	Screw
25	Y313796		Lint Seal
26	310557		Washer
"	Y312961	W10116751	Screw
27	Y306666	33001003	Screen, Lint
28	306637		Exhaust Duct Assembly

