

Maytag LSG1000 14 - MOTOR & IDLER ASSEMBLY

SECTION: MOTOR & IDLER ASSEMBLY
 MODEL: SE-SG1000

P/N 56287R1

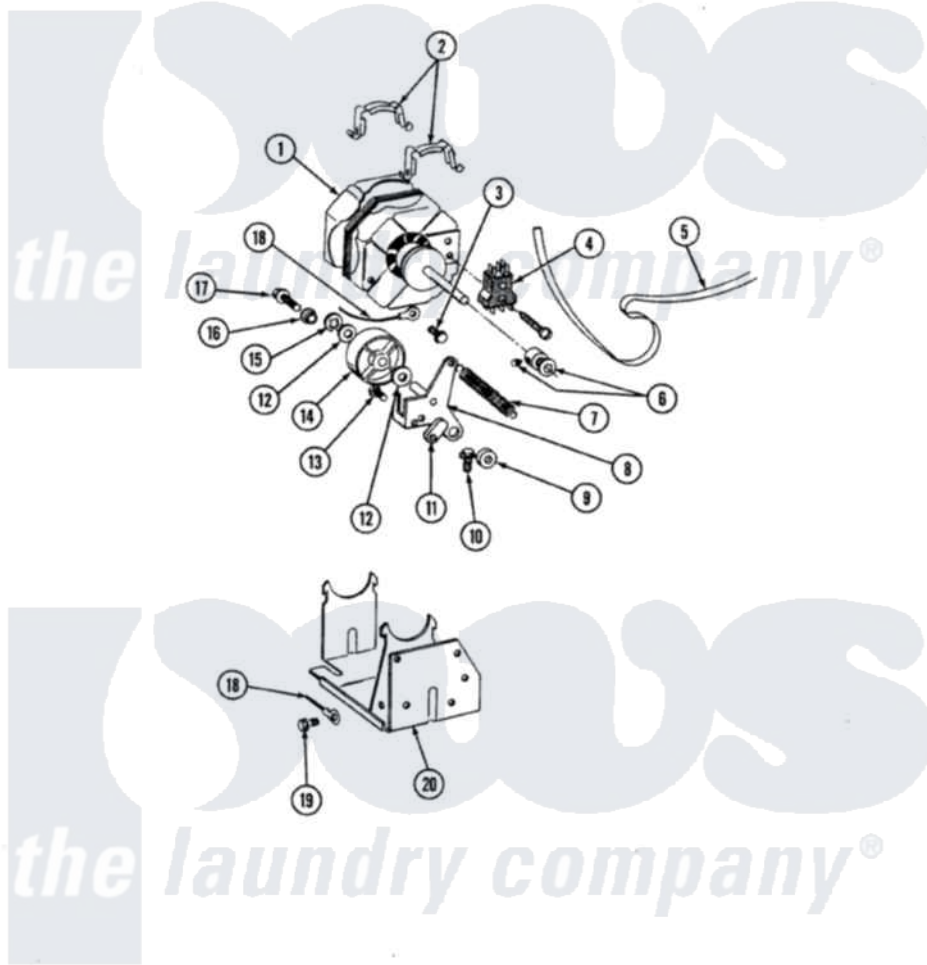

Issue Date: 5/91

14

Maytag [Residential Maytag LSG1000 Stacked Washer and Dryer Parts](#) Parts Diagram 14 - MOTOR & IDLER ASSEMBLY

[Click on the part number to view part](#)

| Item | Original Part Number | Replaced By | Status | Part Description |
|------|-------------------------|---------------------------|---------------|---|
| 1 | 306055 | W10411000 | | Motor-Drve |
| 2 | Y015825 | | | Clip, Motor To Motor Support |
| 3 | 211294 | 90767 | | Screw, 8A X 3/8 HeX Washer Head Tapping |
| 4 | Y303877 | | Not Available | SWITCH, MOTOR EXTERNAL START No.303358-2, No.303358-4, 303358-7 |
| " | 306207 | | Not Available | (PROD. No.303358-8 & No.303358-9) |
| 5 | 314774 | Y312959 | | Poly "V" Belt For Tumbler |
| 6 | Y053241 | | | Set Screw, Motor Pulley |
| " | 306099 | | | Motor Pulley With Set Screw |
| 7 | 314473 | | | Spring For Idler |
| 8 | Y303363 | 6-3033630 | | Idler Arm |
| 9 | 314457 | | | Spacer For Idler Arm |
| 10 | Y313561 | | | Screw---NA |
| 11 | 314456 | | | Spacer |

| | | | |
|----|-------------------------|---------------------------|--|
| 12 | Y312527 | | Washer, Idler Shaft |
| 13 | Y312057 | 910624 | Screw |
| 14 | Y303705 | 6-3037050 | Pulley- ID |
| 15 | 312958 | 354987 | Ring, Retaining |
| 16 | Y312894 | 315772 | Sleeve, Idler Arm |
| 17 | Y310842 | 8182296 | Screw, Agitator |
| 18 | 901220 | | Ground Wire |
| 19 | 211294 | 90767 | Screw, 8A X 3/8 HeX Washer Head Tapping |
| 20 | 306054 | | Support, Motor |

