

# Maytag LSG7800ABW 10 - GAS VALVE (LSG7800ABx)

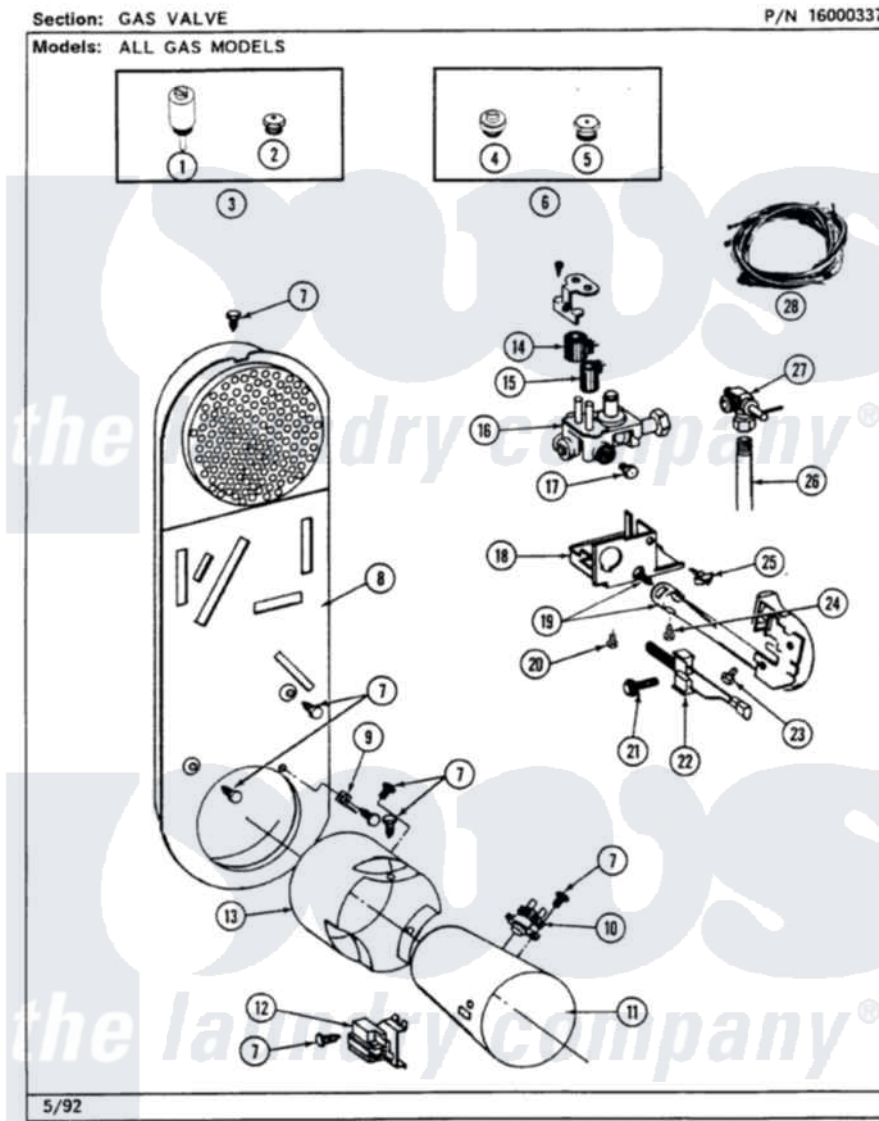

20

Maytag Residential Maytag LSG7800ABW Stacked Washer and Dryer Parts Parts Diagram 10 - GAS VALVE (LSG7800ABx)

[Click on the part number to view part](#)

Item	Original Part Number	Replaced By	Status	Part Description
1	306184		Not Available	PLUG, BLOCKING (LPG REGULATOR)
2	311640		Not Available	ORIFICE FOR MAIN BURNER
3	<a href="#">306205</a>			Conversion Kit-Nat. To LPG
4	314602	<a href="#">694424</a>		Leak, Limiter
5	<a href="#">314603</a>			Main Burner Orifice-NAT
6	306206		Not Available	CONVERSION KIT-LPG TO NAT.
7	211294	<a href="#">90767</a>		Screw, 8A X 3/8 Hex Washer Head Tapping
8	<a href="#">Y303369</a>			Inlet Duct Assembly
9	<a href="#">Y312890</a>			Retainer, Heater Chamber
10	<a href="#">303395</a>			Thermostat, Hi-Limit
11	<a href="#">Y303368</a>			Cone, Combustion
12	Y303377	<a href="#">338906</a>		Radiant, Sensor
13	<a href="#">314509</a>			Combustion Cone Extension
14	<a href="#">306106</a>			Coil, Holding And Booster--W

15	306105	<a href="#">694540</a>	Coil, 60 Hz
16	<a href="#">306084</a>		Valve, Gas
17	<a href="#">314603</a>		Main Burner Orifice-NAT
"	311640	Not Available	ORIFICE FOR MAIN BURNER
"	<a href="#">311641</a>		Orifice For Main Burner
18	<a href="#">314508</a>		Bracket For Gas Valve
19	306162	Not Available	BURNER ASSEMBLY WITH SCREW
20	314568	<a href="#">Y313559</a>	Screw
21	<a href="#">304971</a>		Screw Note: Screw, Igniter
22	304970	<a href="#">4391996</a>	Ignitor
23	212276	<a href="#">W10116760</a>	Screw
24	314082	<a href="#">90767</a>	Screw, 8A X 3/8 HeX Washer Head Tapping
25	Y313262	<a href="#">W10116752</a>	Retainer-
26	310454	Not Available	MANIFOLD, 2 INCH
27	<a href="#">306086</a>		Angle Shut Off For Gas Valve
28	<a href="#">306090</a>		Wire Harness For Gas Valve

