

**MODELS A105-A283-A284**

**TRANSMISSION**  
PRIOR TO SERIES 10

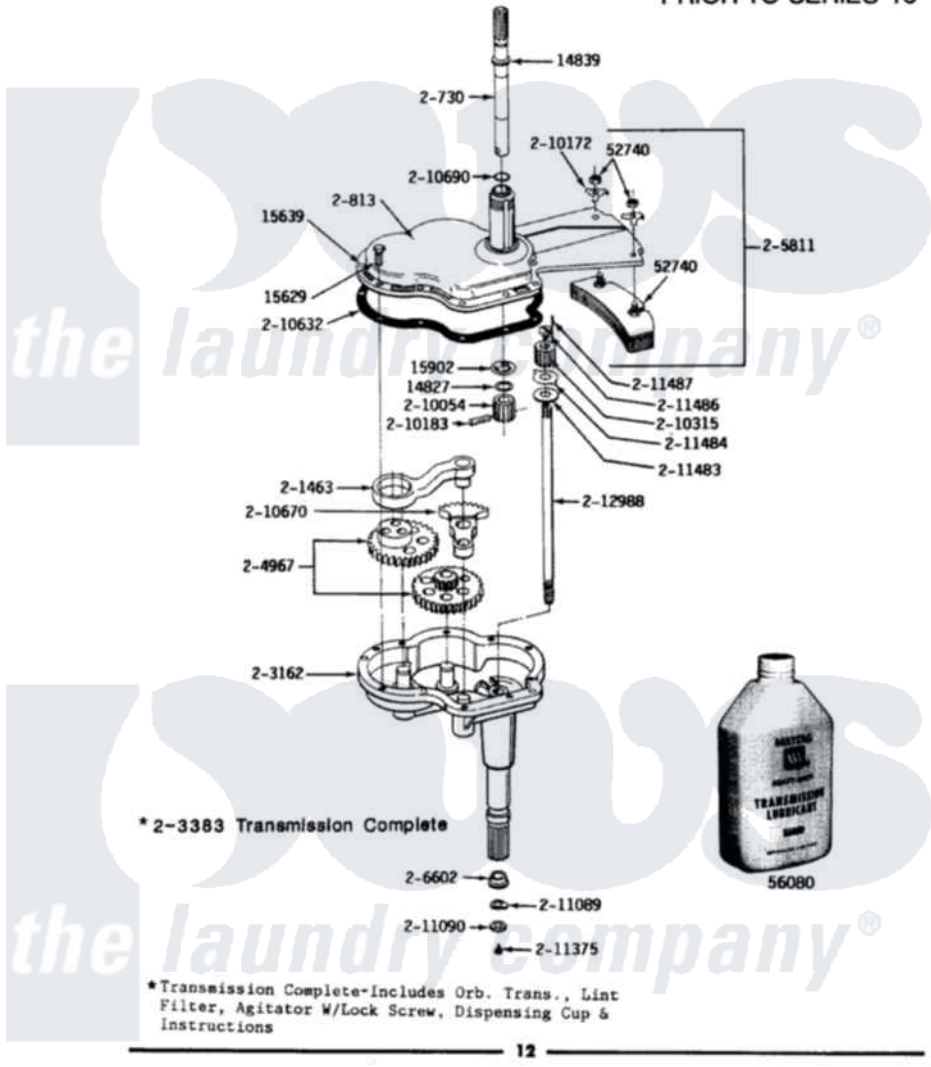

Maytag [Residential Maytag MA105 Washer Parts](#) Parts Diagram 08 - TRANSMISSION  
Click on the part number to view part

Item	Original Part Number	Replaced By	Status	Part Description
1	<a href="#">Y014827</a>			Washer-Center Shaft
2	<a href="#">Y014839</a>			Collar-Drive Shaft
3	<a href="#">Y015629</a>			Bolt, Grinding Chamber
4	<a href="#">Y015629</a>			Bolt, Grinding Chamber
5	<a href="#">015639</a>			Dowel Pin
6	<a href="#">Y015902</a>			Spring For Agitator
7	Y052740	<a href="#">62739</a>		Nut, Lock
8	Y056080	<a href="#">6-0560800</a>		Oil
9	200730	<a href="#">22002124</a>		Shaft- Agi
10	200813		Not Available	GEAR CASE COVER ASSEMBLY
11	201463		Not Available	PITMAN WITH WRIST PIN
12	<a href="#">203162</a>			Gear Housing W/Studs And Tube
13	203383	<a href="#">W10172458</a>		Transmison
14	<a href="#">204967</a>			Gear Kit-Power Fin Agitator
15	<a href="#">205811</a>			Counterweight

16	206602	<a href="#">207843</a>	Lip Seal Repair Kit
17	<a href="#">210054</a>		Pinion
18	<a href="#">210172</a>		Lock Washer
19	<a href="#">210183</a>		Groove Pin
20	<a href="#">210286</a>		Seal
21	<a href="#">210315</a>		Pinion
22	210632	<a href="#">22210632</a>	Gasket
23	<a href="#">210670</a>		Segment
24	<a href="#">210690</a>		Seal, Rubber
25	<a href="#">211089</a>		Lug, Stop Pulley
26	211090	<a href="#">22003555</a>	Washer, Stop Lug
27	211375	<a href="#">681582</a>	Screw
28	211483	<a href="#">6-2114830</a>	Washer- SP
29	<a href="#">211484</a>		Washer, Lug
30	<a href="#">211486</a>		Screw, 3/8-16 X 1/2 Inch
31	<a href="#">211487</a>		Groov-Pin
32	<a href="#">212988</a>		Part Not Used

