

Maytag MAT12PSDAW 01 - CONTROL PANEL

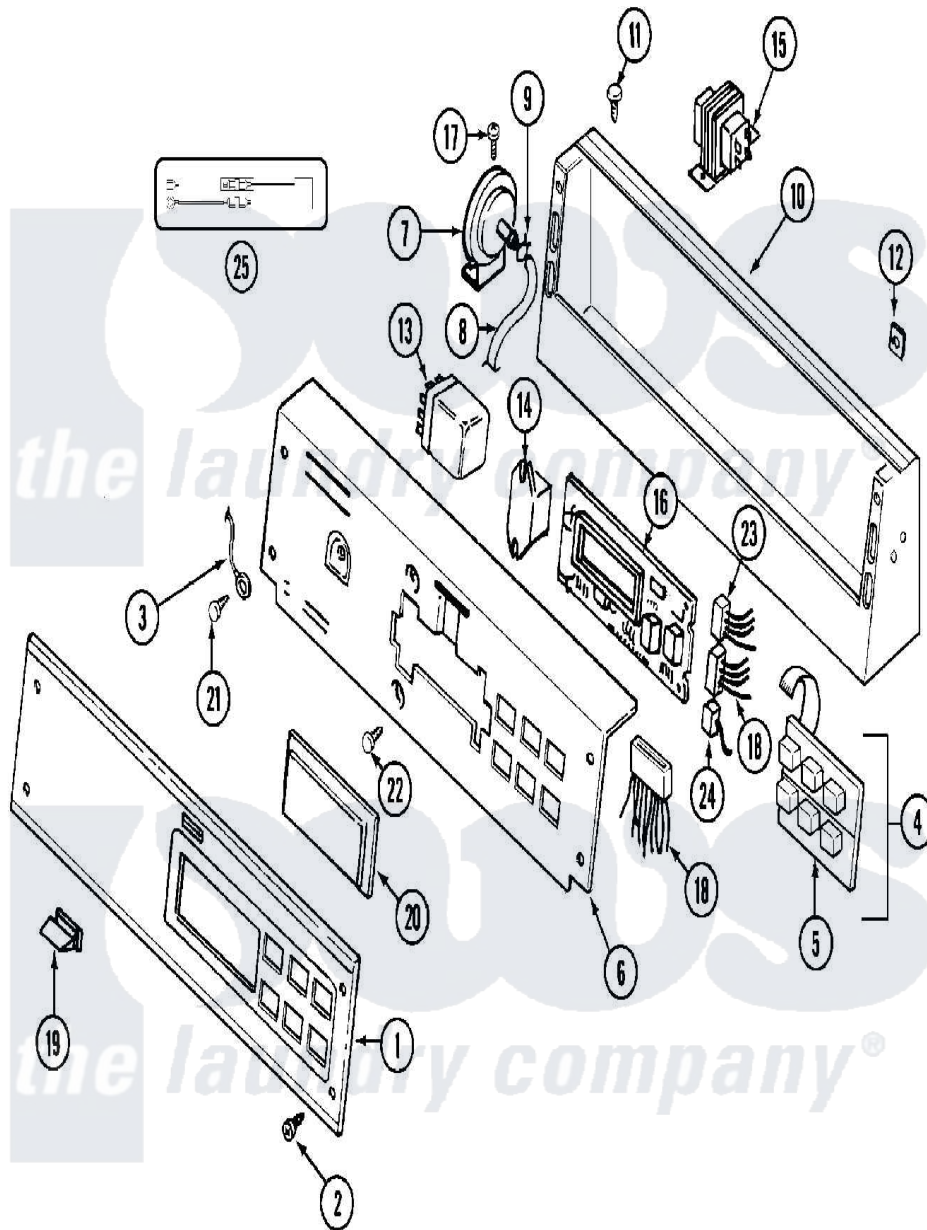

Maytag [Residential Maytag MAT12PSDAW Washer Parts](#) Parts Diagram 01 - CONTROL PANEL
 Click on the part number to view part

| Item | Original Part Number | Replaced By | Status | Part Description |
|------|--------------------------|---------------------------|--------|---------------------------------|
| 001 | 22004305 | | | Facia, Pd/Ps |
| 002 | 215506 | | | Screw, Control Panel Overlay |
| 003 | 22001959 | | | Wire, Ground |
| 004 | 206808 | W10135389 | | Push Button And Switch Assembly |
| " | 215527 | W10140652 | | Screw, 6-20 X 1/2 |
| 005 | 33002863 | W10131113 | | Push Button |
| 006 | 22003099 | | | Bracket, Back |
| 007 | 22001308 | | | Switch, Water Level |
| 008 | 22001619 | | | Tube, Water Level Switch |
| 009 | 410296 | 596669 | | Clamp, Manifold |
| 010 | 22003091 | | | Console |
| 011 | 212276 | W10116760 | | Screw |
| 012 | 215003 | | | Fastener, Panel And Bracket |
| 013 | 206421 | | | Relay, Motor Reversing |
| 014 | 22001866 | | | Screw, Relay |
| " | 22004151 | W10133335 | | Relay, Motor |

| | | | |
|-----|--------------------------|---------------------------|-------------------------------|
| 015 | 22001960 | | Transformer |
| " | Y313588 | 488234 | Screw 8-32 X 1/4 |
| 016 | 22002954 | | Deflector, Water |
| " | 22004222 | | Commercial D.C. Control Board |
| " | 33001204 | | Stand-Off, Ccontrol Board |
| " | 912077 | | Locknut, Reader Harness |
| 017 | 211168 | W10139210 | Screw, 8-18 X 5/16 |
| 018 | 22002986 | | Wire Harness, Main |
| " | 22004387 | | Harness, Main |
| 019 | 214610 | | Bumper, Lid |
| 020 | 22001962 | W10131114 | Cover, Display |
| 021 | 210186 | 3370225 | Screw |
| 022 | 215526 | | Screw, Circuit Board |
| 023 | 22001965 | | Optic Switch Assembly |
| 024 | 22001965 | | Optic Switch Assembly |
| 025 | NLA | Not Available | KIT, SURGE SUPPRESSOR |

